



MONTGOMERY COUNTY PLANNING DEPARTMENT
THE MARYLAND-NATIONAL CAPITAL PARK AND PLANNING COMMISSION

MCPB
Item # 1B
6-9-2016

MEMORANDUM

DATE: June 1, 2016

TO: Montgomery County Planning Board

VIA: Catherine Conlon, Supervisor
D.A.R.C. Division
(301) 495-4542

FROM: Stephen Smith, Senior Planner *SS*
Jay Beatty, Planner *JB*
D.A.R.C. Division
(301) 495-4522 & (301) 495-2178

SUBJECT: Informational Maps and Summary of Record Plats for the Planning Board
Agenda for June 9, 2016

The following record plats are recommended for APPROVAL, subject to the appropriate conditions of approval of the preliminary plan and site plan, if applicable, and conditioned on conformance with all requirements of Chapter 50 of the Montgomery County Code. Attached are specific recommendations and copies of plan drawings for the record plat. The following plats are included:

220160020 Ancient Oak West
220160060 White Oak – Third District Police Station

Plat Name: Ancient Oak West
Plat #: 220160020

Location: Located in the southwest quadrant of the intersection of Darnestown Road (MD 28) and Chestnut Oak Drive.

Master Plan: Potomac Subregion Master Plan

Plat Details: R-200 zone; 2 lots

Applicant: Jing Huang

The subdivision plat has been reviewed by M-NCPPC staff and determined to be in conformance with Preliminary Plan No. 120070480 (MCPB Resolution No. 13-140), as approved by the Board, and that any minor modifications reflected on the plat do not alter the intent of the Board's previous approval of the aforesaid plan.

REVISION OF LOT 1, BLOCK B
 RESUBDIVISION OF LOT 1, BLOCK B
 LOTS 25 AND 26 BLOCK B
 ANCIENT OAK WEST
 MONTGOMERY COUNTY, MARYLAND

P.G. ASSOCIATES INC.
 CIVIL ENGINEERS * SURVEYORS * LAND PLANNERS
 18220 FREDERICK ROAD, SUITE 300
 CALTHEESBURG, MARYLAND 20827
 PHONE (301) 208-0250 FAX (301) 208-1270

PRELIMINARY PLAN NO. 1-2007080
 REGISTERED PROFESSIONAL ENGINEER
 MONTGOMERY COUNTY, MARYLAND
 1/10/13
 125-1

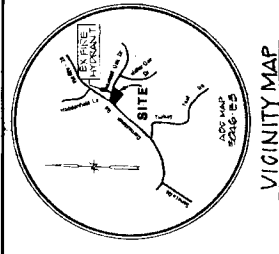

- GENERAL NOTES:**
1. THE PLANES WITHIN THE AUTOMATIC MAPPER PLAN ARE TO BE USED AS A GUIDE ONLY.
 2. THE AUTOMATIC MAPPER PLAN IS TO BE USED AS A GUIDE ONLY.
 3. THE AUTOMATIC MAPPER PLAN IS TO BE USED AS A GUIDE ONLY.
 4. THE AUTOMATIC MAPPER PLAN IS TO BE USED AS A GUIDE ONLY.
 5. THE AUTOMATIC MAPPER PLAN IS TO BE USED AS A GUIDE ONLY.
 6. THE AUTOMATIC MAPPER PLAN IS TO BE USED AS A GUIDE ONLY.
 7. THE AUTOMATIC MAPPER PLAN IS TO BE USED AS A GUIDE ONLY.
 8. THE AUTOMATIC MAPPER PLAN IS TO BE USED AS A GUIDE ONLY.
 9. THE AUTOMATIC MAPPER PLAN IS TO BE USED AS A GUIDE ONLY.
 10. THE AUTOMATIC MAPPER PLAN IS TO BE USED AS A GUIDE ONLY.

PLANNING BOARD NOTE

UNLESS SPECIFICALLY NOTED ON THIS PLAN DRAWING OR IN THE PLANNING BOARD'S CONDITIONS OF APPROVAL, THE BUILDING FOOTPRINTS, DRIVEWAYS, AND DRIVEWAYS SHOWN ON THE PRELIMINARY PLAN ARE ILLUSTRATIVE. THE FINAL LOCATIONS OF BUILDINGS, STRUCTURES AND LANDSCAPE STANDARDS SUCH AS SETBACKS, BUILDING RESTRICTION LINES, BUILDING HEIGHTS, AND OTHER LIMITATIONS FOR SITE DEVELOPMENT MAY ALSO BE INCLUDED IN THE CONDITIONS OF THE PLANNING BOARD'S APPROVAL.

DEVELOPMENT DATA

REQUIRED	PROPOSED	LOT 25	LOT 26	PROPOSED LOT 28
MINIMUM AREA (SQ. FT.)	20,000	47,000		65,000
MINIMUM LOT WIDTH AT BUILDING LINE	100'	217'		300'
MINIMUM SETBACK FROM STRUCTURES (1')	50'	50'		50'
MINIMUM SETBACK FROM ADJACENT PROPERTY	10'	91'		50'
MINIMUM SETBACK FROM ONE SIDE	10'	100'		50'
SUM OF SIDES (2')	30'	300'		300'
REAR				

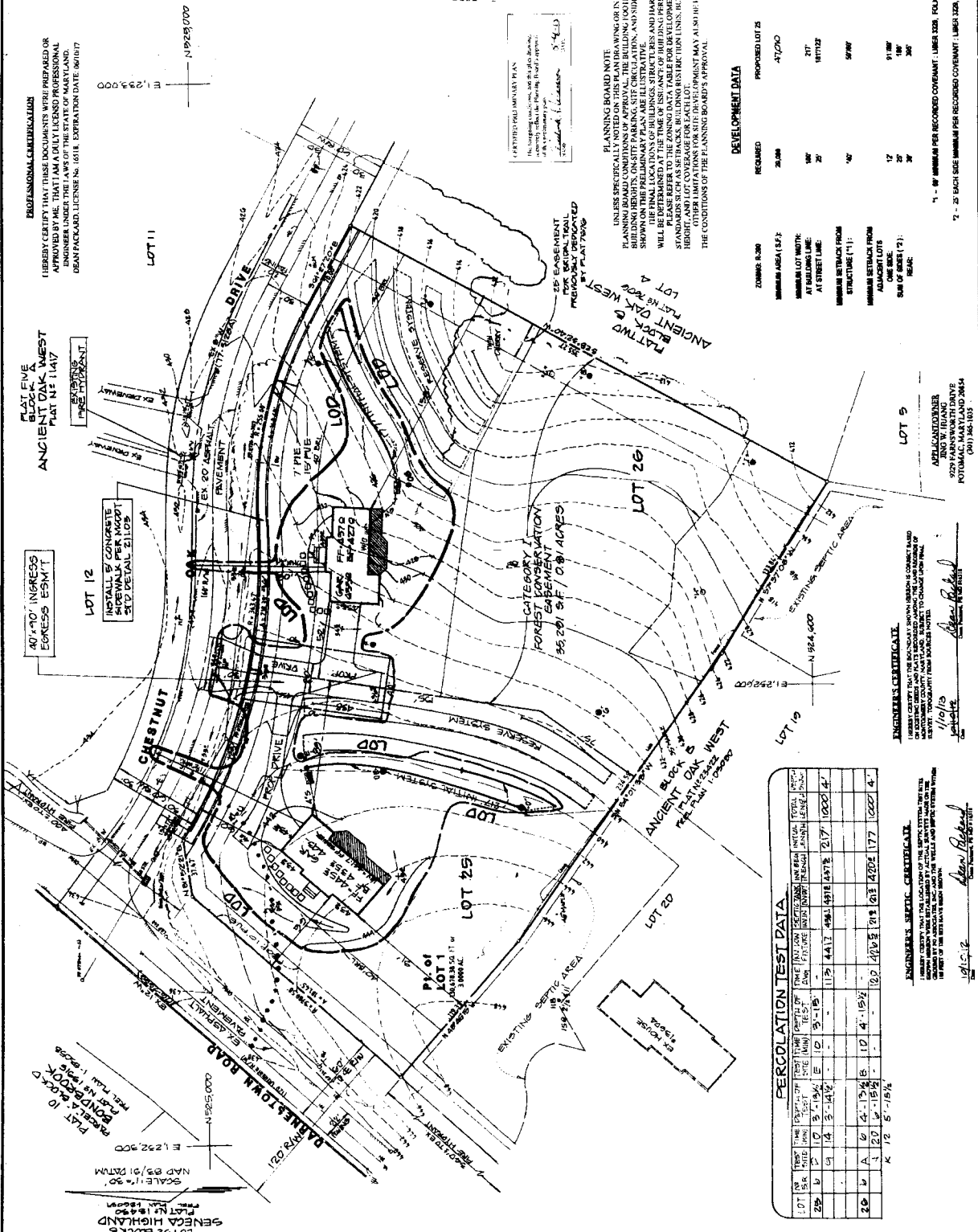

PLANNING BOARD NOTE

UNLESS SPECIFICALLY NOTED ON THIS PLAN DRAWING OR IN THE PLANNING BOARD'S CONDITIONS OF APPROVAL, THE BUILDING FOOTPRINTS, DRIVEWAYS, AND DRIVEWAYS SHOWN ON THE PRELIMINARY PLAN ARE ILLUSTRATIVE. THE FINAL LOCATIONS OF BUILDINGS, STRUCTURES AND LANDSCAPE STANDARDS SUCH AS SETBACKS, BUILDING RESTRICTION LINES, BUILDING HEIGHTS, AND OTHER LIMITATIONS FOR SITE DEVELOPMENT MAY ALSO BE INCLUDED IN THE CONDITIONS OF THE PLANNING BOARD'S APPROVAL.

DEVELOPMENT DATA

REQUIRED	PROPOSED	LOT 25	LOT 26	PROPOSED LOT 28
MINIMUM AREA (SQ. FT.)	20,000	47,000		65,000
MINIMUM LOT WIDTH AT BUILDING LINE	100'	217'		300'
MINIMUM SETBACK FROM STRUCTURES (1')	50'	50'		50'
MINIMUM SETBACK FROM ADJACENT PROPERTY	10'	91'		50'
MINIMUM SETBACK FROM ONE SIDE	10'	100'		50'
SUM OF SIDES (2')	30'	300'		300'
REAR				

PLANNING BOARD NOTE

UNLESS SPECIFICALLY NOTED ON THIS PLAN DRAWING OR IN THE PLANNING BOARD'S CONDITIONS OF APPROVAL, THE BUILDING FOOTPRINTS, DRIVEWAYS, AND DRIVEWAYS SHOWN ON THE PRELIMINARY PLAN ARE ILLUSTRATIVE. THE FINAL LOCATIONS OF BUILDINGS, STRUCTURES AND LANDSCAPE STANDARDS SUCH AS SETBACKS, BUILDING RESTRICTION LINES, BUILDING HEIGHTS, AND OTHER LIMITATIONS FOR SITE DEVELOPMENT MAY ALSO BE INCLUDED IN THE CONDITIONS OF THE PLANNING BOARD'S APPROVAL.

PERCOLATION TEST DATA

LOT NO.	TEST DATE	TEST TIME (HRS)	TEST TIME (MIN)	TEST TIME (SEC)	TEST TIME (MINS)	TEST TIME (SECS)	PERCENTAGE OF INFILTRATION
25	10/10/13	10	15	15	15	15	100
26	10/10/13	10	15	15	15	15	100

PROFESSIONAL CERTIFICATE
 I HEREBY CERTIFY THAT THESE DOCUMENTS WERE PREPARED OR APPROVED BY ME OR UNDER MY SUPERVISION AND I AM A REGISTERED PROFESSIONAL ENGINEER UNDER THE LAWS OF THE STATE OF MARYLAND.
 DEAN PACKARD, LICENSE NO. 16518, EXPIRATION DATE: 06/01/17

ENGINEER'S CERTIFICATE

I HEREBY CERTIFY THAT THE PERCOLATION TESTS WERE CONDUCTED AND THE RESULTS WERE AS SHOWN ON THE PERCOLATION TEST DATA TABLE. THE TESTS WERE CONDUCTED IN ACCORDANCE WITH THE MONTGOMERY COUNTY DEPARTMENT OF PUBLIC WORKS, DIVISION OF WATER AND WASTE SERVICES, PERCOLATION TEST PROCEDURE.

1/10/13
 Dean Packard
 927 PAINWORTH DRIVE
 POTOMAC, MARYLAND 20854
 (301) 780-1005

ADDITIONAL NOTES

1. - 10' MINIMUM PER RECORD COVERMENT - LINES 1208, 1209, 1210, 1211, 1212, 1213, 1214, 1215, 1216, 1217, 1218, 1219, 1220, 1221, 1222, 1223, 1224, 1225, 1226, 1227, 1228, 1229, 1230, 1231, 1232, 1233, 1234, 1235, 1236, 1237, 1238, 1239, 1240, 1241, 1242, 1243, 1244, 1245, 1246, 1247, 1248, 1249, 1250, 1251, 1252, 1253, 1254, 1255, 1256, 1257, 1258, 1259, 1260, 1261, 1262, 1263, 1264, 1265, 1266, 1267, 1268, 1269, 1270, 1271, 1272, 1273, 1274, 1275, 1276, 1277, 1278, 1279, 1280, 1281, 1282, 1283, 1284, 1285, 1286, 1287, 1288, 1289, 1290, 1291, 1292, 1293, 1294, 1295, 1296, 1297, 1298, 1299, 1300, 1301, 1302, 1303, 1304, 1305, 1306, 1307, 1308, 1309, 1310, 1311, 1312, 1313, 1314, 1315, 1316, 1317, 1318, 1319, 1320, 1321, 1322, 1323, 1324, 1325, 1326, 1327, 1328, 1329, 1330, 1331, 1332, 1333, 1334, 1335, 1336, 1337, 1338, 1339, 1340, 1341, 1342, 1343, 1344, 1345, 1346, 1347, 1348, 1349, 1350, 1351, 1352, 1353, 1354, 1355, 1356, 1357, 1358, 1359, 1360, 1361, 1362, 1363, 1364, 1365, 1366, 1367, 1368, 1369, 1370, 1371, 1372, 1373, 1374, 1375, 1376, 1377, 1378, 1379, 1380, 1381, 1382, 1383, 1384, 1385, 1386, 1387, 1388, 1389, 1390, 1391, 1392, 1393, 1394, 1395, 1396, 1397, 1398, 1399, 1400, 1401, 1402, 1403, 1404, 1405, 1406, 1407, 1408, 1409, 1410, 1411, 1412, 1413, 1414, 1415, 1416, 1417, 1418, 1419, 1420, 1421, 1422, 1423, 1424, 1425, 1426, 1427, 1428, 1429, 1430, 1431, 1432, 1433, 1434, 1435, 1436, 1437, 1438, 1439, 1440, 1441, 1442, 1443, 1444, 1445, 1446, 1447, 1448, 1449, 1450, 1451, 1452, 1453, 1454, 1455, 1456, 1457, 1458, 1459, 1460, 1461, 1462, 1463, 1464, 1465, 1466, 1467, 1468, 1469, 1470, 1471, 1472, 1473, 1474, 1475, 1476, 1477, 1478, 1479, 1480, 1481, 1482, 1483, 1484, 1485, 1486, 1487, 1488, 1489, 1490, 1491, 1492, 1493, 1494, 1495, 1496, 1497, 1498, 1499, 1500, 1501, 1502, 1503, 1504, 1505, 1506, 1507, 1508, 1509, 1510, 1511, 1512, 1513, 1514, 1515, 1516, 1517, 1518, 1519, 1520, 1521, 1522, 1523, 1524, 1525, 1526, 1527, 1528, 1529, 1530, 1531, 1532, 1533, 1534, 1535, 1536, 1537, 1538, 1539, 1540, 1541, 1542, 1543, 1544, 1545, 1546, 1547, 1548, 1549, 1550, 1551, 1552, 1553, 1554, 1555, 1556, 1557, 1558, 1559, 1560, 1561, 1562, 1563, 1564, 1565, 1566, 1567, 1568, 1569, 1570, 1571, 1572, 1573, 1574, 1575, 1576, 1577, 1578, 1579, 1580, 1581, 1582, 1583, 1584, 1585, 1586, 1587, 1588, 1589, 1590, 1591, 1592, 1593, 1594, 1595, 1596, 1597, 1598, 1599, 1600, 1601, 1602, 1603, 1604, 1605, 1606, 1607, 1608, 1609, 1610, 1611, 1612, 1613, 1614, 1615, 1616, 1617, 1618, 1619, 1620, 1621, 1622, 1623, 1624, 1625, 1626, 1627, 1628, 1629, 1630, 1631, 1632, 1633, 1634, 1635, 1636, 1637, 1638, 1639, 1640, 1641, 1642, 1643, 1644, 1645, 1646, 1647, 1648, 1649, 1650, 1651, 1652, 1653, 1654, 1655, 1656, 1657, 1658, 1659, 1660, 1661, 1662, 1663, 1664, 1665, 1666, 1667, 1668, 1669, 1670, 1671, 1672, 1673, 1674, 1675, 1676, 1677, 1678, 1679, 1680, 1681, 1682, 1683, 1684, 1685, 1686, 1687, 1688, 1689, 1690, 1691, 1692, 1693, 1694, 1695, 1696, 1697, 1698, 1699, 1700, 1701, 1702, 1703, 1704, 1705, 1706, 1707, 1708, 1709, 1710, 1711, 1712, 1713, 1714, 1715, 1716, 1717, 1718, 1719, 1720, 1721, 1722, 1723, 1724, 1725, 1726, 1727, 1728, 1729, 1730, 1731, 1732, 1733, 1734, 1735, 1736, 1737, 1738, 1739, 1740, 1741, 1742, 1743, 1744, 1745, 1746, 1747, 1748, 1749, 1750, 1751, 1752, 1753, 1754, 1755, 1756, 1757, 1758, 1759, 1760, 1761, 1762, 1763, 1764, 1765, 1766, 1767, 1768, 1769, 1770, 1771, 1772, 1773, 1774, 1775, 1776, 1777, 1778, 1779, 1780, 1781, 1782, 1783, 1784, 1785, 1786, 1787, 1788, 1789, 1790, 1791, 1792, 1793, 1794, 1795, 1796, 1797, 1798, 1799, 1800, 1801, 1802, 1803, 1804, 1805, 1806, 1807, 1808, 1809, 1810, 1811, 1812, 1813, 1814, 1815, 1816, 1817, 1818, 1819, 1820, 1821, 1822, 1823, 1824, 1825, 1826, 1827, 1828, 1829, 1830, 1831, 1832, 1833, 1834, 1835, 1836, 1837, 1838, 1839, 1840, 1841, 1842, 1843, 1844, 1845, 1846, 1847, 1848, 1849, 1850, 1851, 1852, 1853, 1854, 1855, 1856, 1857, 1858, 1859, 1860, 1861, 1862, 1863, 1864, 1865, 1866, 1867, 1868, 1869, 1870, 1871, 1872, 1873, 1874, 1875, 1876, 1877, 1878, 1879, 1880, 1881, 1882, 1883, 1884, 1885, 1886, 1887, 1888, 1889, 1890, 1891, 1892, 1893, 1894, 1895, 1896, 1897, 1898, 1899, 1900, 1901, 1902, 1903, 1904, 1905, 1906, 1907, 1908, 1909, 1910, 1911, 1912, 1913, 1914, 1915, 1916, 1917, 1918, 1919, 1920, 1921, 1922, 1923, 1924, 1925, 1926, 1927, 1928, 1929, 1930, 1931, 1932, 1933, 1934, 1935, 1936, 1937, 1938, 1939, 1940, 1941, 1942, 1943, 1944, 1945, 1946, 1947, 1948, 1949, 1950, 1951, 1952, 1953, 1954, 1955, 1956, 1957, 1958, 1959, 1960, 1961, 1962, 1963, 1964, 1965, 1966, 1967, 1968, 1969, 1970, 1971, 1972, 1973, 1974, 1975, 1976, 1977, 1978, 1979, 1980, 1981, 1982, 1983, 1984, 1985, 1986, 1987, 1988, 1989, 1990, 1991, 1992, 1993, 1994, 1995, 1996, 1997, 1998, 1999, 2000.