

Item #10



THE MARYLAND-NATIONAL CAPITAL PARK AND PLANNING COMMISSION

M E M O R A N D U M

**DATE:** February 07, 2003  
**TO:** Montgomery County Planning Board  
**FROM:** A. Malcolm Shaneman  
Development Review Division  
(301) 495-4587  
**SUBJECT:** Informational Maps for Subdivision Items on the  
Planning Board's Agenda for February 13, 2003.

-----

Attached are copies of plan drawings for Items #07, #10, #13, #14. These subdivision items are scheduled for Planning Board consideration on February 13, 2003. The items are further identified as follows:

Agenda Item #07 - Preliminary Plan 1-03026  
Lockwood Property

Agenda Item #10 - Preliminary Plan 1-88216  
Hoyles Mill Village

Agenda Item #13 - Preliminary Plan 1-02056  
Burdoft Property

Agenda Item #14 - Preliminary Plan 1-03031  
Cabin John Park

Attachment

VICINITY MAP FOR  
**HOYLES MILL VILLAGE (1-88216)**



Map compiled on February 07, 2003 at 10:15 AM | Site located on base sheet no - 225NW14

**NOTICE**

The planimetric, property, and topographic information shown on this map is based on copyrighted Map Products from the Montgomery County Department of Park and Planning of the Maryland -National Capital Park and Planning Commission, and may not be copied or reproduced without written permission from M-NCPPC.

Property lines are compiled by adjusting the property lines to topography created from aerial photography and should not be interpreted as actual field surveys. Planimetric features were compiled from 1:14400 scale aerial photography using stereo photogrammetric methods.

This map is created from a variety of data sources, and may not reflect the most current conditions in any one location and may not be completely accurate or up to date. All map features are approximately within five feet of their true location. This map may not be the same as a map of the same area plotted at an earlier time as the data is continuously updated. Use of this map, other than for general planning purposes is not recommended. - Copyright 1998

Key Map



0 1400



1 : 16800

VICINITY MAP FOR  
**HOYLES MILL VILLAGE (1-88216)**

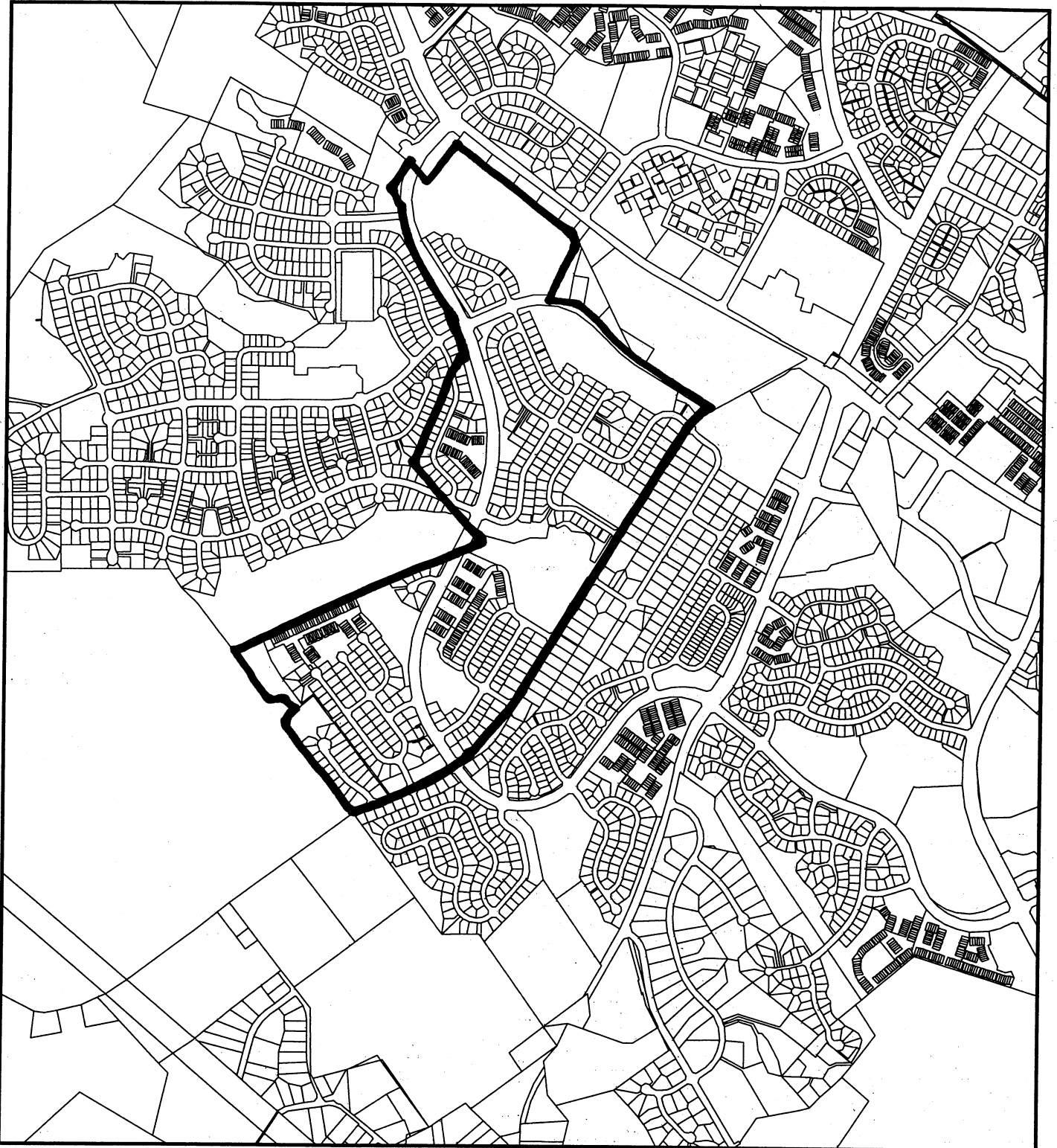

Map compiled on February 07, 2003 at 10:29 AM | Site located on base sheet no - 225NW14

**NOTICE**

The planimetric, property, and topographic information shown on this map is based on copyrighted Map Products from the Montgomery County Department of Park and Planning of the Maryland -National Capital Park and Planning Commission, and may not be copied or reproduced without written permission from M-NCPPC.

Property lines are compiled by adjusting the property lines to topography created from aerial photography and should not be interpreted as actual field surveys. Planimetric features were compiled from 1:14400 scale aerial photography using stereo photogrammetric methods.

This map is created from a variety of data sources, and may not reflect the most current conditions in any one location and may not be completely accurate or up to date. All map features are approximately within five feet of their true location. This map may not be the same as a map of the same area plotted at an earlier time as the data is continuously updated. Use of this map, other than for general planning purposes is not recommended. - Copyright 1998

Key Map

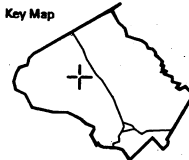

N



Research & Technology Center



1 : 16800

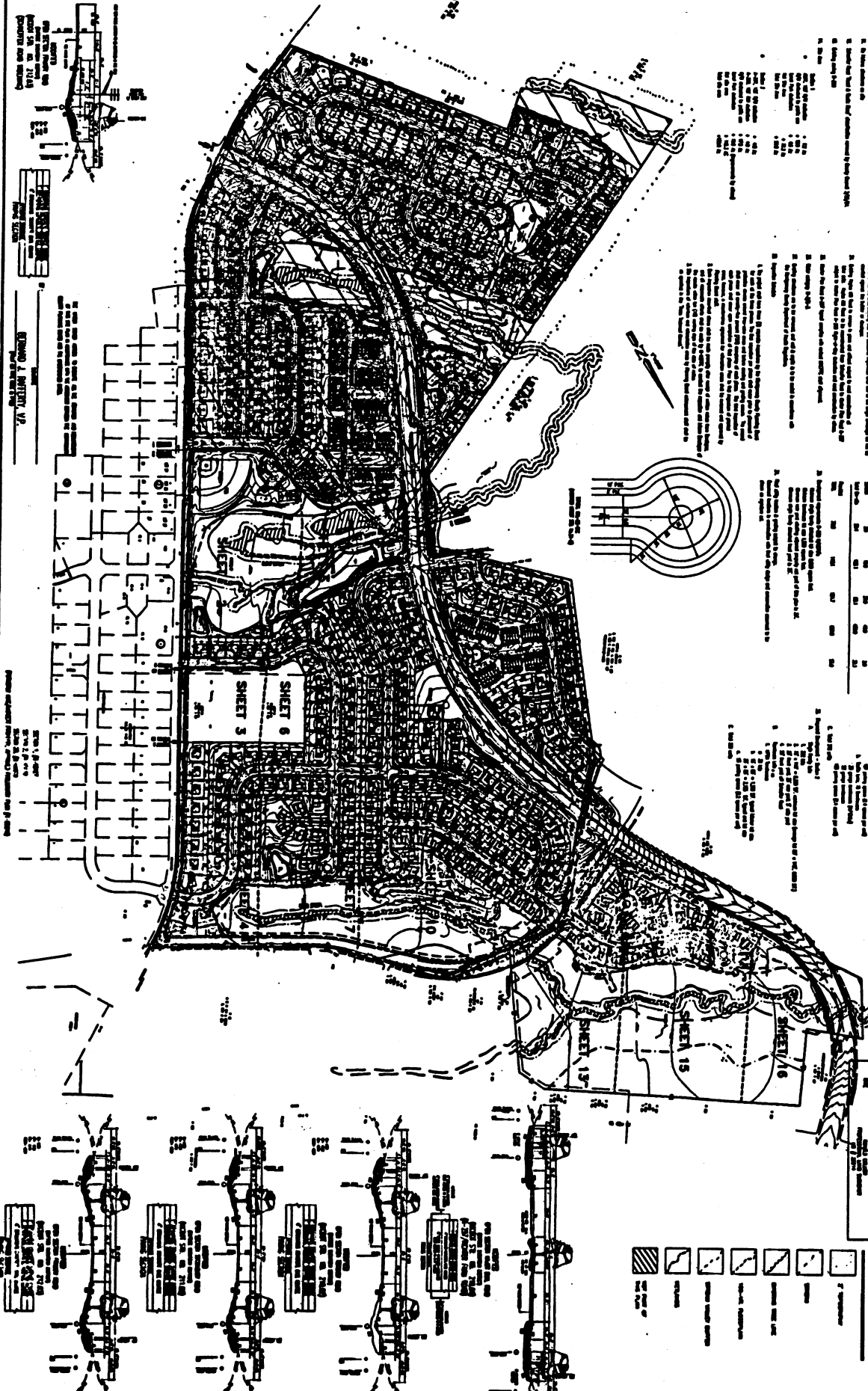

1. Property shown to be a portion of Sheet No. 100, 7-100-1000
2. Section 2, (1) of Hoyles Mill Village, Md.
3. The plan shows the proposed layout of streets, lots, and buildings.
4. The plan shows the proposed layout of streets, lots, and buildings.
5. The plan shows the proposed layout of streets, lots, and buildings.
6. The plan shows the proposed layout of streets, lots, and buildings.
7. The plan shows the proposed layout of streets, lots, and buildings.
8. The plan shows the proposed layout of streets, lots, and buildings.
9. The plan shows the proposed layout of streets, lots, and buildings.
10. The plan shows the proposed layout of streets, lots, and buildings.
11. The plan shows the proposed layout of streets, lots, and buildings.
12. The plan shows the proposed layout of streets, lots, and buildings.
13. The plan shows the proposed layout of streets, lots, and buildings.
14. The plan shows the proposed layout of streets, lots, and buildings.
15. The plan shows the proposed layout of streets, lots, and buildings.
16. The plan shows the proposed layout of streets, lots, and buildings.
17. The plan shows the proposed layout of streets, lots, and buildings.
18. The plan shows the proposed layout of streets, lots, and buildings.
19. The plan shows the proposed layout of streets, lots, and buildings.
20. The plan shows the proposed layout of streets, lots, and buildings.

Table with 10 columns and 10 rows, likely a schedule of materials or specifications.

Item	Quantity	Unit	Notes
1. Concrete	100	cu yd	
2. Steel	100	lb	
3. Brick	100	sq ft	
4. Lumber	100	cu ft	
5. Asphalt	100	sq ft	
6. Gravel	100	cu yd	
7. Sand	100	cu yd	
8. Cement	100	cu yd	
9. Paint	100	gal	
10. Other	100	sq ft	

1. The plan shows the proposed layout of streets, lots, and buildings.
2. The plan shows the proposed layout of streets, lots, and buildings.
3. The plan shows the proposed layout of streets, lots, and buildings.
4. The plan shows the proposed layout of streets, lots, and buildings.
5. The plan shows the proposed layout of streets, lots, and buildings.
6. The plan shows the proposed layout of streets, lots, and buildings.
7. The plan shows the proposed layout of streets, lots, and buildings.
8. The plan shows the proposed layout of streets, lots, and buildings.
9. The plan shows the proposed layout of streets, lots, and buildings.
10. The plan shows the proposed layout of streets, lots, and buildings.
11. The plan shows the proposed layout of streets, lots, and buildings.
12. The plan shows the proposed layout of streets, lots, and buildings.
13. The plan shows the proposed layout of streets, lots, and buildings.
14. The plan shows the proposed layout of streets, lots, and buildings.
15. The plan shows the proposed layout of streets, lots, and buildings.
16. The plan shows the proposed layout of streets, lots, and buildings.
17. The plan shows the proposed layout of streets, lots, and buildings.
18. The plan shows the proposed layout of streets, lots, and buildings.
19. The plan shows the proposed layout of streets, lots, and buildings.
20. The plan shows the proposed layout of streets, lots, and buildings.

**John**  
 Licensed Professional Engineer  
 No. 12345  
 State of Maryland  
 Mechanical Engineering

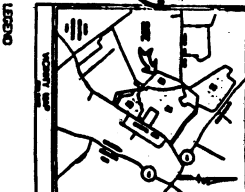

Sheet No.	Description
1	Overall Site Plan - Section 2
2	Sheet 3
3	Sheet 6
4	Sheet 15
5	Sheet 16

**OVERALL SITE PLAN-SECTION 2  
 HOYLES MILL VILLAGE  
 BARNESTOWN (9th) DISTRICT  
 MONTGOMERY COUNTY, MARYLAND**

**Charles F. Johnson & Associates, Inc.**  
 PLANNING - ENGINEERING - LANDSCAPE ARCHITECTURE - SURVEYING  
 1000 ...  
 ...