



THE MARYLAND-NATIONAL CAPITAL PARK AND PLANNING COMMISSION
Office of the Chairman, Montgomery County Planning Board

MEMORANDUM

Date: January 3, 2003
To: Carol Martin, Senior Planner, Environmental Planning
Via: John Carter, Chief, Community-Based Planning Division *KC*
Khalid Afzal, Team Leader, Georgia Avenue Team *KA* *LO*
From: Kristin O'Connor, Planner, Bethesda/North Bethesda Team
Subject: Staff Comments on Mandatory Referral No. 02003-WSSC-1; Rock
Creek Relief Sewer from Parklawn Cemetery Entrance to Mahan
Road; Rock Creek Stream Valley Park (SVP), Units 4, 5 and 6, and
including Winding Creek Local Park
Master Plan: 1992 North Bethesda-Garrett Park Master Plan; 1994 Aspen Hill
Master Plan; and 1989 Kensington-Wheaton Master Plan

The proposed project is located in three master plan areas: the 1992 North Bethesda-Garrett Park Master Plan; the 1994 Aspen Hill Master Plan; and the 1989 Master Plan for the Communities of Kensington and Wheaton. The 1992 North Bethesda-Garrett Park and the 1994 Aspen Hill Master Plans directly endorse the Washington Suburban Sanitary Commission (WSSC) facility improvements in the Rock Creek basin. Based on WSSC's *Rock Creek Transmission Relief Facility Plan*, the Aspen Hill Plan (1994) notes that the "Rock Creek trunk sewer will require about 10,000 feet of relief sewer between the storage facility and Veirs Mill Road." Each Plan comments that WSSC was preparing a facility plan to address the adequacy of the existing water distribution system to serve the area beyond the year 2000.

In 1999, WSSC drafted the *Rock Creek Wastewater Facility Plan*. This facility plan determined the need to provide relief to the sewer mains serving the Rock Creek basin. The Master Plans support any major improvements to the sewerage system in the basin area. The Aspen Hill Plan precisely acknowledges that:

"as the sewerage system ages, it is apparent that major improvements during the plan's life will increasingly be required. It is essential that long-range interagency planning occur to assure coordination of major infrastructure improvements to minimize overall public and private costs".

Based on the guidance in the relevant master plans, Community-Based Planning staff support the Rock Creek Relief Sewer project (Mandatory Referral No. 02003-WSSC-1).

E:\Staff Reports 2002\Rock Creek WSSC Sewer Project.doc

VICINITY MAP FOR
ROCK CREEK RELIEF SEWER



Map compiled on December 14, 2002 at 2:03 PM | Site located on base sheet no - 215NW04

NOTICE

The planimetric, property, and topographic information shown on this map is based on copyrighted Map Products from the Montgomery County Department of Park and Planning of the Maryland-National Capital Park and Planning Commission, and may not be copied or reproduced without written permission from M-NCPPC.

Property lines are compiled by adjusting the property lines to topography created from aerial photography and should not be interpreted as actual field surveys. Planimetric features were compiled from 1:14400 scale aerial photography using stereo photogrammetric methods.

This map is created from a variety of data sources, and may not reflect the most current conditions in any one location and may not be completely accurate or up to date. All map features are approximately within five feet of their true location. This map may not be the same as a map of the same area plotted at an earlier time as the data is continuously updated. Use of this map, other than for general planning purposes is not recommended. - Copyright 1998

Key Map

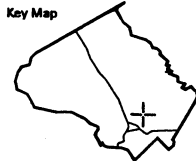

Research & Technology Center



1:12000

VICINITY MAP FOR

ROCK CREEK RELIEF SEWER

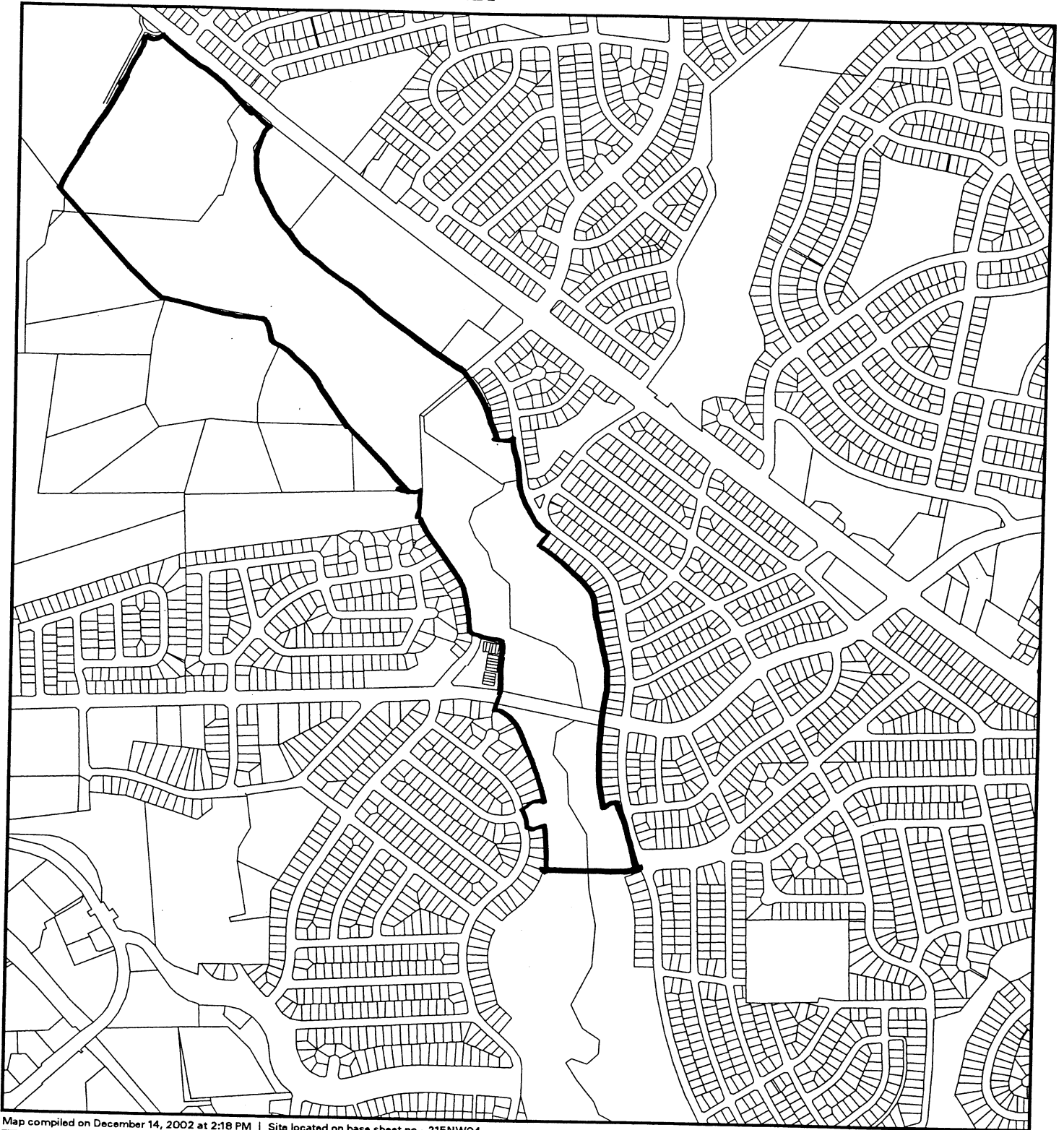

Map compiled on December 14, 2002 at 2:18 PM | Site located on base sheet no - 215NW04

NOTICE

The planimetric, property, and topographic information shown on this map is based on copyrighted Map Products from the Montgomery County Department of Park and Planning of the Maryland-National Capital Park and Planning Commission, and may not be copied or reproduced without written permission from M-NCPPC.

Property lines are compiled by adjusting the property lines to topography created from aerial photography and should not be interpreted as actual field surveys. Planimetric features were compiled from 1:14400 scale aerial photography using stereo photogrammetric methods.

This map is created from a variety of data sources, and may not reflect the most current conditions in any one location and may not be completely accurate or up to date. All map features are approximately within five feet of their true location. This map may not be the same as a map of the same area plotted at an earlier time as the data is continuously updated. Use of this map, other than for general planning purposes is not recommended. - Copyright 1998

Key Map

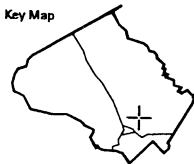

Research & Technology Center



1 : 12000

MONTGOMERY COUNTY DEPARTMENT OF PARK AND PLANNING
THE MARYLAND-NATIONAL CAPITAL PARK AND PLANNING COMMISSION

8787 Georgia Avenue - Silver Spring, Maryland 20910-3760

M-NCPPC

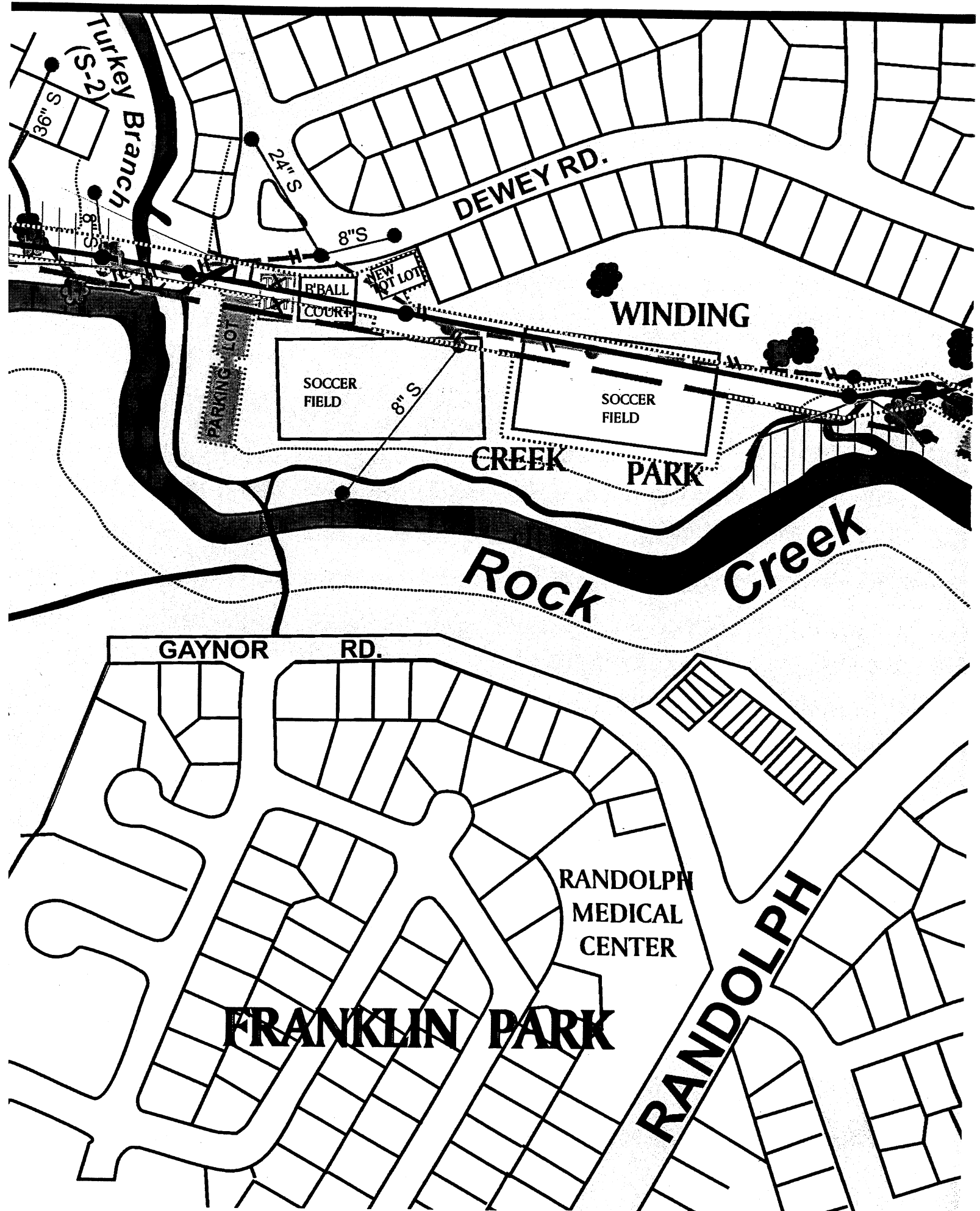

DEWEY RD.

WINDING

CREEK PARK

Rock

Creek

GAYNOR RD.

RANDOLPH
MEDICAL
CENTER

FRANKLIN PARK

RANDOLPH

24" S

8" S

8" S

S 1.98

(S-2)

Turkey Branch

B'BALL COURT

NEW LOT

SOCCER FIELD

SOCCER FIELD

PARKING LOT

CORELROCKCREEKLocMap

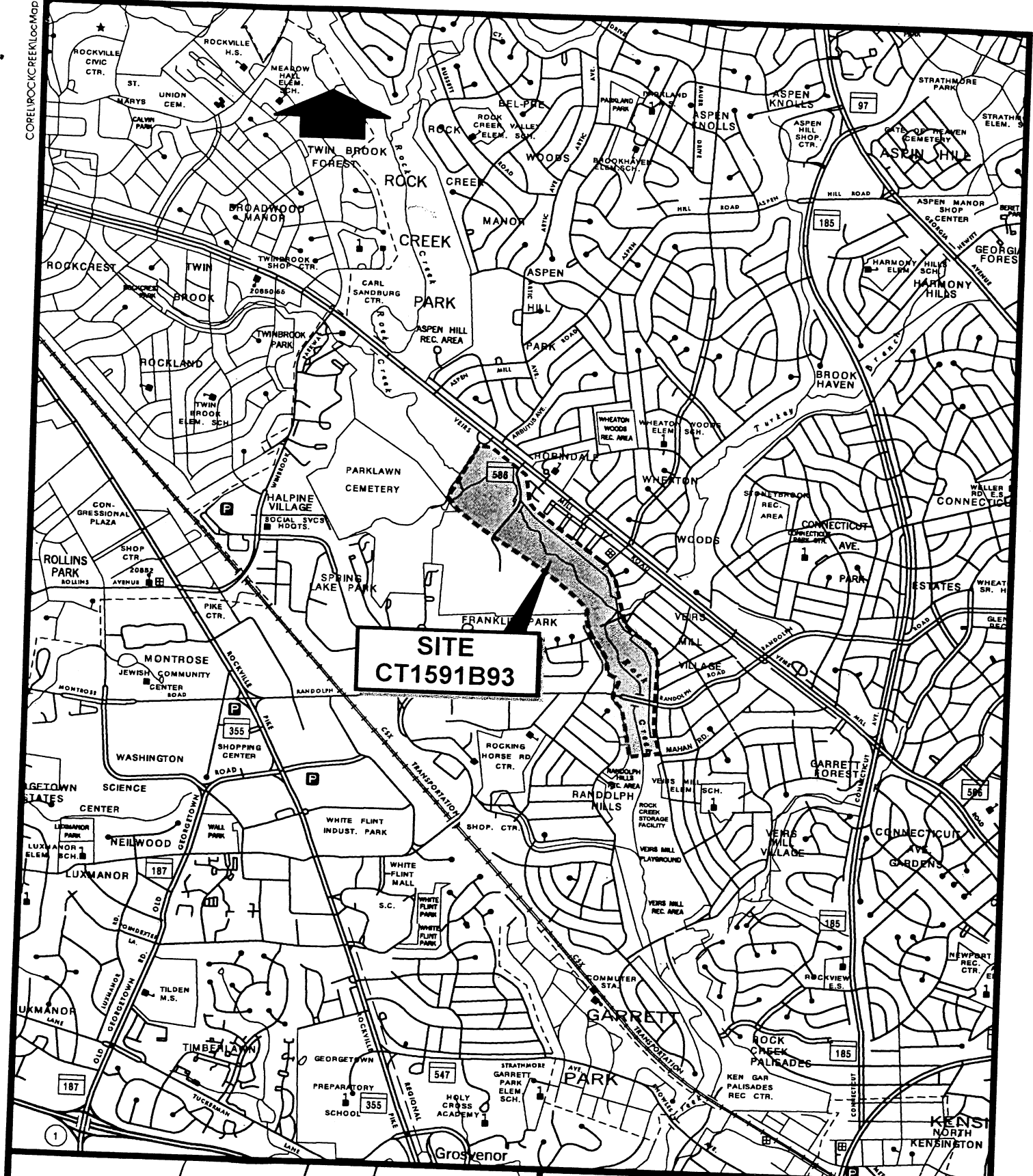

**SITE
CT1591B93**



KEY MAP

Rock Creek Relief/Replacement Sewer
 Contract No. CT1591B93
Design Criteria Report

LOCATION MAP

DATE	2500	0	2500	FIGURE
Dec., 2001	SCALE IN FEET			1