

TYPICAL SECTION - BRICK WALL
SCALE: 1/2" = 1'-0"

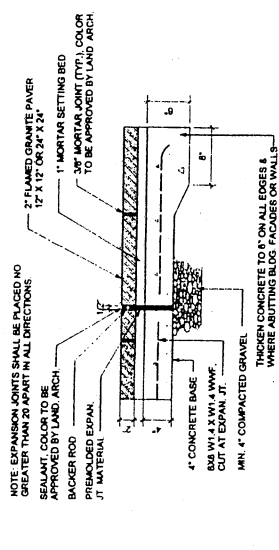

TYPICAL SECTION - GRANITE PAVING MORTARED-IN-PLACE
SCALE: 1/2" = 1'-0"

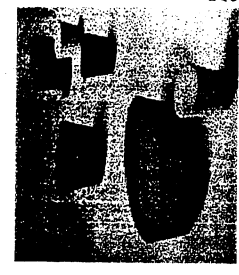

ELLIPTICAL BENCHES
NO SCALE

MULTICOLORED CERAMIC BENCHES AS MANUFACTURED BY KNOLL INC. OR EQUAL

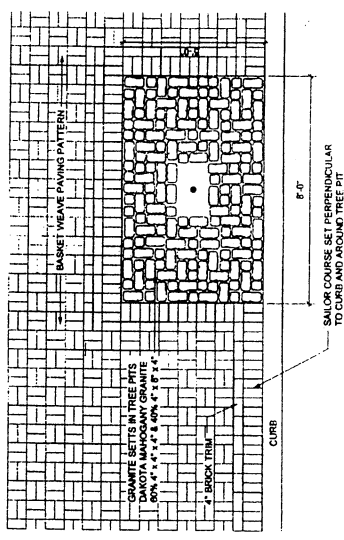

PAVING & TREE BOX ALONG BONIFANT STREET
SCALE: 1/2" = 1'-0"

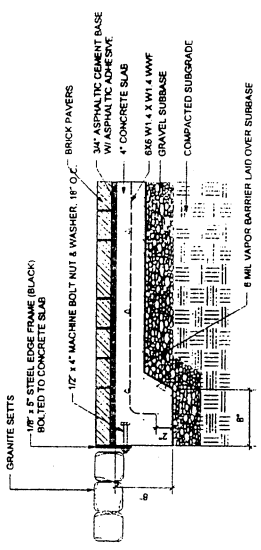

TYPICAL PAVING SECTION AT TREE PIT
SCALE: 1/2" = 1'-0"

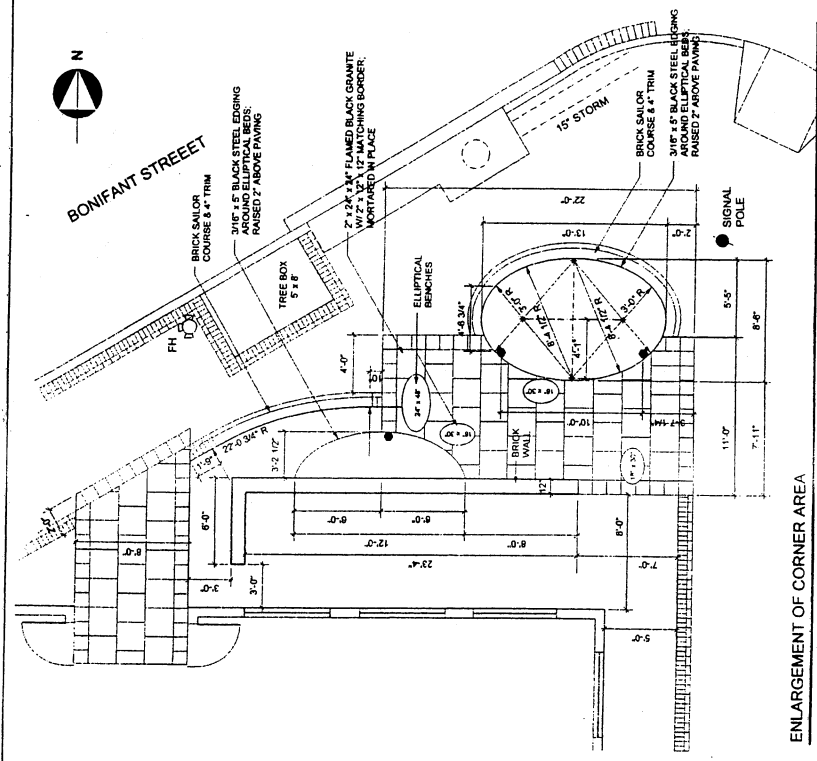

ENLARGEMENT OF CORNER AREA
SCALE: 1/8" = 1'-0"

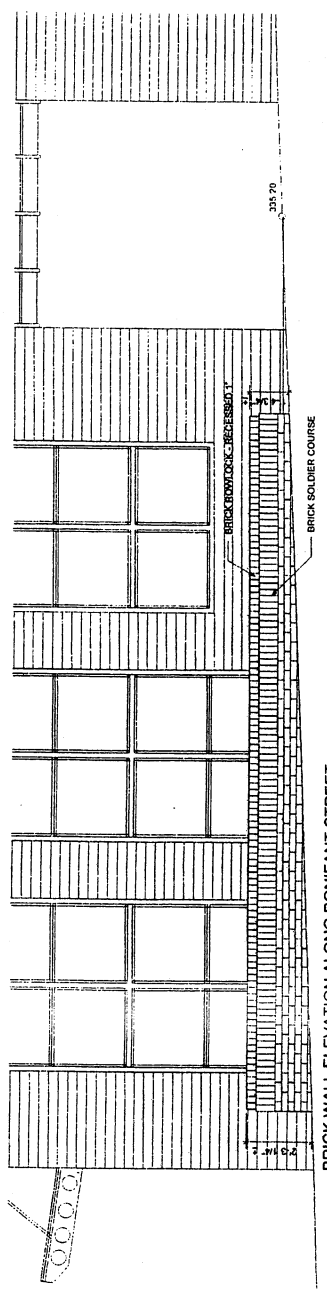

BRICK WALL ELEVATION ALONG BONIFANT STREET
SCALE: 1/2" = 1'-0"

| | | | | | | | | | |
|-----|-------------|------|------|----------------|--|---|---|---|---|
| NO. | DESCRIPTION | NAME | DATE | SCALE AS SHOWN | TRACE landscape architecture urban design planning | 2165 Wisconsin Avenue, NW Washington, DC 20007-2280 202.338.0027 FAX 202.333.4826 | LOFTS - 24 SILVER SPRING PARK | LANDSCAPE DETAILS LOTS 14 & 15, BLOCK O SILVER SPRING PARK MONTGOMERY COUNTY, MARYLAND | MAY 12, 2003 SHEET L-2 NO. 02-214 |
| | | | | | | | | | |

TYPE - D
WALL MOUNTED FACE PLATE



TYPE - D
WALL MOUNTED FACE PLATE

Surface mounted high performance fluorescent luminaires utilizing Ceramic Metal Halide lamps.

For more information, contact the manufacturer or Tezera llc.

DATE: 03/17/02

TYPE - C
WALL MOUNTED SINGLE BEAD

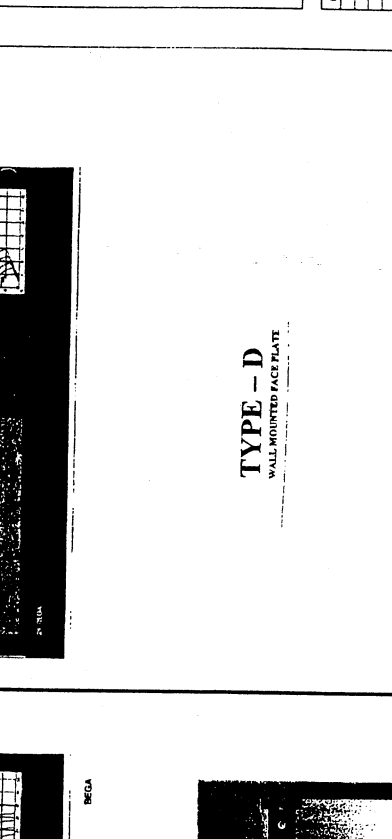

TYPE - C
WALL MOUNTED SINGLE BEAD

Surface mounted luminaire with ceramic metal halide lamp.

For more information, contact the manufacturer or Tezera llc.

DATE: 03/17/02

TYPE - A
DUAL BEAD

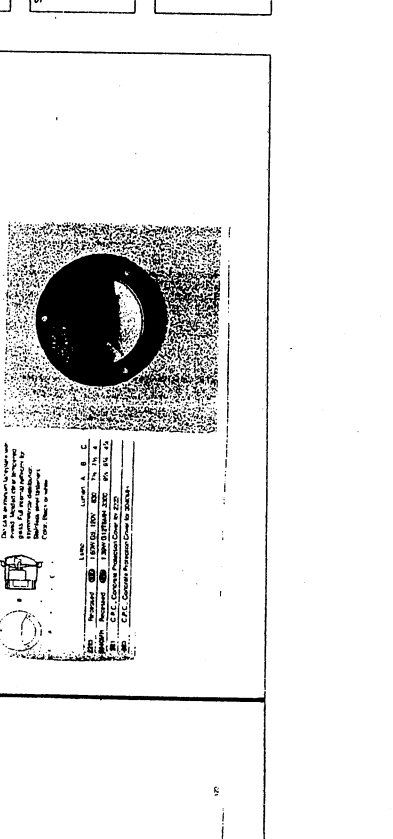

TYPE - A
DUAL BEAD

Surface mounted luminaire with ceramic metal halide lamps.

For more information, contact the manufacturer or Tezera llc.

DATE: 03/17/02

TYPE - D
WALL MOUNTED FACE PLATE

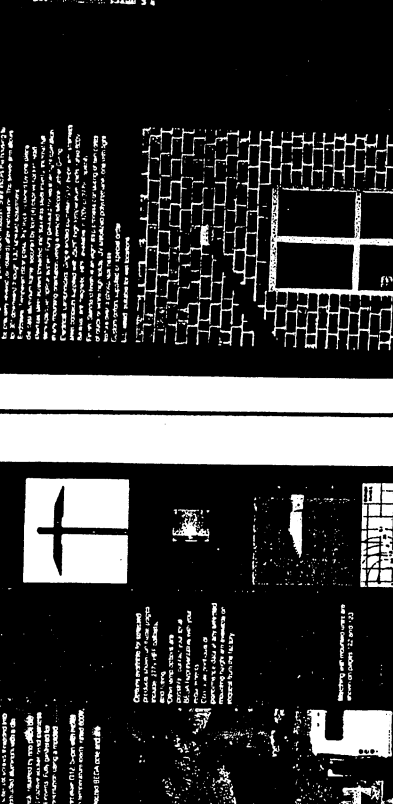

TYPE - D
WALL MOUNTED FACE PLATE

Surface mounted luminaire with ceramic metal halide lamp.

For more information, contact the manufacturer or Tezera llc.

DATE: 03/17/02

TYPE - C
WALL MOUNTED SINGLE BEAD

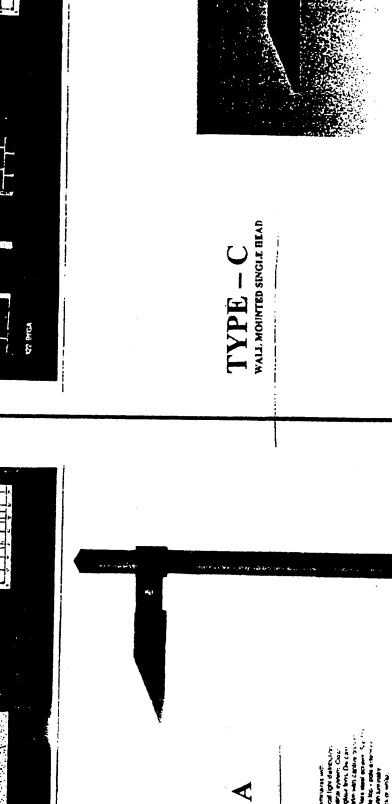

TYPE - C
WALL MOUNTED SINGLE BEAD

Surface mounted luminaire with ceramic metal halide lamp.

For more information, contact the manufacturer or Tezera llc.

DATE: 03/17/02

TYPE - A
DUAL BEAD

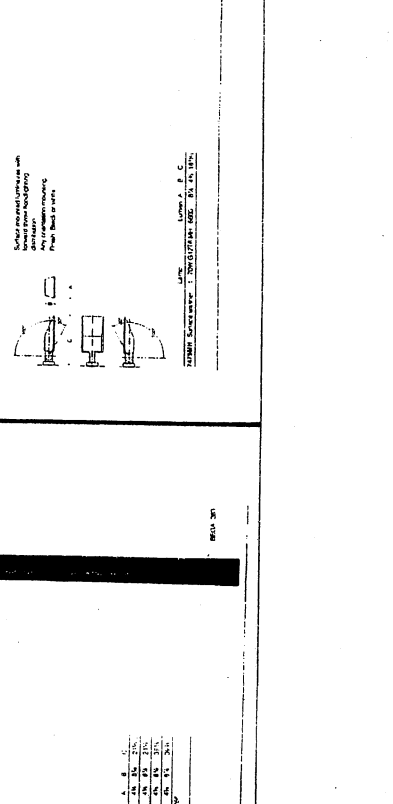

TYPE - A
DUAL BEAD

Surface mounted luminaire with ceramic metal halide lamps.

For more information, contact the manufacturer or Tezera llc.

DATE: 03/17/02

