

# BROADACRES L.P.

710 Beacon Road, Silver Spring

## Attachment 1 - Broadacres Local Park Site Maps

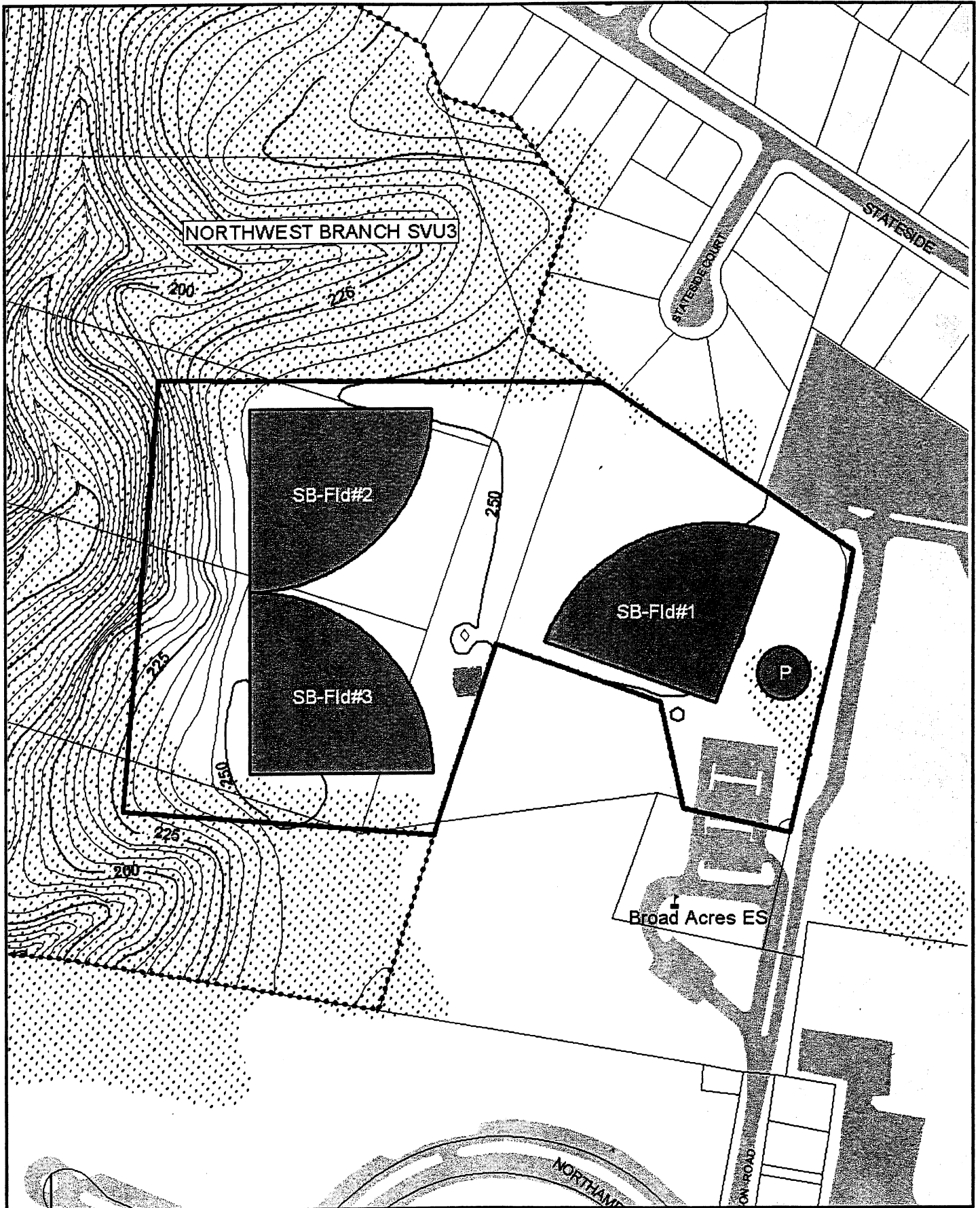

Acreage 10.8  
Facility Code D14

Region S  
Area ML

Date 6/7/2002



①

# Broadacres Local Park

NORTHWEST BRANCH SVU3

BROADACRES L.P.

STATESIDE

ELSON

1" = 200'

Aerial Photos Flown March 2002

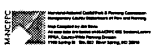

# Attachment 2- Broad Acres School Renovation Map

## BUILDING PLAN And ADJACENT PROPERTIES

### SIGN KEY NOTES

- ① PARENT DROP-OFF/FAULTY PARKING AREA
- ② BUSES ONLY

### LEGEND

- NEW BUILDING ADDITION
- NEW INTERIOR MODIFICATION
- EXISTING BUILDING
- PROPOSED LAND DEDICATION OR ACQUISITION
- TEMP. USE OF M-NCP&FC LAND DURING CONST. PHASE
- PROPERTY LINE
- PEDESTRIAN PATH
- TREE LINE

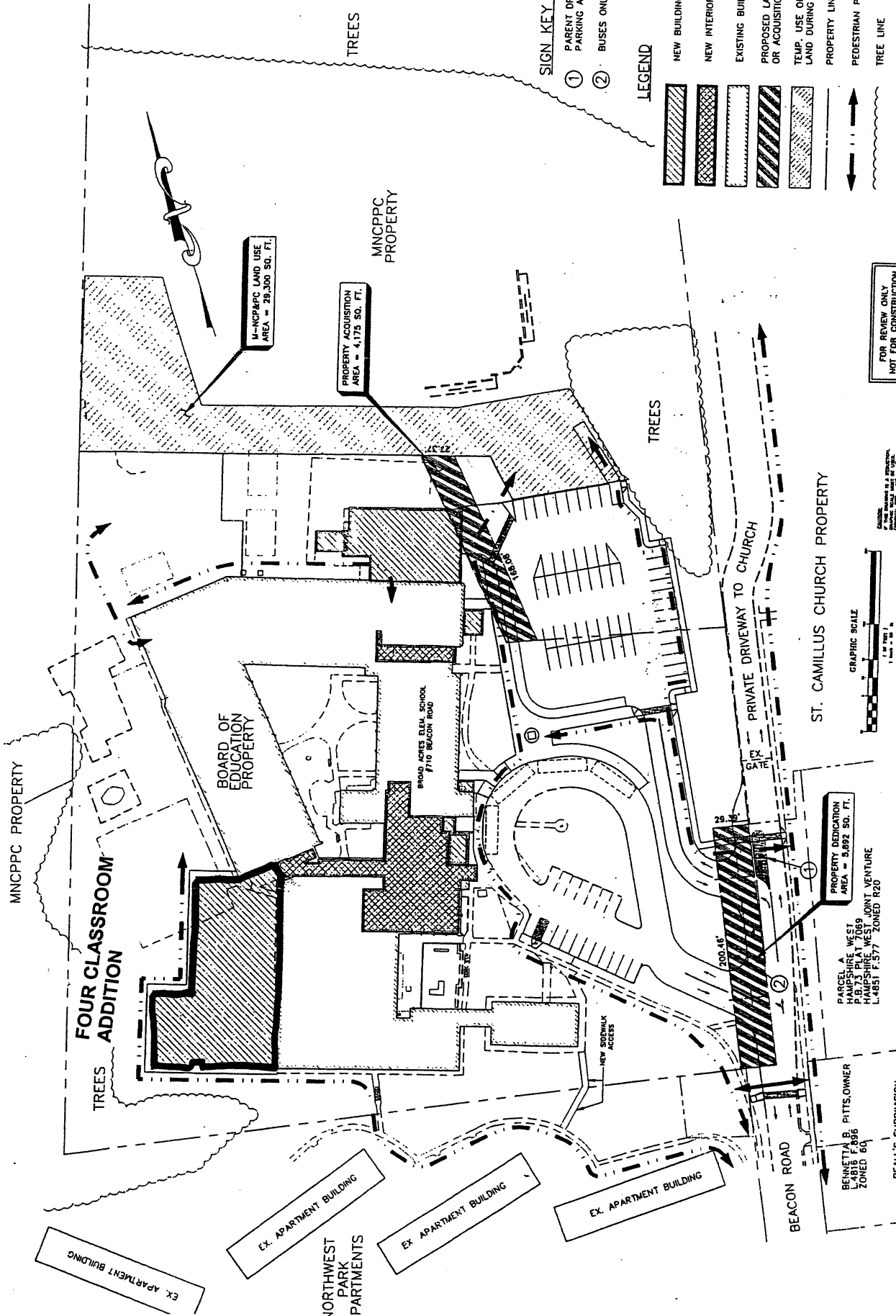

FOR REVIEW ONLY  
NOT FOR CONSTRUCTION



3/31/2003 - CONSTRUCTION DOCUMENTS

COMPOSITE OF ADJACENT PROPERTIES & CASITE SURVAY PLAN  
Date: 03/15/03  
Scale: 1" = 100'

PROPOSED ADDITIONS / RENOVATIONS TO  
**BROAD ACRES ELEMENTARY SCHOOL**  
SILVER SPRING, MARYLAND  
FOR  
MONTGOMERY CO. PUBLIC SCHOOLS

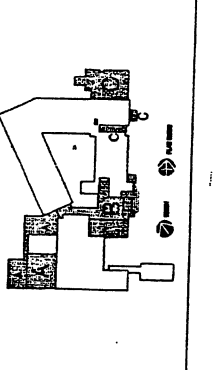

**AMT**  
ARCHITECTURAL MODELING TECHNOLOGIES, INC.  
10000 Rockville Pike, Suite 200  
Rockville, MD 20850  
Tel: (301) 484-8888 Fax: (301) 484-8889  
AMT PROJECT NO. 100-0101-01

OWNER/APPLICANT  
MONTGOMERY COUNTY PUBLIC SCHOOLS  
DIVISION OF CONSTRUCTION  
"FESTIVAL CENTER"  
10000 Rockville Pike, Suite 200  
Rockville, MD 20850  
Tel: (301) 484-8888 Fax: (301) 484-8889

LEASEE  
BROAD ACRES ELEMENTARY SCHOOL  
10000 Rockville Pike, Suite 200  
Rockville, MD 20850  
Tel: (301) 484-8889

MISS. LUTELY  
1-800-237-7777, all times prior to the date of sale. The  
plan of proposed subdivision and other information required by the  
State of Maryland, Department of General Services, Division of  
Land Administration & Surveying, shall be the authoritative source.

BENNETTA B. PITTS, OWNER  
P.B. 64 P. 5437  
ZONED 60-86

BEALL'S SUBDIVISION  
P.B. 64 P. 5437  
ZONED 60-86

# Attachment 3- Broadacres Local Park Renovation Schedule and Draft Charrette Program

## DRAFT PROGRAM BROAD ACRES SCHOOL AND PARK CHARRETTE

### Goals for the Planning and Design Charrette with the Broad Acres Elementary School Children

- Discover how they use the park next to the school. How do they play? Does the whole family use the park and how?
- Determine what recreational facilities are needed that currently are not provided.
- Determine what can be done in the park that would improve the community access to park, visibility and attractiveness of park and make the park a nicer environment to be in.
- Teach children how they can be involved with the planning of their environment.
- Educate the children and teachers about the environmental resources that exist on site and within the adjacent forest. Teach them how to be stewards of their park.
- Determine programs or products that can be the result of the charrette (besides the concept plan for the new park). Can the students help design trail signage for the natural surface trail with the help of the art teacher? Can the students create artwork that shows ideas for the new park? Can the teachers incorporate an outdoor learning curriculum that focuses on the adjacent park? Should a heart smart type fitness program be incorporated into the circular trail? Can a school garden (for vegetables, flowers, etc.) be made available?
- Determine who takes care of the facilities and how maintenance might be shared.

### Method for meeting goals:

1. MNCPPC to meet on a weekday with school children and teacher (class TBD). 3-4 hours total meeting time (picnic lunch in between).
2. MNCPPC staff will have maps of park and school and discuss what we are trying to achieve.
3. Question and answer period for how the students use their park. Each child will have a turn. (20 minutes) How many children walk to the park, how many drive? When are they there? What do they do? Add more questions.
4. Students will draw ideas for the park (20 minutes).
5. Group will go outside for educational hike along nature trail. (45 minutes). Provide handouts with typical native species for children to look at and read about.
6. Group takes cut outs of park facilities and play with what goes best together outside on blank park maps (1 hour in small groups of 5-6).