

Item #16
18



THE MARYLAND-NATIONAL CAPITAL PARK AND PLANNING COMMISSION

M E M O R A N D U M

DATE: September 22, 2003
TO: Montgomery County Planning Board
FROM: A. Malcolm Shaneman
Development Review Division
(301) 495-4587
SUBJECT: Informational Maps for Subdivision Items on the
Planning Board's Agenda for September 26, 2003.

Attached are copies of plan drawings for Item #12, #13, #14, #15, #16 and #18. These subdivision items are scheduled for Planning Board consideration on September 26, 2003. The items are further identified as follows:

- Agenda Item #12 - Preliminary Plan 1-03088
Verizon Clarksburg Comm. Center
- Agenda Item #13 - Preliminary Plan 1-03094
Glen Echo Heights
- Agenda Item #14 - Preliminary Plan 1-03083
Barnsley's Addition to Olney
- Agenda Item #15 - Preliminary Plan 1-03077
Snowden's Mill
- Agenda Item #16 - Preliminary Plan 1-00040
Resurrection Baptist Church
- Agenda Item #18 - Subdivision Regulation Waiver SRW-04002
United Therapeutics

Attachment

UNITED THERAPEUTICS (SRW-04002)

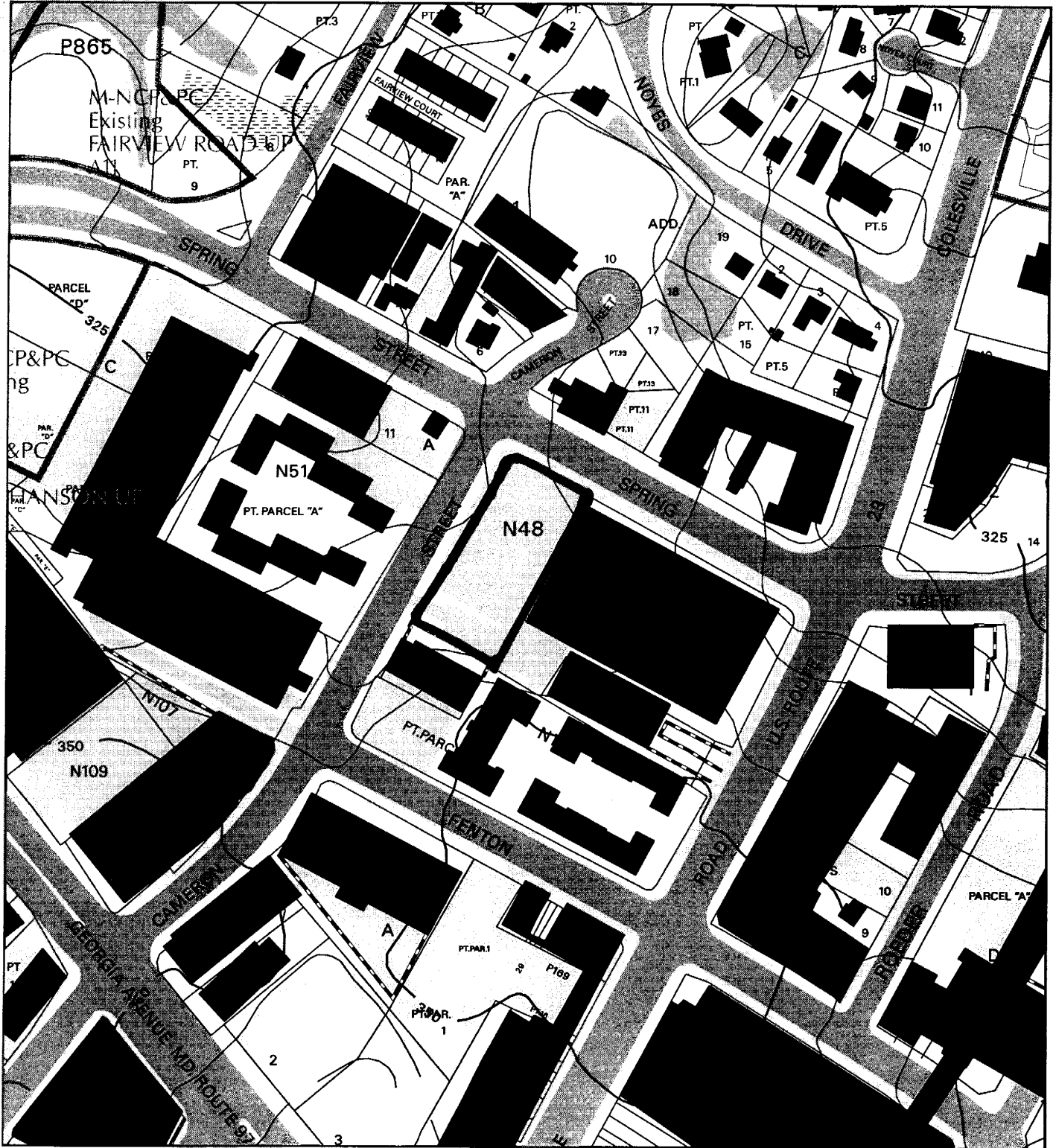

Map compiled on September 12, 2003 at 12:25 PM | Site located on base sheet no - 210NW01

NOTICE

The planimetric, property, and topographic information shown on this map is based on copyrighted Map Products from the Montgomery County Department of Park and Planning of the Maryland - National Capital Park and Planning Commission, and may not be copied or reproduced without written permission from M-NCPPC.

Property lines are compiled by adjusting the property lines to topography created from aerial photography and should not be interpreted as actual field surveys. Planimetric features were compiled from 1:14400 scale aerial photography using stereo photogrammetric methods.

This map is created from a variety of data sources, and may not reflect the most current conditions in any one location and may not be completely accurate or up to date. All map features are approximately within five feet of their true location. This map may not be the same as a map of the same area plotted at an earlier time as the data is continuously updated. Use of this map, other than for general planning purposes is not recommended. - Copyright 1998

Key Map



1 : 2400

UNITED THERAPEUTICS (SRW-04002)

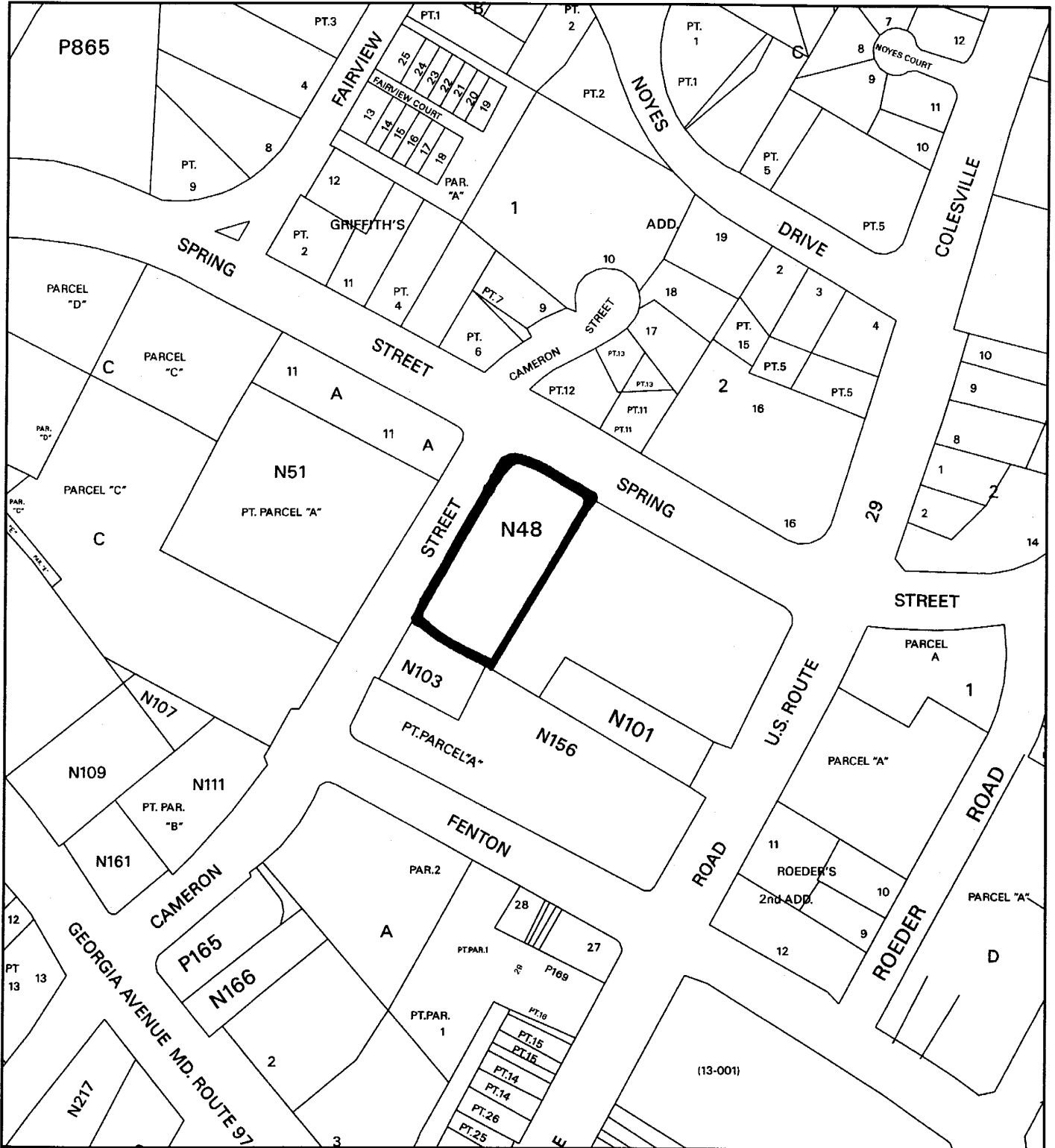

Map compiled on September 12, 2003 at 12:20 PM | Site located on base sheet no - 210NW01

NOTICE

The planimetric, property, and topographic information shown on this map is based on copyrighted Map Products from the Montgomery County Department of Park and Planning of the Maryland - National Capital Park and Planning Commission, and may not be copied or reproduced without written permission from M-NCPPC.

Property lines are compiled by adjusting the property lines to topography created from aerial photography and should not be interpreted as actual field surveys. Planimetric features were compiled from 1:14400 scale aerial photography using stereo photogrammetric methods.

This map is created from a variety of data sources, and may not reflect the most current conditions in any one location and may not be completely accurate or up to date. All map features are approximately within five feet of their true location. This map may not be the same as a map of the same area plotted at an earlier time as the data is continuously updated. Use of this map, other than for general planning purposes is not recommended. - Copyright 1998

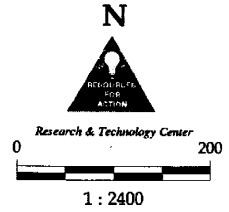

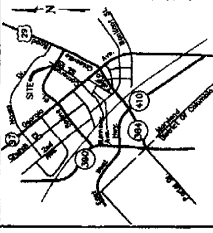

VICINITY MAP
SCALE 1" = 2,000'

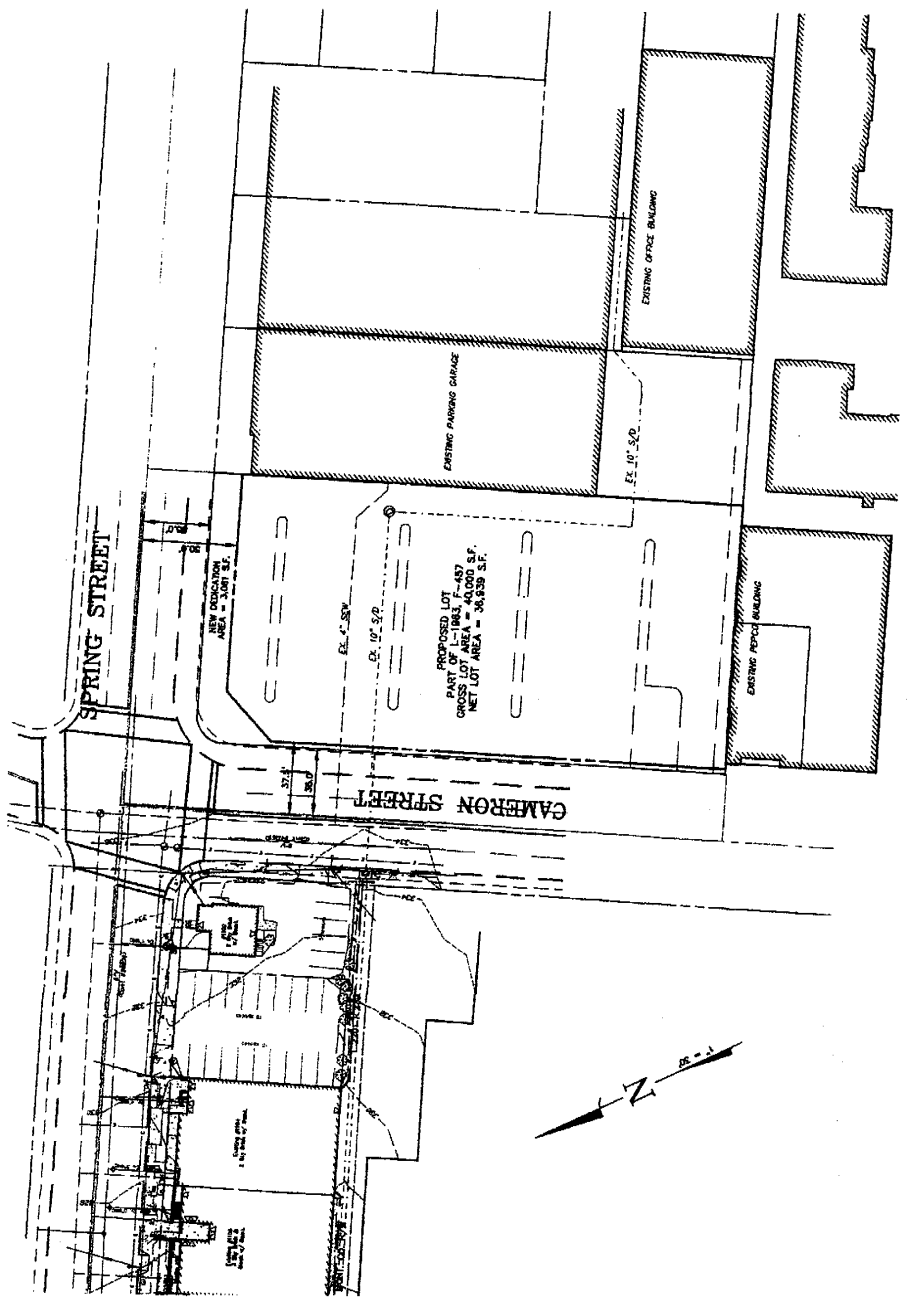

TAX MAP 88-343

WSEC 210 MP 01

SITE IDENTIFICATION PLAN

UNITED THERAPEUTICS
COUNTY PARKING LOT #21 - PART OF LIBER 1983 FOLIO 457
13TH ELECTION DISTRICT - MONTGOMERY COUNTY - MARYLAND

MHG Meade, Hanerick & Glascock, P.A.
Engineers, Planners & Surveyors
Landmarks Architects
1100 North Washington Blvd. 15
Suite 1000
Baltimore, MD 21201
Phone: 410.774.2600
Fax: 410.774.2601
www.mhg.com

Proj. No.	8-25-03
Date	8-25-03
Scale	1" = 30'
Sheet	1 of 2
Project No.	UC-210-13
Sheet	1 of 1

DEVELOPER/APPLICANT
UNITED PHARMACEUTICALS, INC.
15 WALNUT STREET
WELLESLEY, MA 02481
PHONE: 781-236-7412
FAX: 781-236-7241
ATTN.: MR. JAMES L. LEVIN