

Item #8



THE MARYLAND-NATIONAL CAPITAL PARK AND PLANNING COMMISSION

M E M O R A N D U M

DATE: October 10, 2003
TO: Montgomery County Planning Board
FROM: A. Malcolm Shaneman
Development Review Division
(301) 495-4587
SUBJECT: Informational Maps for Subdivision Items on the
Planning Board's Agenda for October 16, 2003.

Attached are copies of plan drawings for Item #07, #08, #10, #11, #12, and #13. These subdivision items are scheduled for Planning Board consideration on October 16, 2003. The items are further identified as follows:

Agenda Item #07 - Preliminary Plan 1-996007
Evangelical Lutheran Church

Agenda Item #08 - Preliminary Plan 1-02084
Kingsview Village

Agenda Item #10 - Pre-Preliminary Plan 7-04001
North Bethesda Town Center

Agenda Item #11 - Preliminary Plan 1-98056A
Great Oaks

Agenda Item #12 - Preliminary Plan 1-01010A
Burnt Mills Shopping Center

Agenda Item #13 - Pre-Preliminary Plan 7-04004
Edgemoor, Lots 22 & 23, Blk.17

Attachment

KINGSVIEW VILLAGE (1-02084)

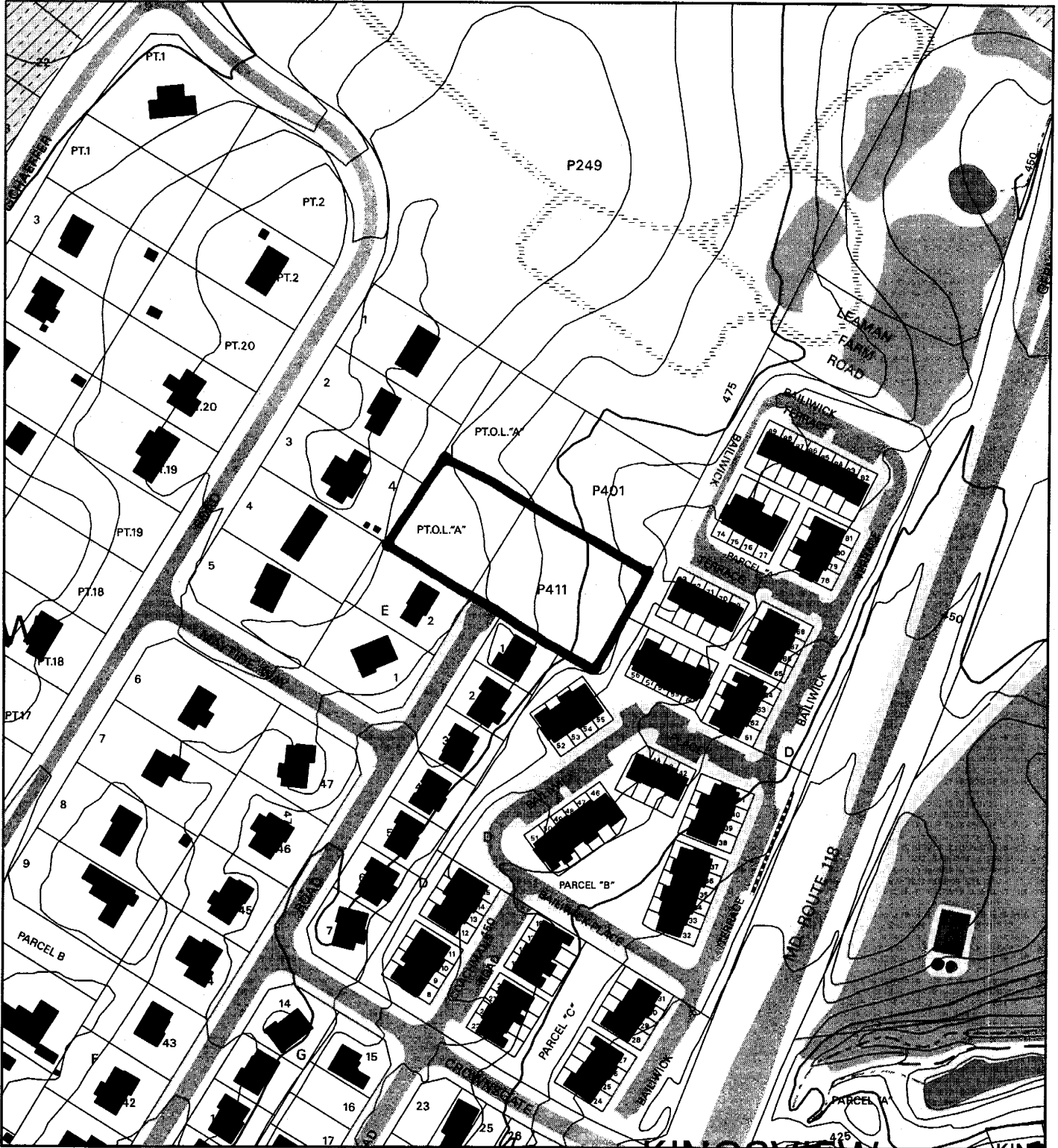

Map compiled on October 09, 2003 at 4:54 PM | Site located on base sheet no - 225NW14

NOTICE

The planimetric, property, and topographic information shown on this map is based on copyrighted Map Products from the Montgomery County Department of Park and Planning of the Maryland -National Capital Park and Planning Commission, and may not be copied or reproduced without written permission from M-NCPPC.

Property lines are compiled by adjusting the property lines to topography created from aerial photography and should not be interpreted as actual field surveys. Planimetric features were compiled from 1:14400 scale aerial photography using stereo photogrammetric methods.

This map is created from a variety of data sources, and may not reflect the most current conditions in any one location and may not be completely accurate or up to date. All map features are approximately within five feet of their true location. This map may not be the same as a map of the same area plotted at an earlier time as the data is continuously updated. Use of this map, other than for general planning purposes is not recommended. - Copyright 1998

Key Map

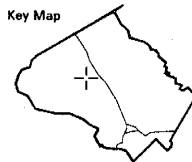

N



1 : 2400

KINGSVIEW VILLAGE (1-02084)

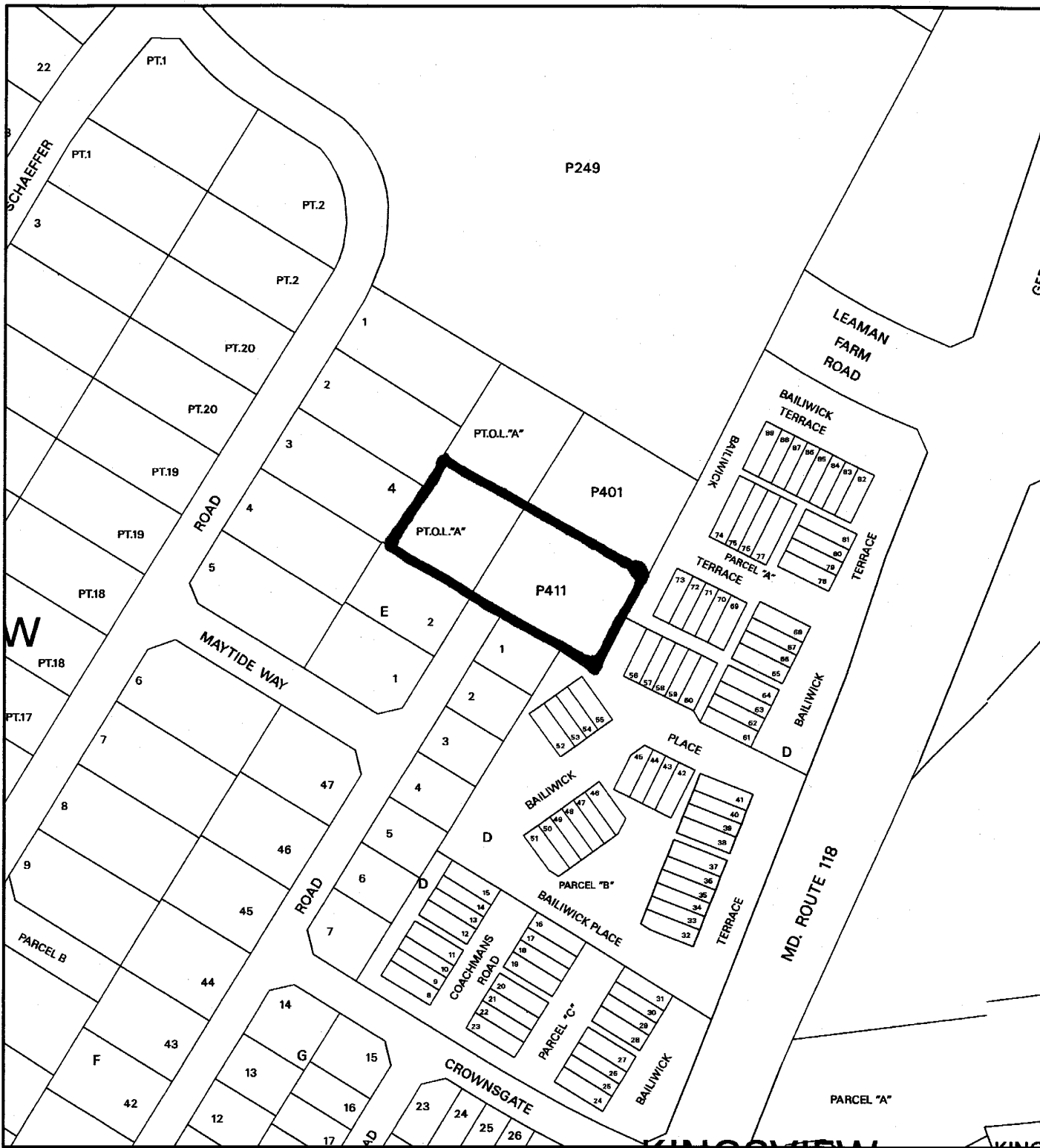

Map compiled on October 10, 2003 at 8:35 AM | Site located on base sheet no - 225NW14

NOTICE

The planimetric, property, and topographic information shown on this map is based on copyrighted Map Products from the Montgomery County Department of Park and Planning of the Maryland -National Capital Park and Planning Commission, and may not be copied or reproduced without written permission from M-NCPPC.

Property lines are compiled by adjusting the property lines to topography created from aerial photography and should not be interpreted as actual field surveys. Planimetric features were compiled from 1:14400 scale aerial photography using stereo photogrammetric methods.

This map is created from a variety of data sources, and may not reflect the most current conditions in any one location and may not be completely accurate or up to date. All map features are approximately within five feet of their true location. This map may not be the same as a map of the same area plotted at an earlier time as the data is continuously updated. Use of this map, other than for general planning purposes is not recommended. - Copyright 1998



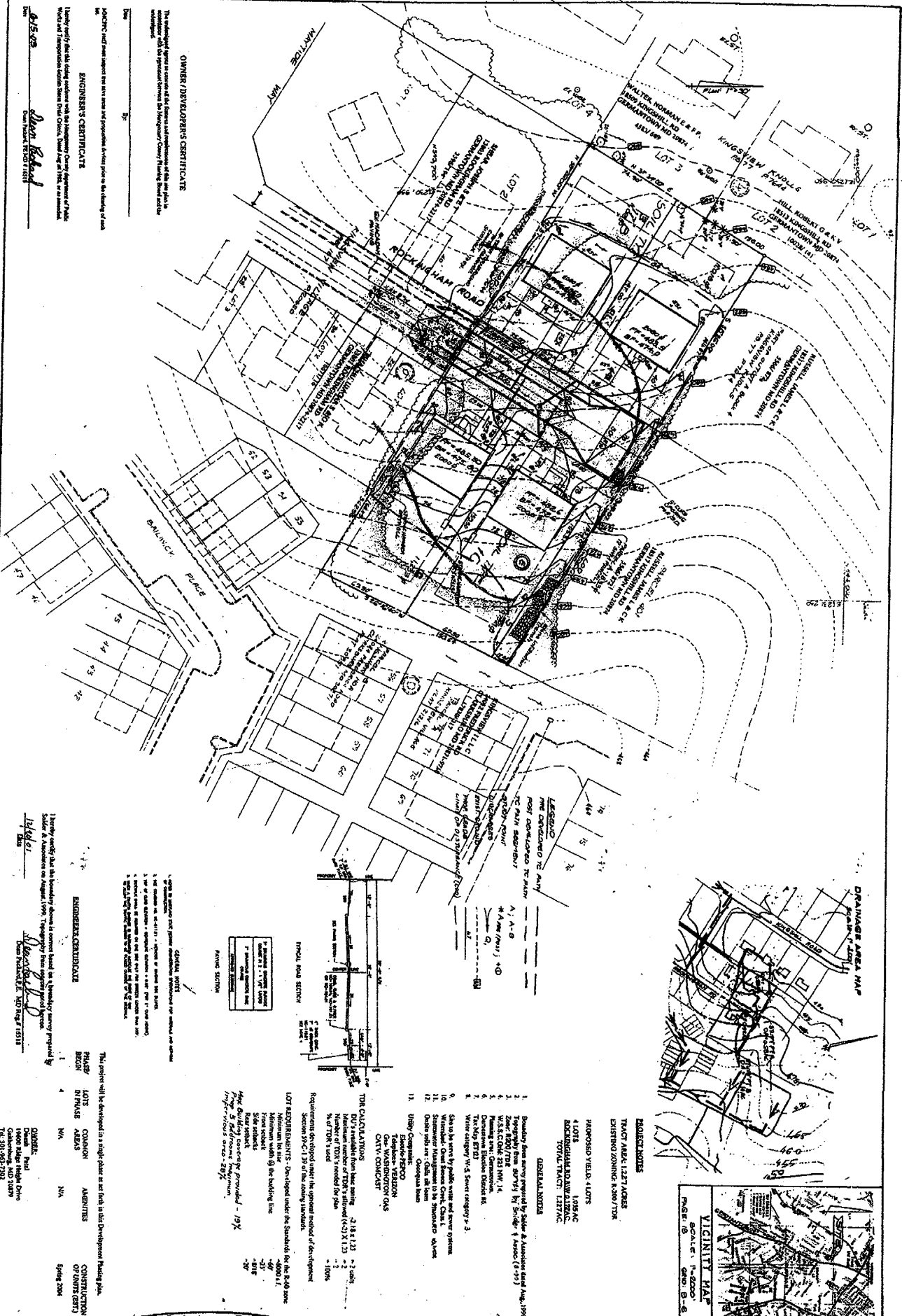

OWNER / DEVELOPER'S CERTIFICATE

The undersigned certifies that the information contained in this plan is true and correct to the best of his knowledge and belief, and that he is the owner of the land shown hereon.

ENGINEER'S CERTIFICATE

I hereby certify that the information contained in this plan is true and correct to the best of my knowledge and belief, and that I am a duly licensed Professional Engineer in the State of Maryland.

Alan R. Reed
 Professional Engineer
 License No. 15118

Alan R. Reed
 Professional Engineer
 License No. 15118

The project will be developed in a single phase or in lots in the Development Planning Phase.

PHASE	LOTS	COMMON	AREAS	AMENITIES	CONSTRUCTION OF LOTS (ERT)
1	1-10	100%	100%	100%	100%
2	11-20	100%	100%	100%	100%
3	21-30	100%	100%	100%	100%
4	31-40	100%	100%	100%	100%
5	41-50	100%	100%	100%	100%
6	51-60	100%	100%	100%	100%
7	61-70	100%	100%	100%	100%
8	71-80	100%	100%	100%	100%
9	81-90	100%	100%	100%	100%
10	91-100	100%	100%	100%	100%

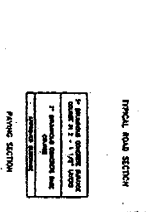

- REQUIREMENTS:**
1. Boundary lines shown prepared by Survey & Associates dated Aug. 1998.
 2. Proposed lots shown prepared by Survey & Associates dated Aug. 1998.
 3. Proposed roads shown prepared by Survey & Associates dated Aug. 1998.
 4. Proposed utilities shown prepared by Survey & Associates dated Aug. 1998.
 5. Proposed drainage shown prepared by Survey & Associates dated Aug. 1998.
 6. Proposed landscaping shown prepared by Survey & Associates dated Aug. 1998.
 7. Proposed site plan shown prepared by Survey & Associates dated Aug. 1998.
 8. Proposed site plan shown prepared by Survey & Associates dated Aug. 1998.
 9. Proposed site plan shown prepared by Survey & Associates dated Aug. 1998.
 10. Proposed site plan shown prepared by Survey & Associates dated Aug. 1998.
 11. Proposed site plan shown prepared by Survey & Associates dated Aug. 1998.
 12. Proposed site plan shown prepared by Survey & Associates dated Aug. 1998.
 13. Proposed site plan shown prepared by Survey & Associates dated Aug. 1998.
 14. Proposed site plan shown prepared by Survey & Associates dated Aug. 1998.
 15. Proposed site plan shown prepared by Survey & Associates dated Aug. 1998.
 16. Proposed site plan shown prepared by Survey & Associates dated Aug. 1998.
 17. Proposed site plan shown prepared by Survey & Associates dated Aug. 1998.
 18. Proposed site plan shown prepared by Survey & Associates dated Aug. 1998.
 19. Proposed site plan shown prepared by Survey & Associates dated Aug. 1998.
 20. Proposed site plan shown prepared by Survey & Associates dated Aug. 1998.

PROPOSED YIELD - LOTS

1. 1.05 AC
 2. 1.05 AC
 3. 1.05 AC
 4. 1.05 AC
 5. 1.05 AC
 6. 1.05 AC
 7. 1.05 AC
 8. 1.05 AC
 9. 1.05 AC
 10. 1.05 AC
 11. 1.05 AC
 12. 1.05 AC
 13. 1.05 AC
 14. 1.05 AC
 15. 1.05 AC
 16. 1.05 AC
 17. 1.05 AC
 18. 1.05 AC
 19. 1.05 AC
 20. 1.05 AC



LOTS 3-6 BLOCK

SITE PLAN

KINGSVIEW VILLAGE

UBER 17187 FOLD 300

PARCEL 411 AND

A REDEVELOPMENT OF LOT 1 & 2, BLOCK 4, KINGSVIEW ESTATES (A677164)

DARHESSTOWN (202) ELECTION DISTRICT

MONTGOMERY COUNTY, MARYLAND

P.G. ASSOCIATES, INC.

CIVIL ENGINEERS * SURVEYORS * LAND PLANNERS

354-A HUNGERFORD DRIVE
 ROCKVILLE MARYLAND 20850
 PHONE (301) 309-1361

RECEIVED

JUL 24 2003

DRWING 7125103