

Item #8



THE MARYLAND-NATIONAL CAPITAL PARK AND PLANNING COMMISSION

M E M O R A N D U M

DATE: December 12, 2003
TO: Montgomery County Planning Board
FROM: A. Malcolm Shaneman
Development Review Division
(301) 495-4587
SUBJECT: Informational Maps for Subdivision Items on the
Planning Board's Agenda for December 18, 2003.

Attached are copies of plan drawings for Item #07, #08, #10, #12 and #13. These subdivision items are scheduled for Planning Board consideration on December 18, 2003. The items are further identified as follows:

Agenda Item #07 -Preliminary Plan 1-04034
Pidgeonwood Village

Agenda Item #08 -Preliminary Plan 1-04020
Day Property

Agenda Item #10 -Preliminary Plan 1-04017
Bethesda View

Agenda Item #12 -Preliminary Plan 1-03097
Hill Property

Agenda Item #13 -Preliminary Plan 1-03059
Baker Property

Attachment

DAY PROPERTY (1-04020) (8-04006)

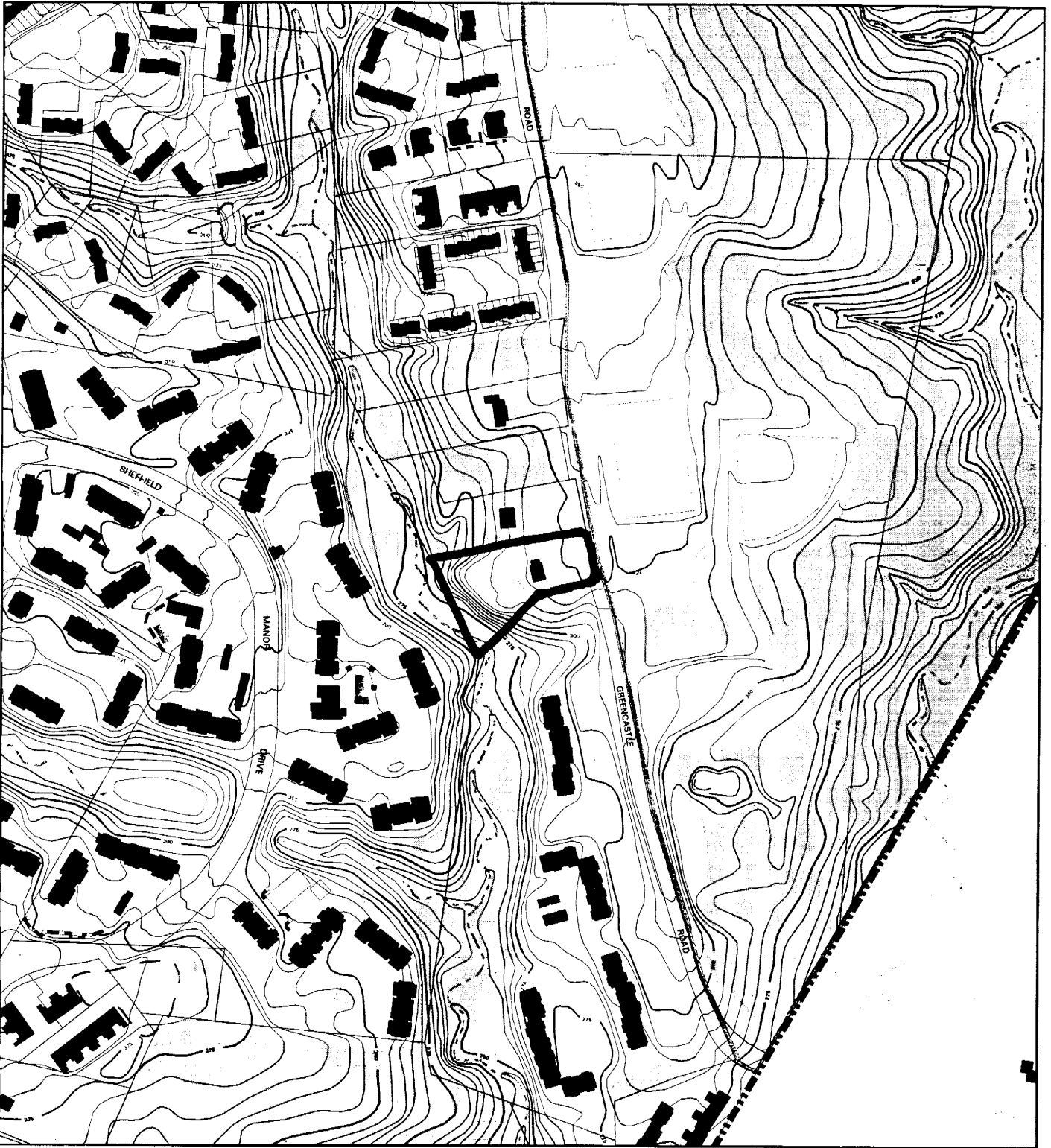

Map compiled on September 24, 2003 at 10:40 AM | Site located on base sheet no - 218NE04

NOTICE

The planimetric, property, and topographic information shown on this map is based on copyrighted Map Products from the Montgomery County Department of Park and Planning of the Maryland -National Capital Park and Planning Commission, and may not be copied or reproduced without written permission from M-NCPPC.

Property lines are compiled by adjusting the property lines to topography created from aerial photography and should not be interpreted as actual field surveys. Planimetric features were compiled from 1:14400 scale aerial photography using stereo photogrammetric methods.

This map is created from a variety of data sources, and may not reflect the most current conditions in any one location and may not be completely accurate or up to date. All map features are approximately within five feet of their true location. This map may not be the same as a map of the same area plotted at an earlier time as the data is continuously updated. Use of this map, other than for general planning purposes is not recommended. - Copyright 1998

Key Map

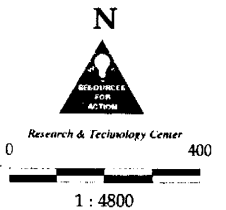
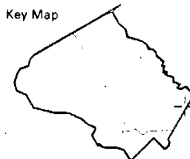

DAY PROPERTY (1-04020) (8-04006)

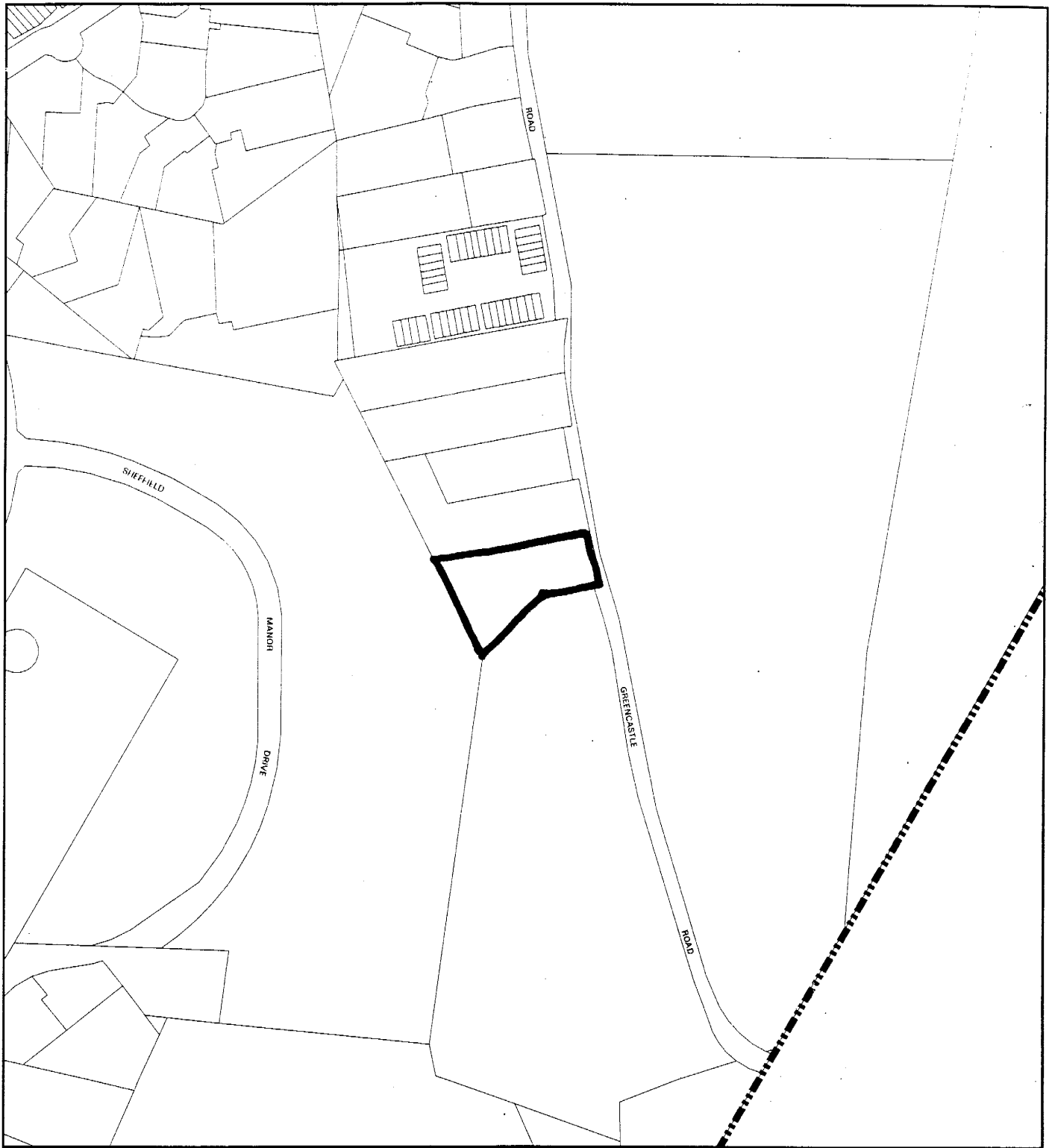

Map compiled on September 24, 2003 at 10:47 AM | Site located on base sheet no - 218NE04

NOTICE

The planimetric, property, and topographic information shown on this map is based on copyrighted Map Products from the Montgomery County Department of Park and Planning of the Maryland - National Capital Park and Planning Commission, and may not be copied or reproduced without written permission from M-NCPPC.

Property lines are compiled by adjusting the property lines to topography created from aerial photography and should not be interpreted as actual field surveys. Planimetric features were compiled from 1:14400 scale aerial photography using stereo photogrammetric methods.

This map is created from a variety of data sources, and may not reflect the most current conditions in any one location and may not be completely accurate or up to date. All map features are approximately within five feet of their true location. This map may not be the same as a map of the same area plotted at an earlier time as the data is continuously updated. Use of this map, other than for general planning purposes is not recommended. - Copyright 1998

Key Map

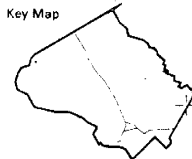

N



Research & Technology Center



1 : 4800

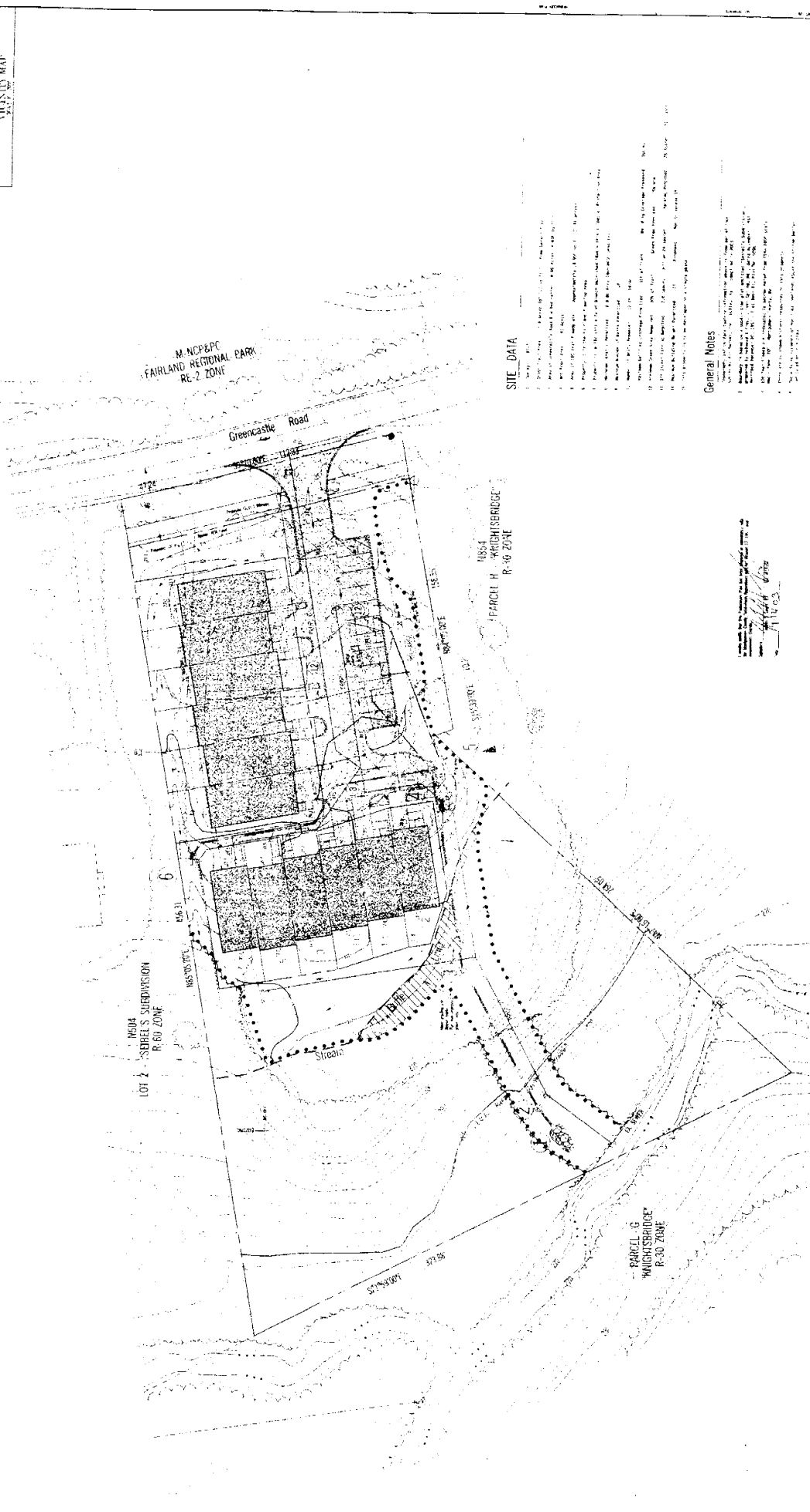
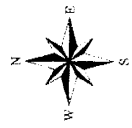
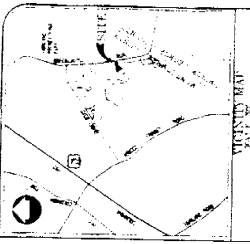

M. NCP&PC
FAIRLAND REGIONAL PARK
RE-2 ZONE

SITE DATA

- 1. Project Name: [illegible]
- 2. Project Location: [illegible]
- 3. Project Owner: [illegible]
- 4. Project Engineer: [illegible]
- 5. Project Date: [illegible]
- 6. Project Status: [illegible]
- 7. Project Description: [illegible]
- 8. Project Objectives: [illegible]
- 9. Project Constraints: [illegible]
- 10. Project Assumptions: [illegible]
- 11. Project Risks: [illegible]
- 12. Project Deliverables: [illegible]
- 13. Project Schedule: [illegible]
- 14. Project Budget: [illegible]
- 15. Project Team: [illegible]

General Notes

- 1. This plan is a preliminary plan and is not to be used for construction.
- 2. The site is subject to all applicable laws, codes, and regulations.
- 3. The site is subject to all applicable zoning and subdivision laws.
- 4. The site is subject to all applicable utility laws and regulations.
- 5. The site is subject to all applicable environmental laws and regulations.
- 6. The site is subject to all applicable transportation laws and regulations.
- 7. The site is subject to all applicable fire and safety laws and regulations.
- 8. The site is subject to all applicable health and safety laws and regulations.
- 9. The site is subject to all applicable accessibility laws and regulations.
- 10. The site is subject to all applicable energy and efficiency laws and regulations.

Site Plan
Archisbridge
Parcel H
R-10 Zone

<p>SITE SOLUTIONS, INC. 1000 GUY HARRISON BLVD. SUITE 1000 FARMINGTON, CT 06030 TEL: 860-676-1000 FAX: 860-676-1001 WWW.SITESOLUTIONS.COM</p>		<p>APPLICANT: [illegible] DATE: [illegible]</p>	<p>PROJECT: [illegible]</p>	<p>PRELIMINARY PLAN DAY PROPERTY GREENCASTLE REGIONAL PARK FAIRLAND, CT 06424</p>
---	--	---	--	---