

MEADOWSWEET
 1100 W. WASHINGTON STREET
 SUITE 100
 WASHINGTON, DC 20004
 TEL: (202) 331-1000
 FAX: (202) 331-1001

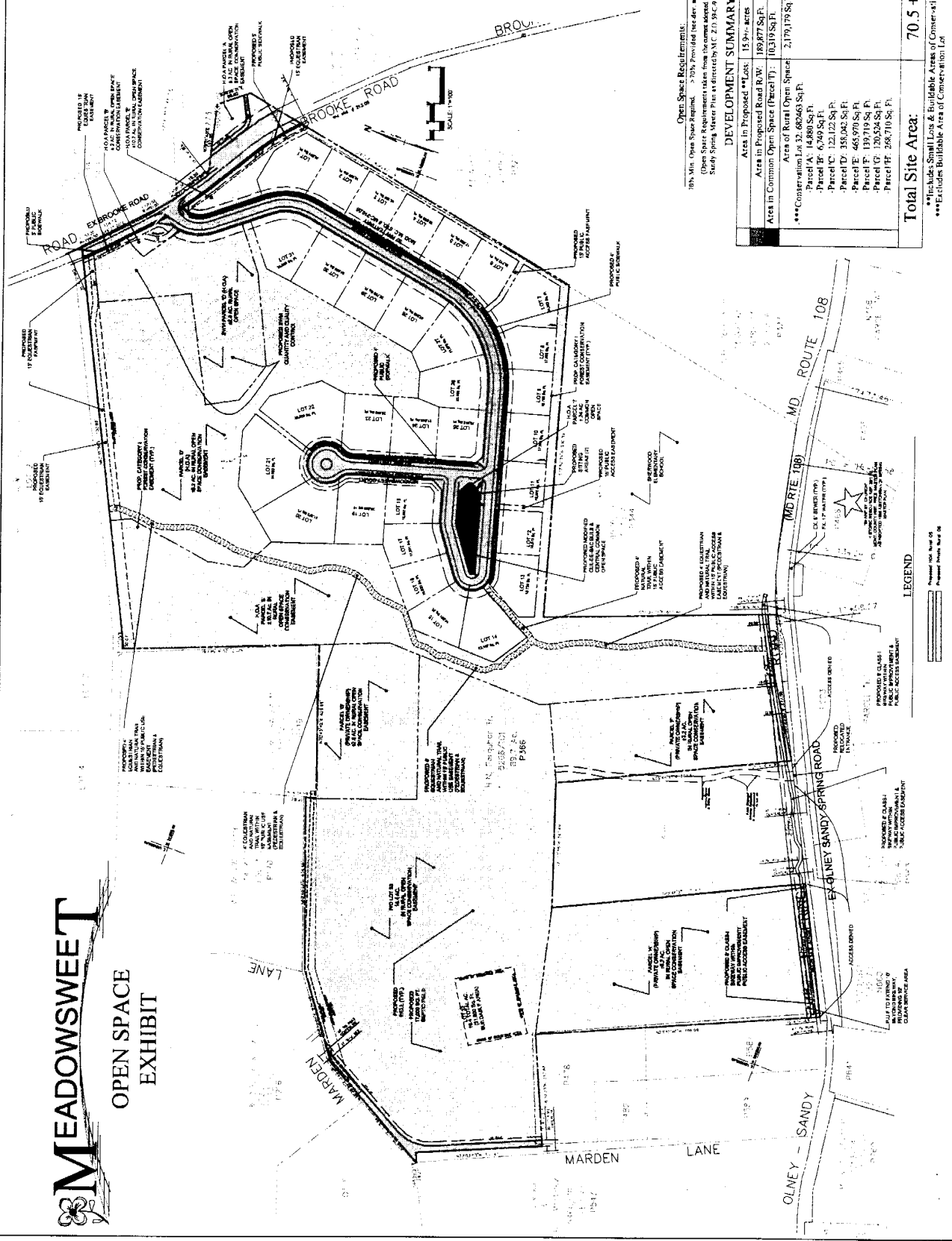

Open Space Requirements:
 75% Min. Open Space Required. > 75% Provided (see development plan)
 (Open Space Requirements taken from the current adopted Address
 Study Spring Water Plan as directed by M.C. Z.O. 94 C 9.31)

DEVELOPMENT SUMMARY:

| | |
|---------------------------------------|-------------------------------|
| Area in Proposed**Lot: | 15.9+/- acres |
| Area in Proposed Road R/W: | 18,877 Sq Ft |
| Area in Common Open Space (Parcel F): | 10,119 Sq Ft |
| Area of Rural Open Space: | 2,179,179 Sq Ft (70%) (50 AC) |
| Parcel A: | 14,880 Sq Ft |
| Parcel B: | 6,769 Sq Ft |
| Parcel C: | 12,172 Sq Ft |
| Parcel D: | 35,062 Sq Ft |
| Parcel E: | 46,970 Sq Ft |
| Parcel F: | 130,528 Sq Ft |
| Parcel H: | 288,710 Sq Ft |

Total Site Area: 70.5 +/- acres
 **Includes Small Lots & Buildable Area of Conservation Lot
 ***Excludes Buildable Area of Conservation Lot

| DATE | BY | REV. | DESCRIPTION |
|----------|----|------|------------------------|
| 08/11/09 | JL | 001 | ISSUE FOR PERMITTING |
| 08/11/09 | JL | 002 | REVISED PER PERMITTING |
| 08/11/09 | JL | 003 | REVISED PER PERMITTING |
| 08/11/09 | JL | 004 | REVISED PER PERMITTING |
| 08/11/09 | JL | 005 | REVISED PER PERMITTING |

| | |
|---|--|
| MEADOWSWEET 1100 W. WASHINGTON STREET SUITE 100 WASHINGTON, DC 20004 TEL: (202) 331-1000 FAX: (202) 331-1001 | RODAJINS CONSULTANTS 1100 W. WASHINGTON STREET SUITE 100 WASHINGTON, DC 20004 TEL: (202) 331-1000 FAX: (202) 331-1001 |
|---|--|

| | |
|--|---|
| MEADOWSWEET PREPARED FOR: POLITE HOMES 1100 W. WASHINGTON STREET SUITE 221 WASHINGTON, DC 20004 CONTACT: STEVE CONNOLLY | MEADOWSWEET 1100 W. WASHINGTON STREET SUITE 100 WASHINGTON, DC 20004 TEL: (202) 331-1000 FAX: (202) 331-1001 |
|--|---|

MEADOWSWEET

OPEN SPACE EXHIBIT