

WHITE FLINT PLACE, PHASE 2B

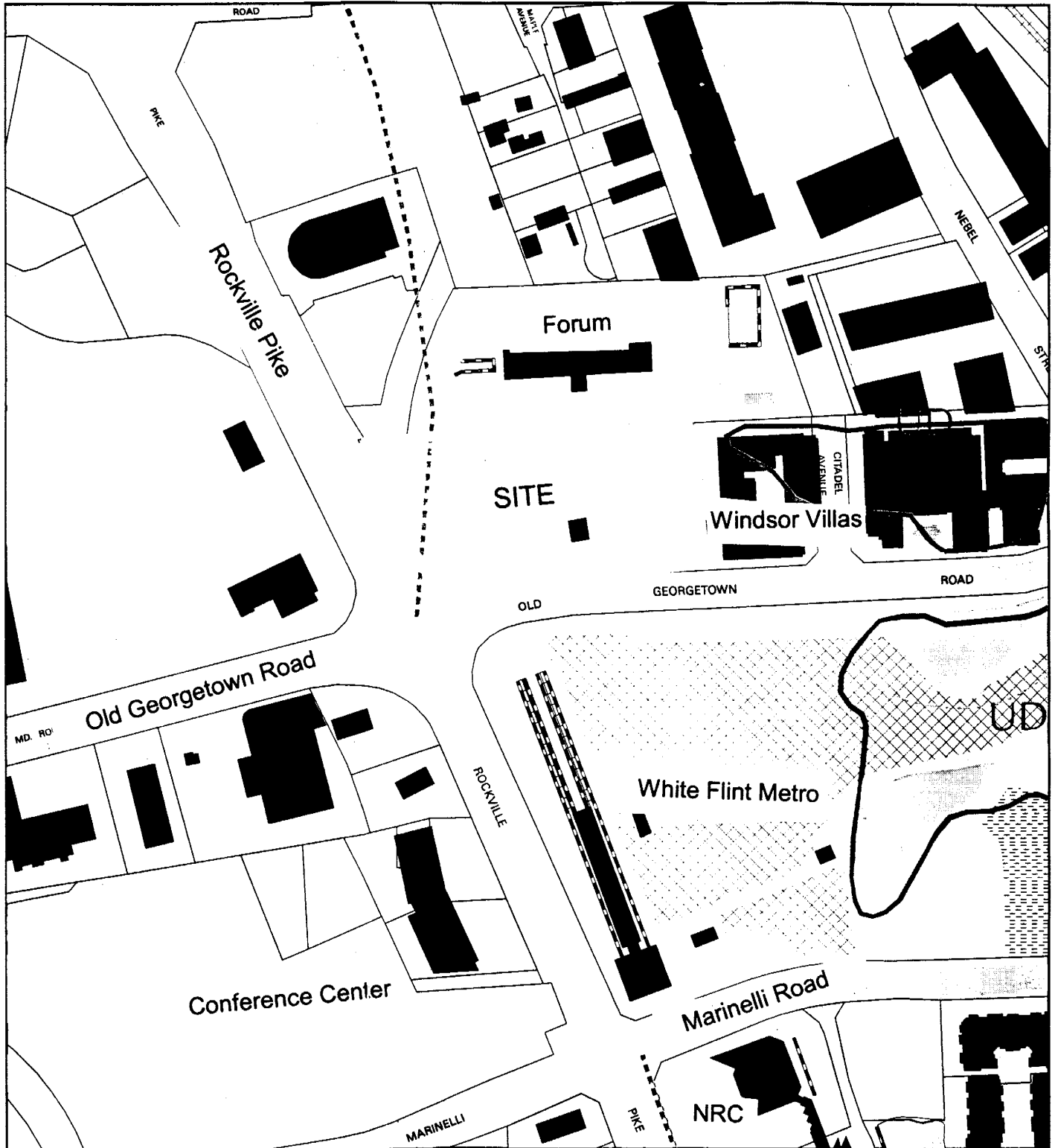

Map compiled on February 18, 2004 at 7:52 AM | Site located on base sheet no - 215NW05

NOTICE

The planimetric, property, and topographic information shown on this map is based on copyrighted Map Products from the Montgomery County Department of Park and Planning of the Maryland -National Capital Park and Planning Commission, and may not be copied or reproduced without written permission from M-NCPPC.

Property lines are compiled by adjusting the property lines to topography created from aerial photography and should not be interpreted as actual field surveys. Planimetric features were compiled from 1:14400 scale aerial photography using stereo photogrammetric methods.

This map is created from a variety of data sources, and may not reflect the most current conditions in any one location and may not be completely accurate or up to date. All map features are approximately within five feet of their true location. This map may not be the same as a map of the same area plotted at an earlier time as the data is continuously updated. Use of this map, other than for general planning purposes is not recommended. - Copyright 1998

Key Map

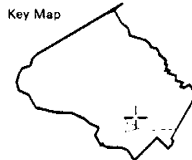

N



Research & Technology Center

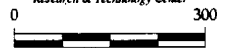

1 : 3600



ARCHITECT
 DONOHUE
 7110 Rockville Pike, Suite 100
 North Bethesda, Maryland 20852
 (301) 461-1111
 ARCHITECT'S REPORT
 7110 Rockville Pike, Suite 100
 North Bethesda, Maryland 20852
 (301) 461-1111
 PROJECT NO. 1000000000
 DATE: 01/18/18
 DRAWING NO. 1000000000-01
 SHEET NO. 1000000000-01-01
 PROJECT NAME
 PUBLIC SPACE AND PASSIVE AND ACTIVE RECREATION AREA
 7110 ROCKVILLE PIKE
 NORTH BETHESDA, MARYLAND 20852
 DATE: 01/18/18

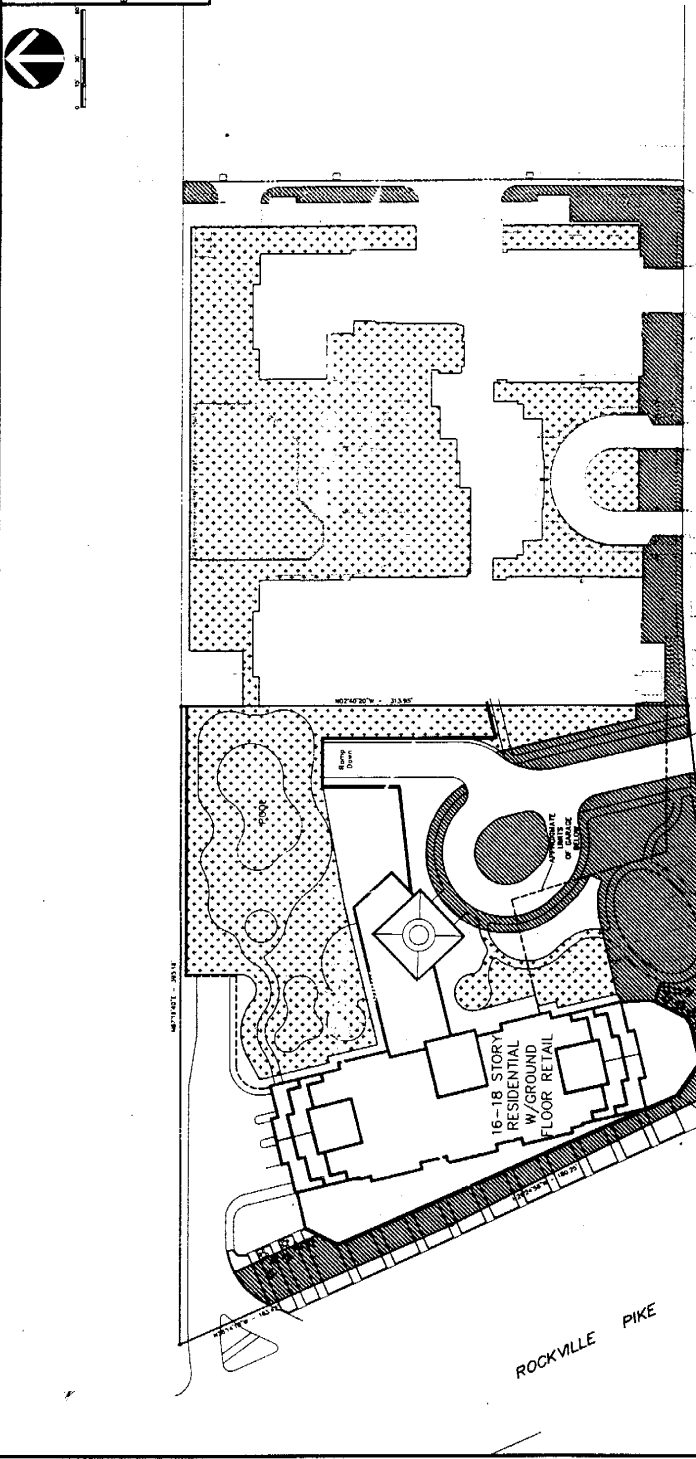
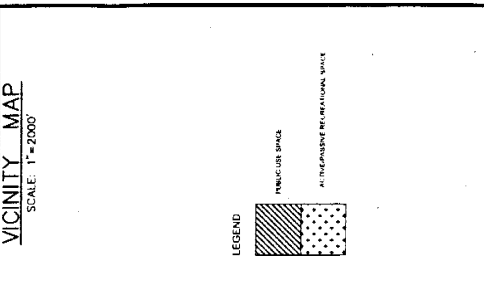
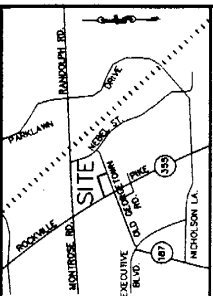

OLD GEORGETOWN ROAD
 & INTERSECTION POINTS
 TO BE DETERMINED BY OTHERS

PHASE	APPROXIMATE AREA (SQ FT)	APPROXIMATE PERCENTAGE OF TOTAL SITE AREA	APPROXIMATE PERCENTAGE OF TOTAL PHASE AREA
PHASE 1A	1,100	1.1%	100%
PHASE 1B	1,100	1.1%	100%
PHASE 2A	1,100	1.1%	100%
PHASE 2B	1,100	1.1%	100%
TOTAL	4,400	4.4%	100%

PUBLIC USE SPACE (10% OF NET USE REQUIRED) - 440 SQ FT
 APPROXIMATE PERCENTAGE OF TOTAL SITE AREA: 0.44%
 APPROXIMATE PERCENTAGE OF TOTAL PHASE AREA: 100%

ACTIVE/PASSIVE RECREATION SPACE (10% OF NET USE REQUIRED) - 440 SQ FT
 APPROXIMATE PERCENTAGE OF TOTAL SITE AREA: 0.44%
 APPROXIMATE PERCENTAGE OF TOTAL PHASE AREA: 100%

TOTAL PUBLIC USE SPACE: 440 SQ FT
 TOTAL ACTIVE/PASSIVE RECREATION SPACE: 440 SQ FT
 TOTAL PERCENTAGE OF PUBLIC USE SPACE AND ACTIVE/PASSIVE RECREATION SPACE: 0.88%

THE DETERMINATION OF PUBLIC USE SPACE AND ACTIVE/PASSIVE RECREATION SPACE WILL BE DETERMINED BY SITE PLAN
 AND PHASES.