

Item #11



MONTGOMERY COUNTY DEPARTMENT OF PARK AND PLANNING

THE MARYLAND-NATIONAL CAPITAL  
PARK AND PLANNING COMMISSION

8787 Georgia Avenue  
Silver Spring, Maryland 20910-3760

M E M O R A N D U M

DATE: April 30, 2004  
TO: Montgomery County Planning Board  
FROM: Richard Weaver  
Development Review Division  
(301) 495-4544  
SUBJECT: Informational Maps for Subdivision Items on the  
Planning Board's Agenda for May 06, 2004.

-----  
Attached are copies of plan drawings for Items #11, #12, and #13. These subdivision items are scheduled for Planning Board consideration on May 06, 2004. The items are further identified as follows:

Agenda Item #11 Preliminary Plan 1-04029  
Eton Square

Agenda Item #12 Preliminary Plan 1-04054  
Twinbrook Commons

Agenda Item #13 Preliminary Plan 1-03003  
Ancient Oak West

Attachment

# ETON SQUARE (1-04029)

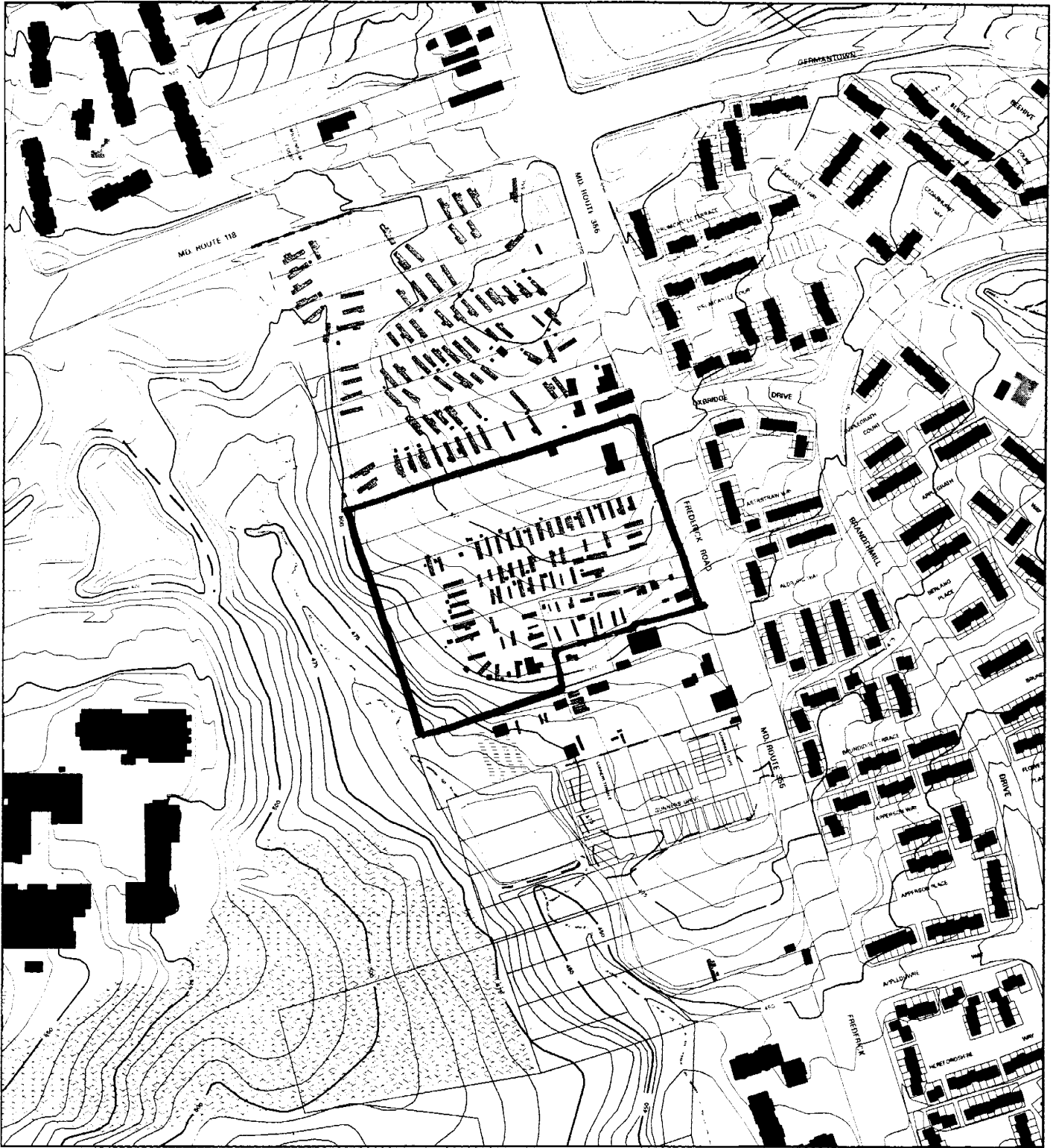

Map compiled on October 22, 2003 at 11:07 AM Site located on base sheet no - 228NW11

## NOTICE

The planimetric, property, and topographic information shown on this map is based on copyrighted Map Products from the Montgomery County Department of Park and Planning of the Maryland - National Capital Park and Planning Commission, and may not be copied or reproduced without written permission from M-NCPPC.

Property lines are compiled by adjusting the property lines to topography created from aerial photography and should not be interpreted as actual field surveys. Planimetric features were compiled from 1:14400 scale aerial photography using stereo photogrammetric methods.

This map is created from a variety of data sources, and may not reflect the most current conditions in any one location and may not be completely accurate or up to date. All map features are approximately within five feet of their true location. This map may not be the same as a map of the same area plotted at an earlier time as the data is continuously updated. Use of this map, other than for general planning purposes is not recommended. Copyright 1998

Key Map

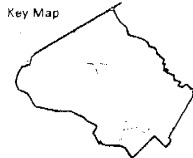

Research & Technology Center

0 400

1 : 4800

# ETON SQUARE (1-04029)

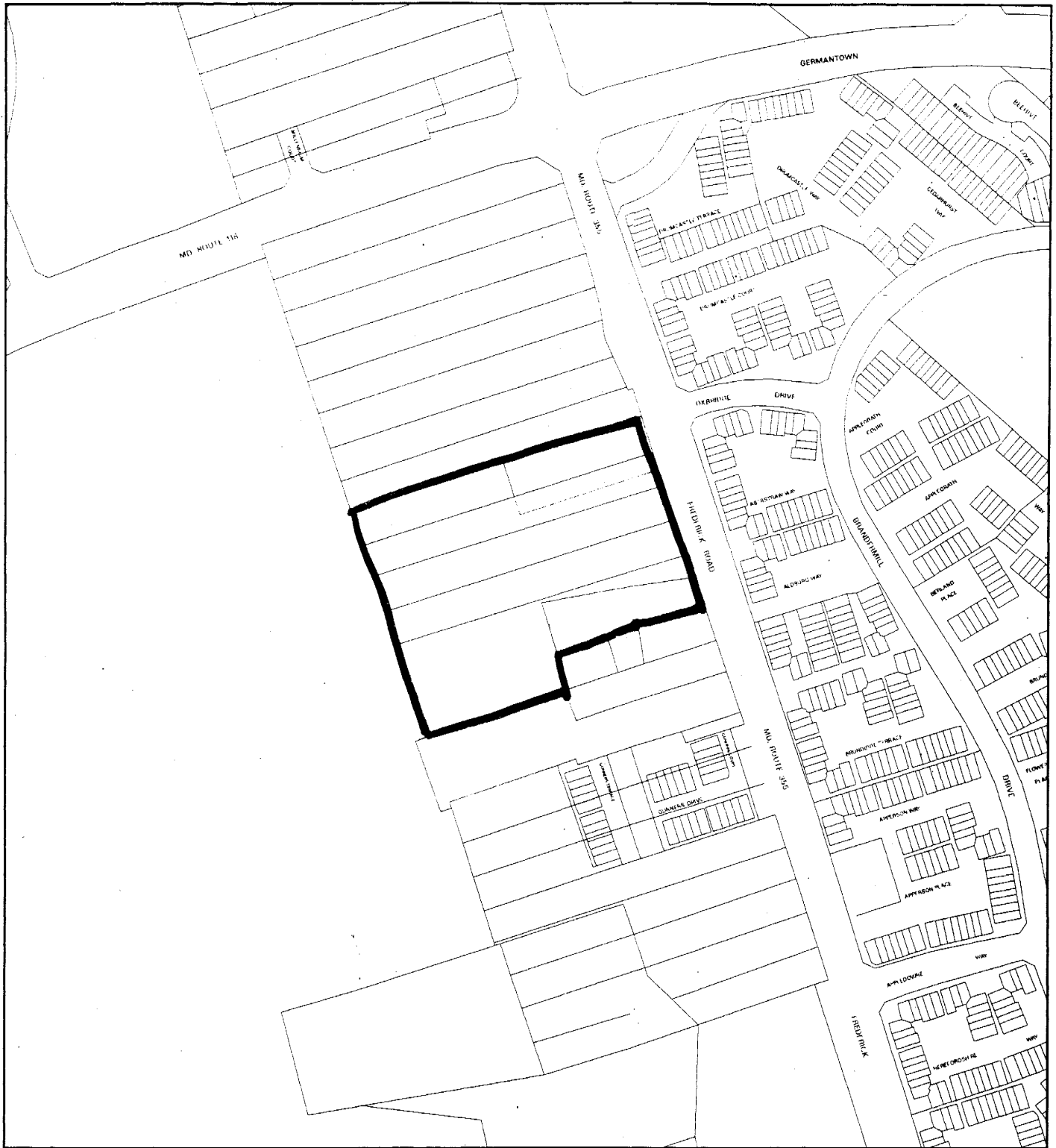

Map compiled on October 22, 2003 at 11:09 AM | Site located on base sheet no - 228NW11

## NOTICE

The planimetric, property, and topographic information shown on this map is based on copyrighted Map Products from the Montgomery County Department of Park and Planning of the Maryland -National Capital Park and Planning Commission, and may not be copied or reproduced without written permission from M-NCPPC.

Property lines are compiled by adjusting the property lines to topography created from aerial photography and should not be interpreted as actual field surveys. Planimetric features were compiled from 1:14400 scale aerial photography using stereo photogrammetric methods.

This map is created from a variety of data sources, and may not reflect the most current conditions in any one location and may not be completely accurate or up to date. All map features are approximately within five feet of their true location. This map may not be the same as a map of the same area plotted at an earlier time as the data is continuously updated. Use of this map, other than for general planning purposes is not recommended. - Copyright 1998

Key Map

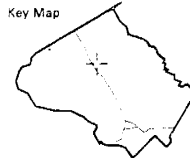

N



Research & Technology Center

0 400



1 : 4800

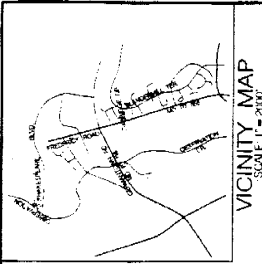

VICINITY MAP  
SCALE 1" = 200'

**GENERAL NOTES**

1. THIS PLAN HAS BEEN PREPARED BY THE ARCHITECT AND ENGINEER AND IS NOT TO BE CONSIDERED A CONTRACT DOCUMENT.
2. THE ARCHITECT AND ENGINEER HAS CONDUCTED VISUAL AND PHOTOGRAPHIC SURVEYS OF THE SITE AND VICINITY AND HAS FOUND NO SIGNIFICANT OBSTACLES TO THE DEVELOPMENT OF THE PROJECT.
3. THE ARCHITECT AND ENGINEER HAS CONDUCTED A VISUAL AND PHOTOGRAPHIC SURVEY OF THE SITE AND VICINITY AND HAS FOUND NO SIGNIFICANT OBSTACLES TO THE DEVELOPMENT OF THE PROJECT.
4. THE ARCHITECT AND ENGINEER HAS CONDUCTED A VISUAL AND PHOTOGRAPHIC SURVEY OF THE SITE AND VICINITY AND HAS FOUND NO SIGNIFICANT OBSTACLES TO THE DEVELOPMENT OF THE PROJECT.
5. THE ARCHITECT AND ENGINEER HAS CONDUCTED A VISUAL AND PHOTOGRAPHIC SURVEY OF THE SITE AND VICINITY AND HAS FOUND NO SIGNIFICANT OBSTACLES TO THE DEVELOPMENT OF THE PROJECT.

1. THE SITE IS TO BE DEVELOPED IN ACCORDANCE WITH THE ZONING REGULATIONS OF MARYLAND, MONTGOMERY COUNTY AND THE CITY OF GAITHERSBURG. THE ARCHITECT AND ENGINEER HAS CONDUCTED A VISUAL AND PHOTOGRAPHIC SURVEY OF THE SITE AND VICINITY AND HAS FOUND NO SIGNIFICANT OBSTACLES TO THE DEVELOPMENT OF THE PROJECT.

2. THE ARCHITECT AND ENGINEER HAS CONDUCTED A VISUAL AND PHOTOGRAPHIC SURVEY OF THE SITE AND VICINITY AND HAS FOUND NO SIGNIFICANT OBSTACLES TO THE DEVELOPMENT OF THE PROJECT.

3. THE ARCHITECT AND ENGINEER HAS CONDUCTED A VISUAL AND PHOTOGRAPHIC SURVEY OF THE SITE AND VICINITY AND HAS FOUND NO SIGNIFICANT OBSTACLES TO THE DEVELOPMENT OF THE PROJECT.

4. THE ARCHITECT AND ENGINEER HAS CONDUCTED A VISUAL AND PHOTOGRAPHIC SURVEY OF THE SITE AND VICINITY AND HAS FOUND NO SIGNIFICANT OBSTACLES TO THE DEVELOPMENT OF THE PROJECT.

5. THE ARCHITECT AND ENGINEER HAS CONDUCTED A VISUAL AND PHOTOGRAPHIC SURVEY OF THE SITE AND VICINITY AND HAS FOUND NO SIGNIFICANT OBSTACLES TO THE DEVELOPMENT OF THE PROJECT.

6. THE ARCHITECT AND ENGINEER HAS CONDUCTED A VISUAL AND PHOTOGRAPHIC SURVEY OF THE SITE AND VICINITY AND HAS FOUND NO SIGNIFICANT OBSTACLES TO THE DEVELOPMENT OF THE PROJECT.

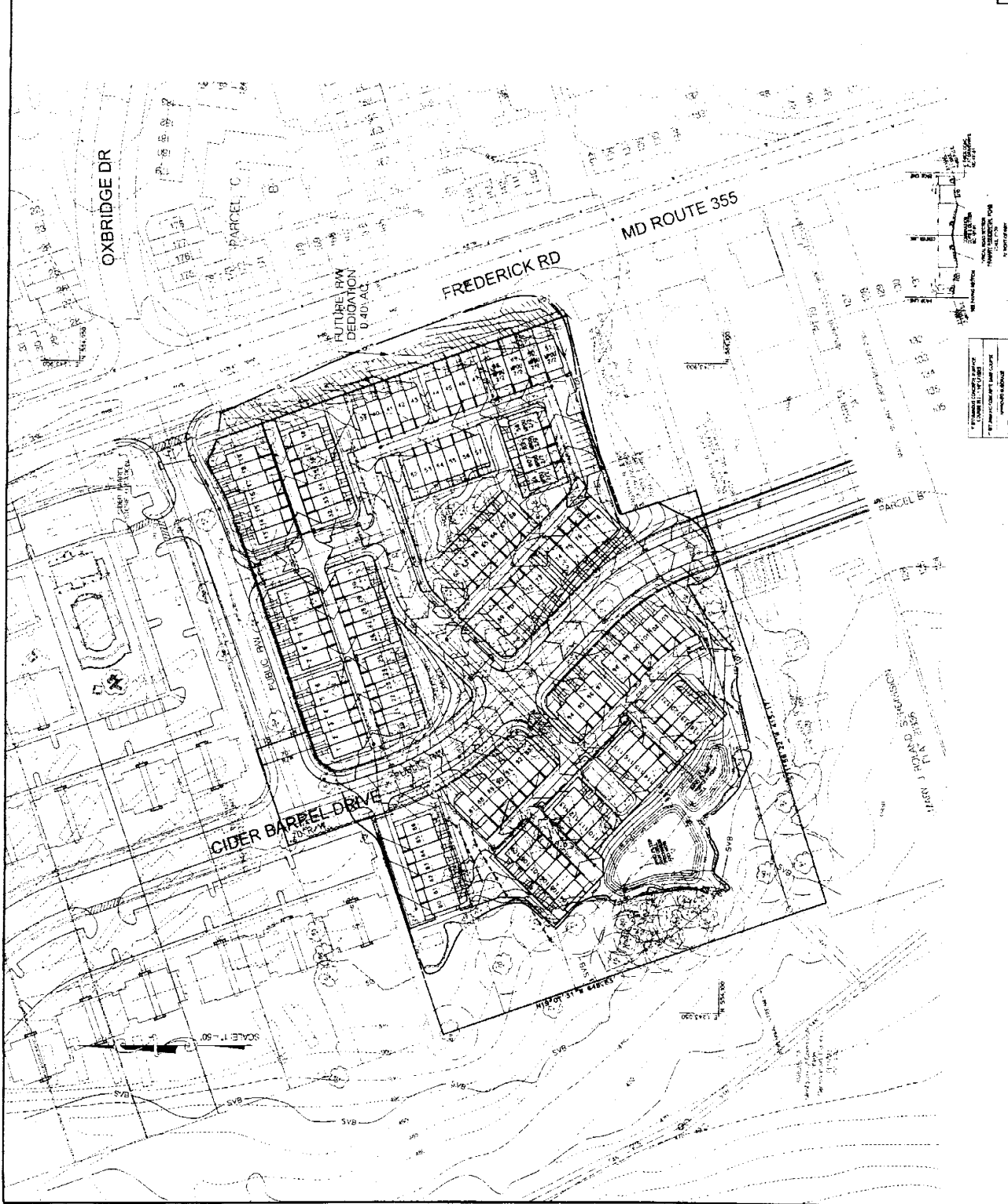

**PROPOSED**

1. THE ARCHITECT AND ENGINEER HAS CONDUCTED A VISUAL AND PHOTOGRAPHIC SURVEY OF THE SITE AND VICINITY AND HAS FOUND NO SIGNIFICANT OBSTACLES TO THE DEVELOPMENT OF THE PROJECT.

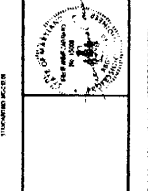

**PROPOSED**

1. THE ARCHITECT AND ENGINEER HAS CONDUCTED A VISUAL AND PHOTOGRAPHIC SURVEY OF THE SITE AND VICINITY AND HAS FOUND NO SIGNIFICANT OBSTACLES TO THE DEVELOPMENT OF THE PROJECT.

NO.	REVISION	DATE
1	ISSUED FOR PERMITTING	10/15/2003
2	ISSUED FOR PERMITTING	10/15/2003
3	ISSUED FOR PERMITTING	10/15/2003
4	ISSUED FOR PERMITTING	10/15/2003
5	ISSUED FOR PERMITTING	10/15/2003
6	ISSUED FOR PERMITTING	10/15/2003
7	ISSUED FOR PERMITTING	10/15/2003
8	ISSUED FOR PERMITTING	10/15/2003
9	ISSUED FOR PERMITTING	10/15/2003
10	ISSUED FOR PERMITTING	10/15/2003

**Loiederman Soltesz Associates, Inc.**

10000 GAITHERSBURG ROAD, SUITE 100, GAITHERSBURG, MD 20878  
 TEL: 301-948-1000 FAX: 301-948-1001  
 WWW.LSASOCIATES.COM