

Item # 12



MONTGOMERY COUNTY DEPARTMENT OF PARK AND PLANNING

THE MARYLAND-NATIONAL CAPITAL  
PARK AND PLANNING COMMISSION

8787 Georgia Avenue  
Silver Spring, Maryland 20910-3760

M E M O R A N D U M

DATE: May 21, 2004  
TO: Montgomery County Planning Board  
FROM: Richard Weaver  
Development Review Division  
(301) 495-4544  
SUBJECT: Informational Maps for Subdivision Items on the  
Planning Board's Agenda for May 27, 2004.

---

Attached are copies of plan drawings for Items #06 #08, and #12. These subdivision items are scheduled for Planning Board consideration on May 27, 2004. The items are further identified as follows:

Agenda Item #06 Preliminary Plan 1-04047  
Buckingham Terrace

Agenda Item #08 Preliminary Plan 1-04078  
Chevy Chase, Section 1-A

Agenda Item #12 Preliminary Plan 1-01039A  
White Flint Place

Attachment

# WHITE FLINT PLACE (1-01039A)



Map compiled on May 21, 2004 at 10:09 AM | Site located on base sheet no - 215NW05

## NOTICE

The planimetric, property, and topographic information shown on this map is based on copyrighted Map Products from the Montgomery County Department of Park and Planning of the Maryland-National Capital Park and Planning Commission, and may not be copied or reproduced without written permission from M-NCPPC.

Property lines are compiled by adjusting the property lines to topography created from aerial photography and should not be interpreted as actual field surveys. Planimetric features were compiled from 1:14400 scale aerial photography using stereo photogrammetric methods.

This map is created from a variety of data sources, and may not reflect the most current conditions in any one location and may not be completely accurate or up to date. All map features are approximately within five feet of their true location. This map may not be the same as a map of the same area plotted at an earlier time as the data is continuously updated. Use of this map, other than for general planning purposes is not recommended. - Copyright 1998

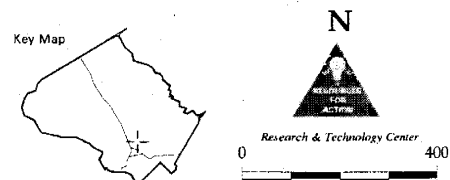

# WHITE FLINT PLACE (1-01039A)

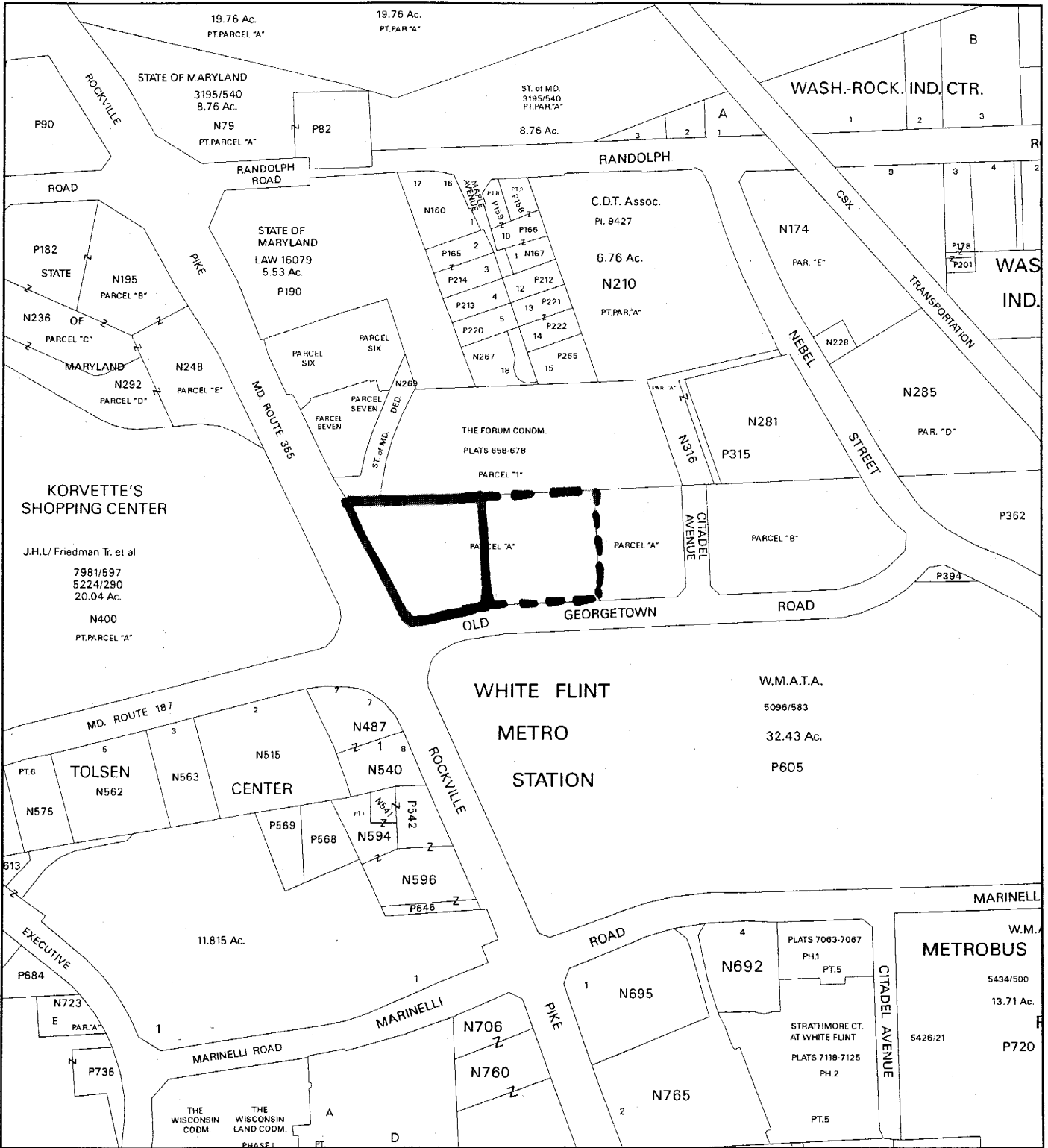

**NOTICE**

The planimetric, property, and topographic information shown on this map is based on copyrighted Map Products from the Montgomery County Department of Park and Planning of the Maryland-National Capital Park and Planning Commission, and may not be copied or reproduced without written permission from M-NCPPC.

Property lines are compiled by adjusting the property lines to topography created from aerial photography and should not be interpreted as actual field surveys. Planimetric features were compiled from 1:14400 scale aerial photography using stereo photogrammetric methods.

This map is created from a variety of data sources, and may not reflect the most current conditions in any one location and may not be completely accurate or up to date. All map features are approximately within five feet of their true location. This map may not be the same as a map of the same area plotted at an earlier time as the data is continuously updated. Use of this map, other than for general planning purposes is not recommended. - Copyright 1998

