

PRELIMINARY PLAN 1-01064  
Not to Scale

OWNER/DEVELOPER:  
SOUTHWIND PROPERTIES, L.L.C.  
19127 BROOK DRIVE  
BELTSVILLE, MARYLAND 20704  
PHONE: (301) 800-8683  
CONTACT PERSON: MR. DAVID ARAS

No.	REVISION	DATE	BY

**GREENHORNE & O'MARA, INC.**  
GENERAL CIVIL  
TRANSPORTATION  
ENVIRONMENTAL  
GEOGRAPHIC SCIENCES  
PHON

FLORIDA • GEORGIA • ILLINOIS

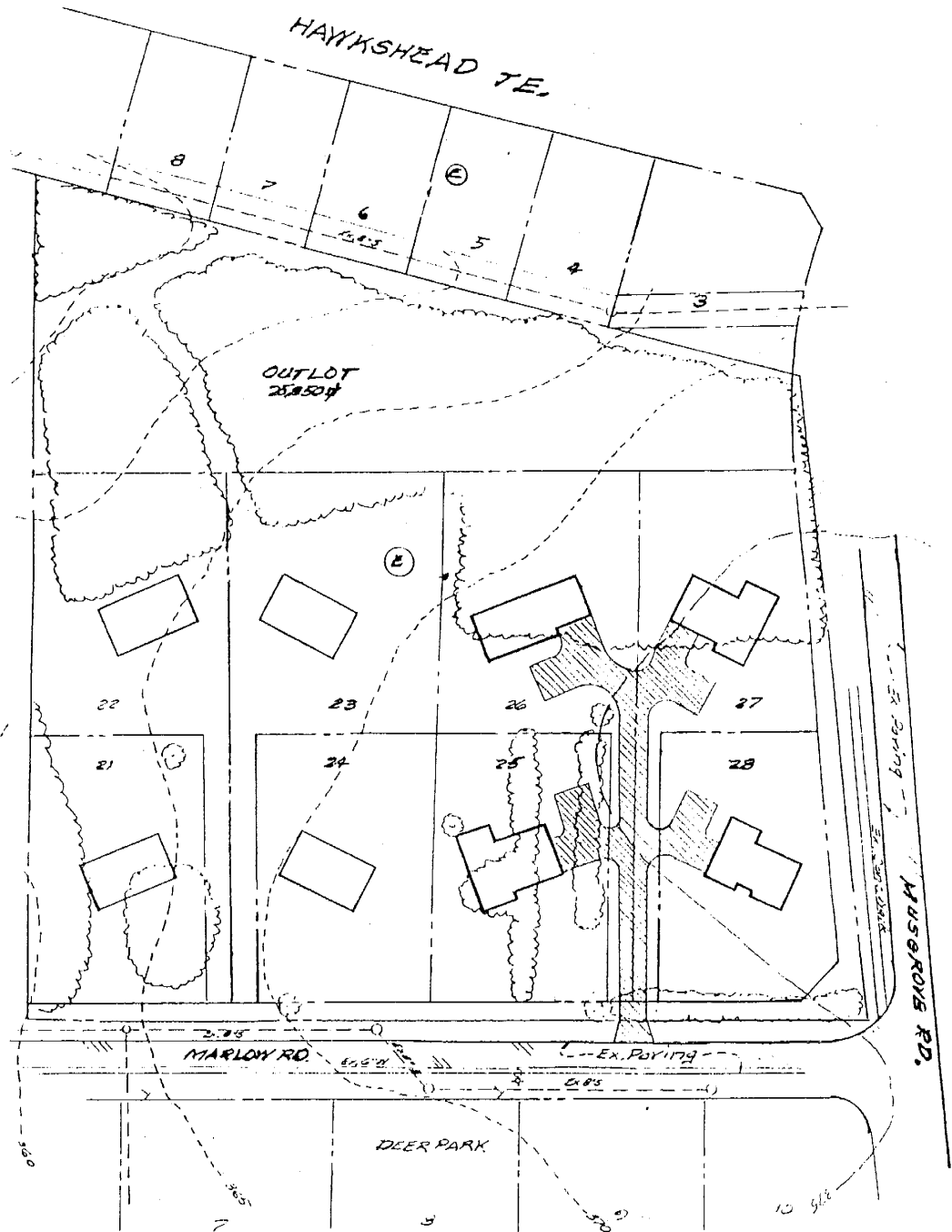

**GENERAL NOTES**

1. Property zoned R-90
2. Lot size - 15,000 sf +
3. Water and sewer by W.S.S.C.
4. Existing detail from plan by others
5. Subdivision to blend in with existing development - no paving, curb and gutter, or sidewalk
6. Sales price - \$600,000 +

Proposed Subdivision  
 Parcel 750  
 DEER PARK  
 Montgomery County, Maryland  
 August 2003



Location of Signatures  
 Petition Preliminary plan I-01064  
 Deer Park

v Indicates Signature