

Item #3

M-NCPPC

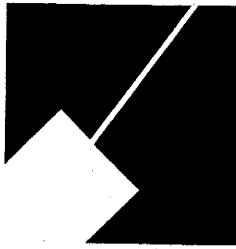

MONTGOMERY COUNTY DEPARTMENT OF PARK AND PLANNING

THE MARYLAND-NATIONAL CAPITAL
PARK AND PLANNING COMMISSION

8787 Georgia Avenue
Silver Spring, Maryland 20910-3760
301-495-4500, www.mncppc.org

MEMORANDUM

DATE: October 29, 2004
TO: Montgomery County Planning Board
FROM: Catherine Conlon
Development Review Division
(301) 495-4542
SUBJECT: Informational Maps for Subdivision Items on the
Planning Board's Agenda for November 04, 2004.

Attached are copies of plan drawings for item #03, #04, #05, #06, and #07. These subdivision items are scheduled for Planning Board consideration on November 04, 2004. The items are further identified as follows:

Agenda Item #03 - Preliminary Plan 1-04104
Cambodian Buddhist Temple

Agenda Item #04 - Preliminary Plan 1-99043B
Fishers Place

Agenda Item #05 - Preliminary Plan 1-97098
Thompson Farm

Agenda Item #06 - Preliminary Plan 1-02096R
Howard Hughes Medical Institute

Agenda Item #07 - Preliminary Plan 1-04068
Leesborough

Attachment

CAMBODIAN BUDDHIST TEMPLE (1-04104)

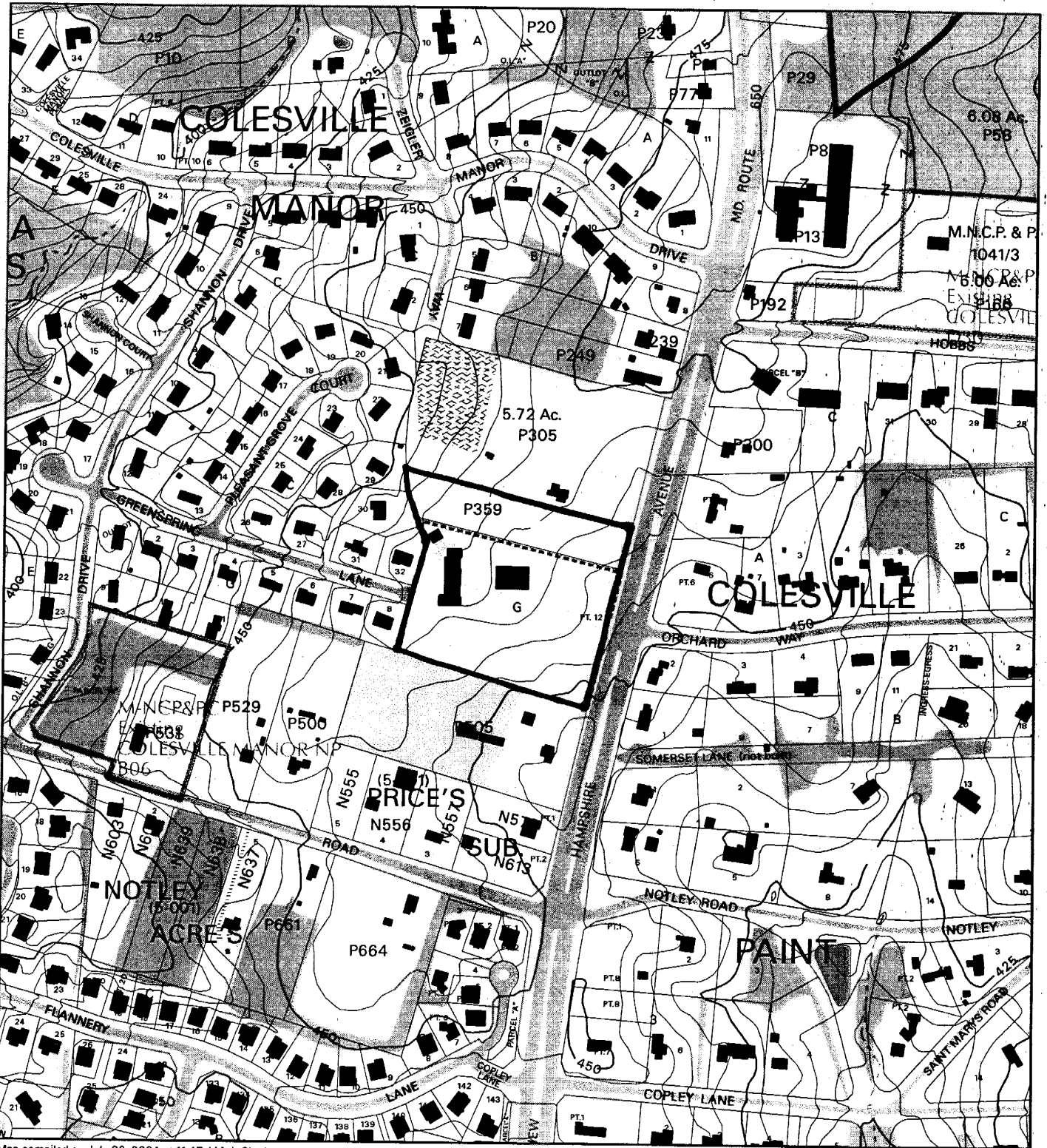

Map compiled on July 06, 2004 at 11:47 AM | Site located on base sheet no - 218NE01

NOTICE

The planimetric, property, and topographic information shown on this map is based on copyrighted Map Products from the Montgomery County Department of Park and Planning of the Maryland-National Capital Park and Planning Commission, and may not be copied or reproduced without written permission from M-NCPPC.

Property lines are compiled by adjusting the property lines to topography created from aerial photography and should not be interpreted as actual field surveys. Planimetric features were compiled from 1:14400 scale aerial photography using stereo photogrammetric methods.

This map is created from a variety of data sources, and may not reflect the most current conditions in any one location and may not be completely accurate or up to date. All map features are approximately within five feet of their true location. This map may not be the same as a map of the same area plotted at an earlier time as the data is continuously updated. Use of this map, other than for general planning purposes is not recommended. - Copyright 1998

Key Map

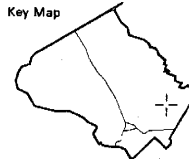

N



Research & Technology Center

0 400

1 inch = 400 feet
1 : 4800

CAMBODIAN BUDDHIST TEMPLE (1-04104)

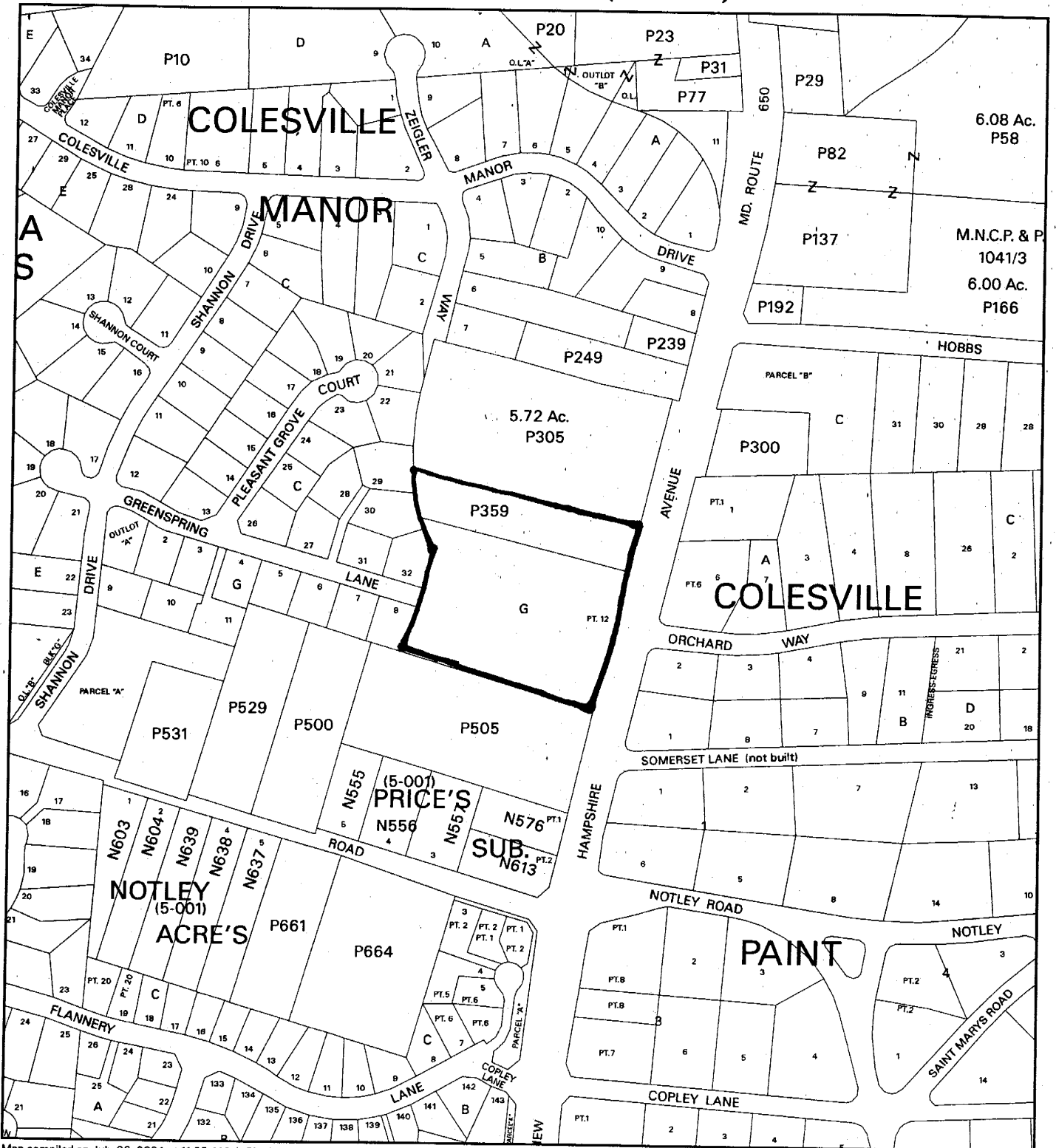

Map compiled on July 06, 2004 at 11:55 AM | Site located on base sheet no - 218NE01

NOTICE

The planimetric, property, and topographic information shown on this map is based on copyrighted Map Products from the Montgomery County Department of Park and Planning of the Maryland-National Capital Park and Planning Commission, and may not be copied or reproduced without written permission from M-NCPPC.

Property lines are compiled by adjusting the property lines to topography created from aerial photography and should not be interpreted as actual field surveys. Planimetric features were compiled from 1:14400 scale aerial photography using stereo photogrammetric methods.

This map is created from a variety of data sources, and may not reflect the most current conditions in any one location and may not be completely accurate or up to date. All map features are approximately within five feet of their true location. This map may not be the same as a map of the same area plotted at an earlier time as the data is continuously updated. Use of this map, other than for general planning purposes is not recommended. - Copyright 1998

MONTGOMERY COUNTY DEPARTMENT OF PARK AND PLANNING
 THE MARYLAND-NATIONAL CAPITAL PARK AND PLANNING COMMISSION
 8787 Georgia Avenue - Silver Spring, Maryland 20910-3760

Key Map

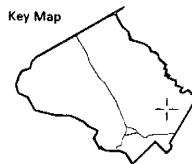

N



Research & Technology Center



1 inch = 400 feet
 1 : 4800

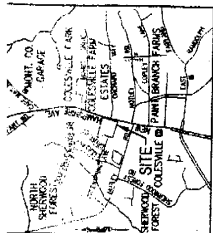

GENERAL NOTES

1. SITE PLAN DATED FEBRUARY, 2004
2. 2004DC-15-1003, PARCEL #359
3. TAX MAP #33, PARCEL #359
4. METRIC/US 12/44/77
5. 10' SETBACK
6. 5' SIDE SETBACK
7. MONT. CO. STREET MAP PAGE 31, ORD. E-4, 7
8. TOTAL LOT AREA = 20,000 SF
9. TOTAL WETLAND AREA = 0.00 AC
10. TOTAL PAVED AREA = 20,000 SF
11. PROPOSED LOTS
12. PROPOSED NUMBER OF LOTS
13. FOR PUBLIC WATER AND SEWER SYSTEM
14. 10' AND 5' SETBACKS FROM ADJACENT PROPERTIES
15. SEE CLASSIFICATION B AND C
16. 10' AND 5' SETBACKS FROM ADJACENT PROPERTIES
17. RATE MAP COMMENTARY PAR. 4, SECTION 200.5
18. SETBACK
19. SEE REAR 30'
20. STORMWATER MANAGEMENT CONCEPT APPROVAL
21. THERE ARE NO CHANGES IN THIS SUBMISSION
22. THERE IS NO STREAM WITHIN 500' FROM THE PROPERTY.

SEQUENCE OF CONSTRUCTION

1. PRIOR TO CLEARING TREES, INSTALLING SEDIMENT CONTROL MEASURES
2. THE CONTRACTOR SHALL OBTAIN WRITTEN APPROVAL FROM THE MONTGOMERY COUNTY DEPARTMENT OF PUBLIC WORKS AND STREET ENGINEERING (DPWSE) FOR THE INSTALLATION OF SEDIMENT CONTROL MEASURES
3. THE CONTRACTOR SHALL OBTAIN WRITTEN APPROVAL FROM THE MONTGOMERY COUNTY DEPARTMENT OF PUBLIC WORKS AND STREET ENGINEERING (DPWSE) FOR THE INSTALLATION OF SEDIMENT CONTROL MEASURES
4. AFTER FINISHING CONSTRUCTION, STABILIZE THE ENTIRE SITE
5. UPON WRITTEN APPROVAL FROM DPWSE, THE CONTRACTOR SHALL REMOVE ALL SEDIMENT CONTROL MEASURES AND STABILIZE THE REMAINING SITE
6. START ROUGH GRADING OF ENTIRE SITE
7. START CONSTRUCTION OF ALL UTILITIES, APPROXIMATELY CONCRETE, SEWER, CHURCH AND OTHER MODELING UTILITIES
8. AFTER FINISHING CONSTRUCTION, STABILIZE THE ENTIRE SITE
9. UPON WRITTEN APPROVAL FROM DPWSE, THE CONTRACTOR SHALL REMOVE ALL SEDIMENT CONTROL MEASURES AND STABILIZE THE REMAINING SITE
10. DAYS
11. DAYS
12. DAYS
13. DAYS
14. DAYS
15. DAYS
16. DAYS
17. DAYS
18. DAYS
19. DAYS
20. DAYS

AB CONSULTANTS, INC.
4800 ANNAPOLIS ROAD
SILVER SPRING, MARYLAND 20910
PHONE: (301) 306-3006
FAX: (301) 306-3002
CONTACT: SAMANTHA PATE
PHONE: 301-306-3011 x 220

OWNER/APPLICANT
CAMBODIAN BUDDHIST SOCIETY INC.
13800 NEW HAMPSHIRE AVENUE
SILVER SPRING, MARYLAND
41TH FLOOR
209-342-2200

PROJECT
CAMBODIAN BUDDHIST TEMPLE
13800 NEW HAMPSHIRE AVENUE
SILVER SPRING
MONTGOMERY COUNTY, MARYLAND

PERMIT # 03-207
DATE 02/27/04
PROJECT # 03-207
ISSUED BY SP

