

G-826 - VICINITY MAP



Map compiled on January 21, 2005 at 3:42 PM | Site located on base sheet no - 212NE02

NOTICE

The planimetric, property, and topographic information shown on this map is based on copyrighted Map Products from the Montgomery County Department of Park and Planning of the Maryland-National Capital Park and Planning Commission, and may not be copied or reproduced without written permission from M-NCPPC.

Property lines are compiled by adjusting the property lines to topography created from aerial photography and should not be interpreted as actual field surveys. Planimetric features were compiled from 1:14400 scale aerial photography using stereo photogrammetric methods.

This map is created from a variety of data sources, and may not reflect the most current conditions in any one location and may not be completely accurate or up to date. All map features are approximately within five feet of their true location. This map may not be the same as a map of the same area plotted at an earlier time as the data is continuously updated. Use of this map, other than for general planning purposes is not recommended. - Copyright 1998

Key Map

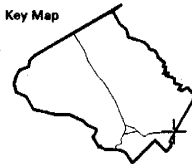

N



Research & Technology Center



1 inch = 600 feet
1 : 7200

MONTGOMERY COUNTY DEPARTMENT OF PARK AND PLANNING
THE MARYLAND-NATIONAL CAPITAL PARK AND PLANNING COMMISSION

6787 Georgia Avenue - Silver Spring, Maryland 20910-3760

ZONING MAP

2.12NE02
KPI22

NOTES CONCERNING ZONING IN ROUTE-67-WAY
 1. The zoning map of the State of Maryland is subject to change. Any change in zoning shall be made by the State Planning Board. The zoning map of the State of Maryland is subject to change. Any change in zoning shall be made by the State Planning Board.

Department of Transportation
 2014
 2015
 2016
 2017
 2018
 2019
 2020
 2021
 2022
 2023
 2024
 2025

Department of Transportation
 2014
 2015
 2016
 2017
 2018
 2019
 2020
 2021
 2022
 2023
 2024
 2025

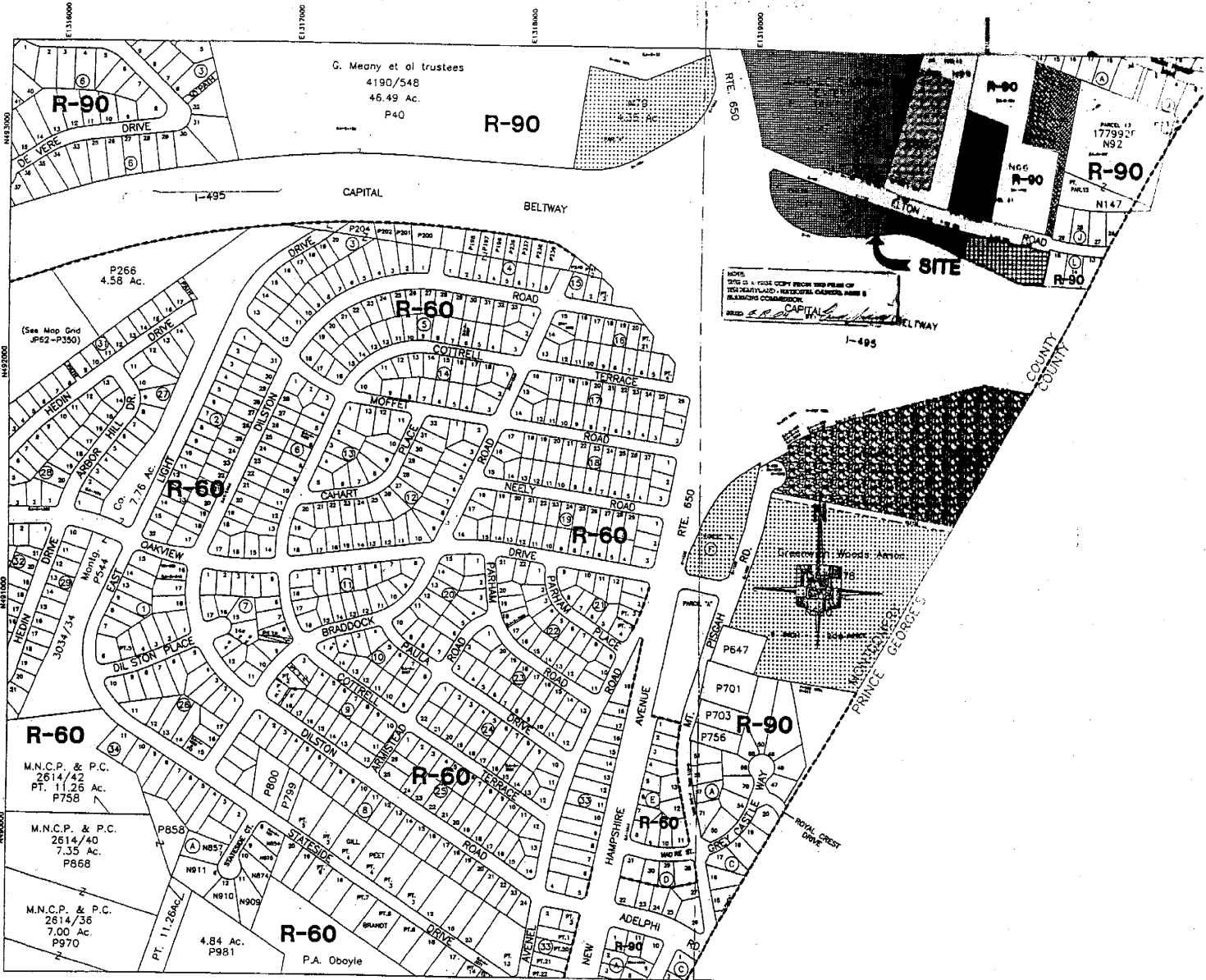

Montgomery County Zoning Map

The Maryland National Capital Park and Planning Commission

Montgomery County Zoning