

PROPOSED LOCAL PARKS FOR PILOT PROGRAM

The following parks are proposed based on several factors: Park Police calls for assistance, heavy permitted and non-permitted use, proximity to homes and other problematic parks, and community complaints about noise, parking, and behavior that violated park rules.

Although Ray's Meadow Local Park has experienced more problems, the fields at Meadowbrook Local Park are also being recommended for inclusion in the pilot because of their proximity to Ray's Meadow LP. This criteria of proximity also applies to Randolph Hills, Dewey and Winding Creek Local Parks.

Two of the parks – Jesup Blair (due to open in 2005) and Winding Creek (due to open in 2006-07) - have been heavily used in the past by adult soccer players. They are being considered for the pilot as an opportunity to make users aware of the new initiatives for successful local park usage.

Bullis Local Park

8501 Houston Street, Silver Spring, MD 20910

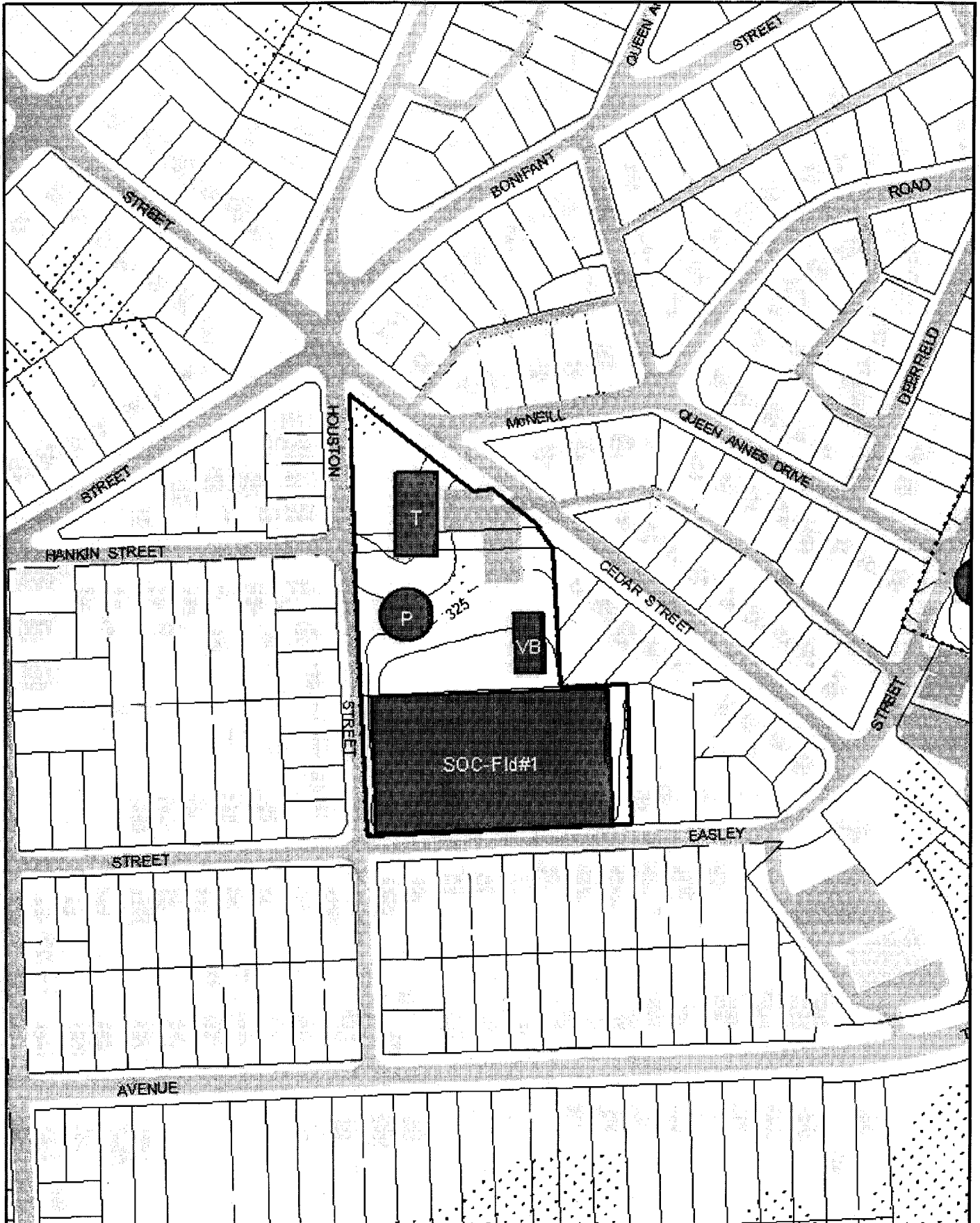

M-HCP/PC  Acreage 4.0
Facility Code E57

Region S
Area MB

Date 7/10/2002



Capitol View - Homewood Local Park

2929 Edgewood Road, Kensington, MD 20895

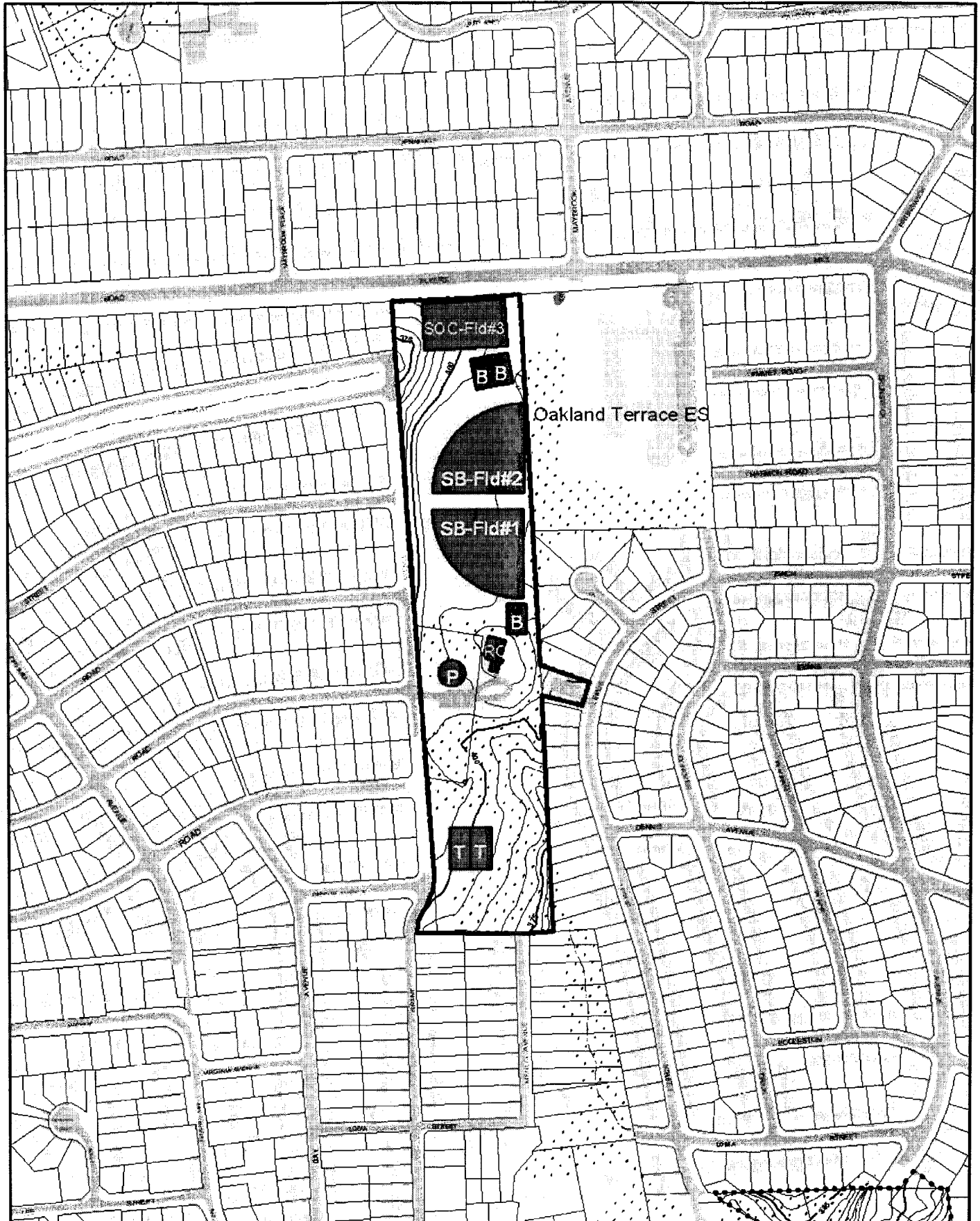

M-NCPPC  Acreage 15.4
Facility Code D21

Region S
Area MB

Date 8/08/2002



Dewey Local Park

11720 Dewey Road, Viers Mill, MD 20906

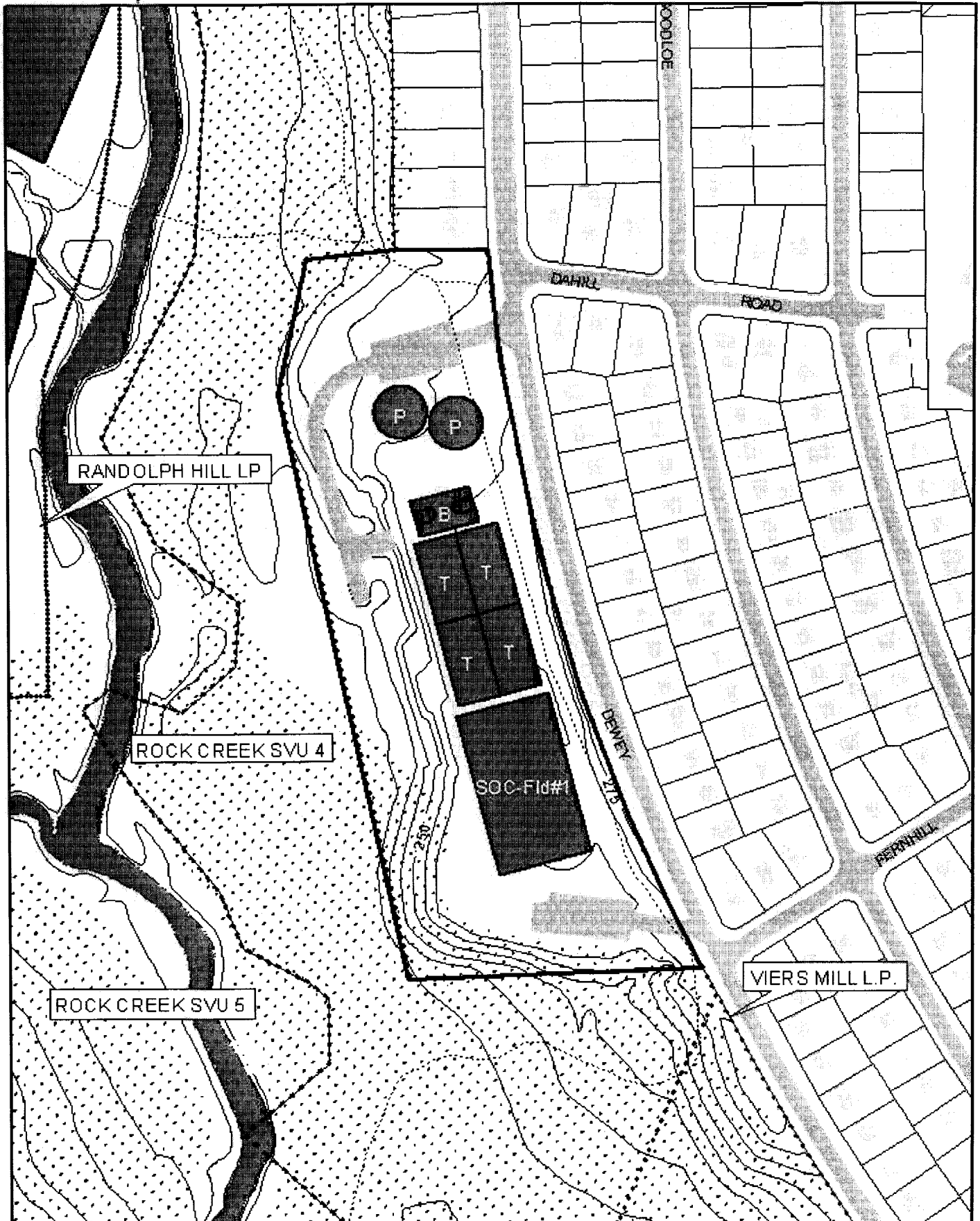

MANEPPC

Acreage 14.5
Facility Code D32

Region S
Area MB

Date 7/10/2002



1" = 200'

Jesup - Blair Local Park

900 Jesup Blair Drive, Georgia Avenue, and D.C. Line, Silver Spring, MD 20912

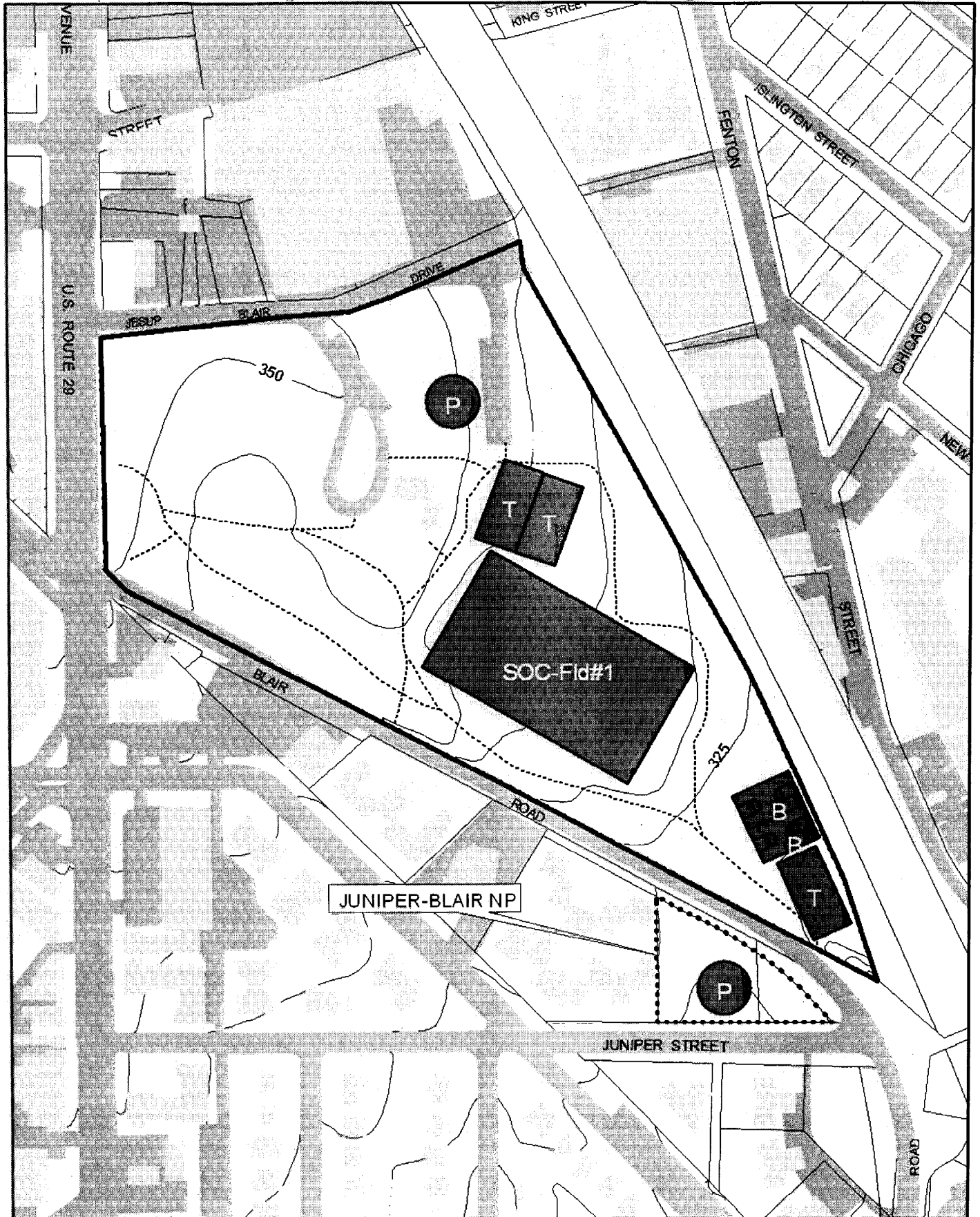

M-NCPPC  Acreage 15.1
 Facility Code D56

Region S
 Area MB

Date 7/15/2002

Long Branch - Wayne Local Park

509 East University Boulevard, Silver Spring, MD 20901

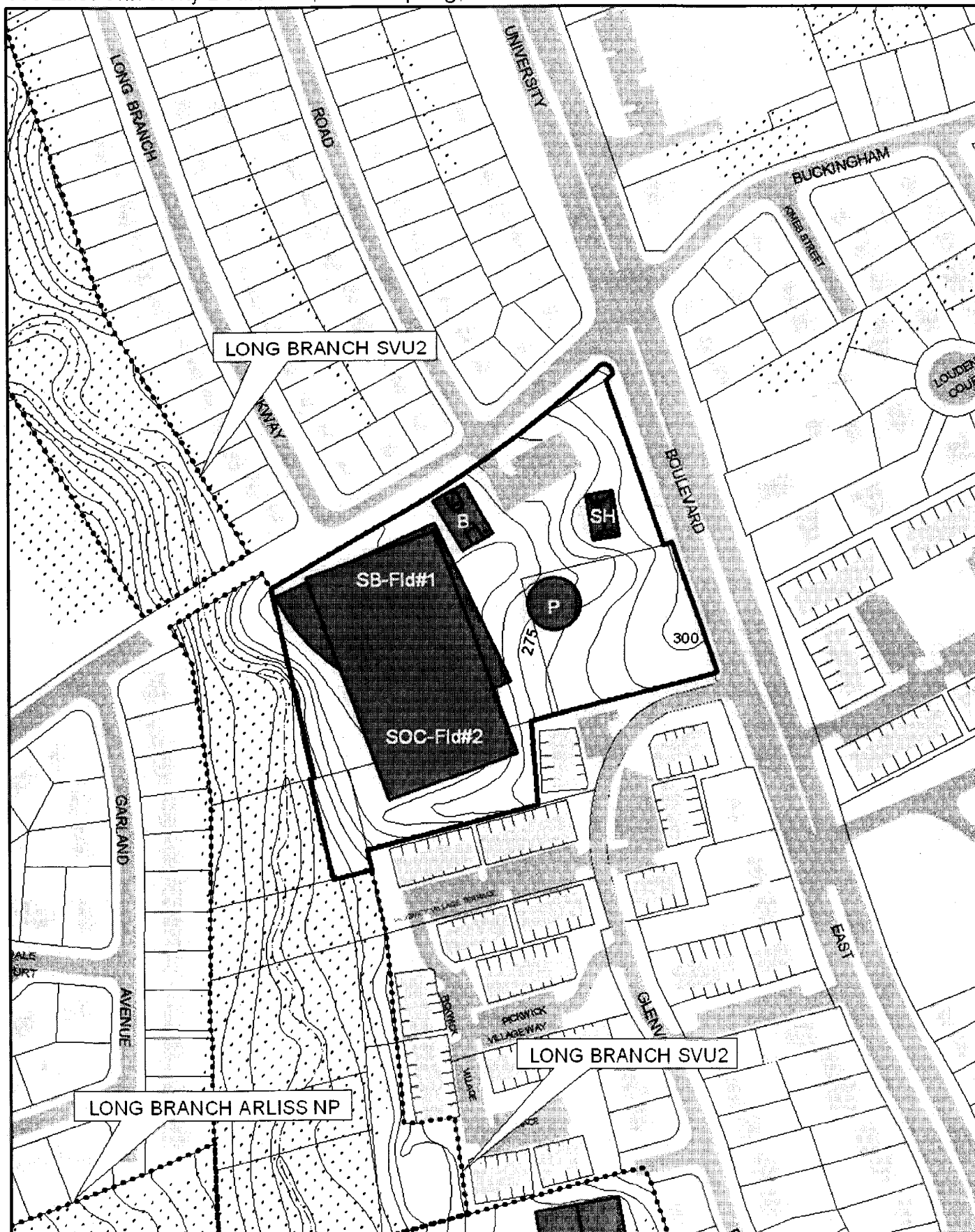

M-NCPPC

Acreage 6.1

Region S

Facility Code D66

Area MB

Date 7/17/2002

