

S-2070-A JOHNSON NURSERY

Neighborhood Area

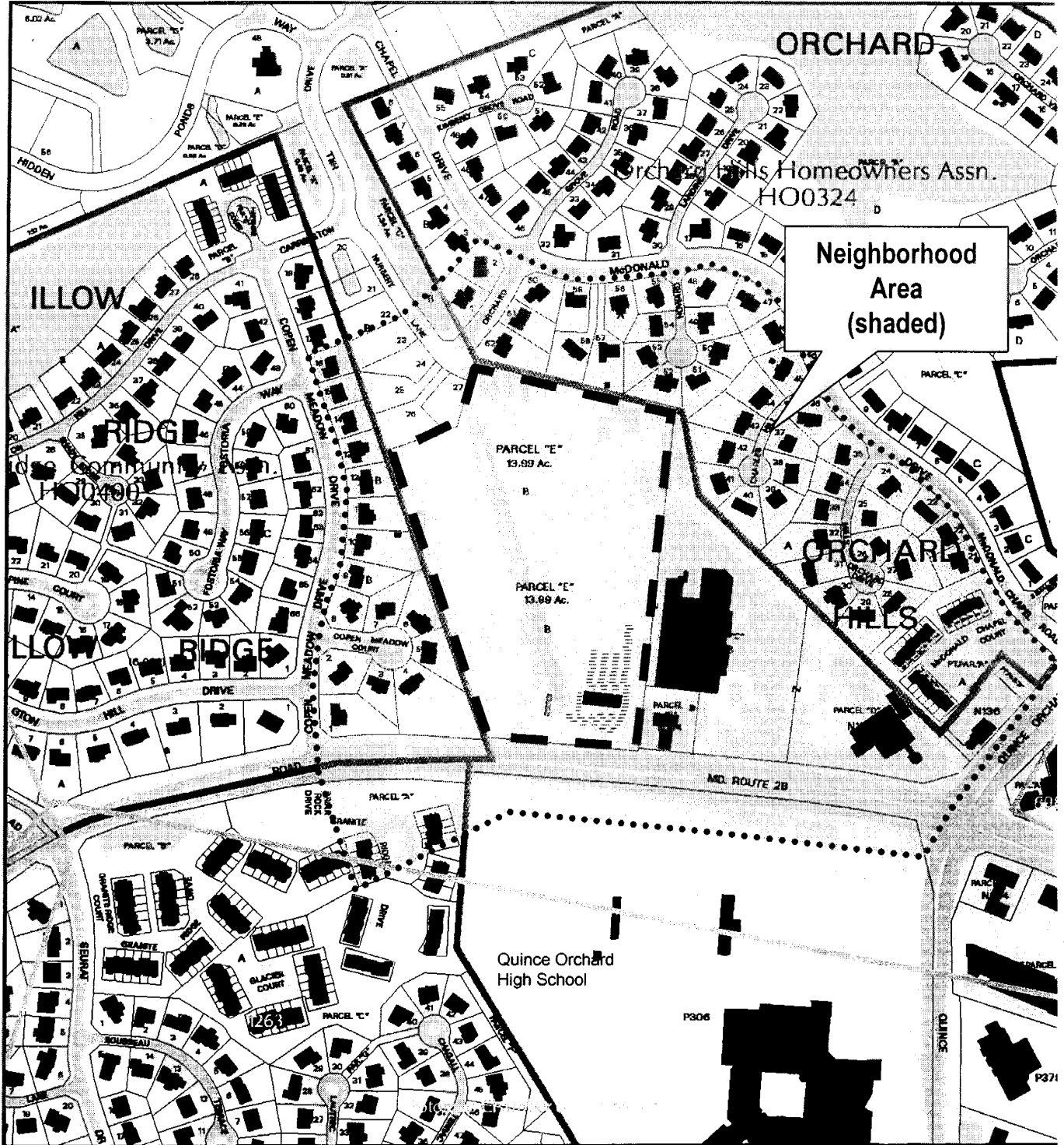

Map compiled on June 07, 2005 at 12:38 PM | Site located on base sheet no - 221NW12

**NOTICE**

The planimetric, property, and topographic information shown on this map is based on copyrighted Map Products from the Montgomery County Department of Park and Planning of the Maryland-National Capital Park and Planning Commission, and may not be copied or reproduced without written permission from M-NCPPC.

Property lines are compiled by adjusting the property lines to topography created from aerial photography and should not be interpreted as actual field surveys. Planimetric features were compiled from 1:14400 scale aerial photography using stereo photogrammetric methods.

This map is created from a variety of data sources, and may not reflect the most current conditions in any one location and may not be completely accurate or up to date. All map features are approximately within five feet of their true location. This map may not be the same as a map of the same area plotted at an earlier time as the data is continuously updated. Use of this map, other than for general planning purposes is not recommended. - Copyright 1998

Key Map



N



Research & Technology Center



1 inch = 400 feet  
1 : 4800

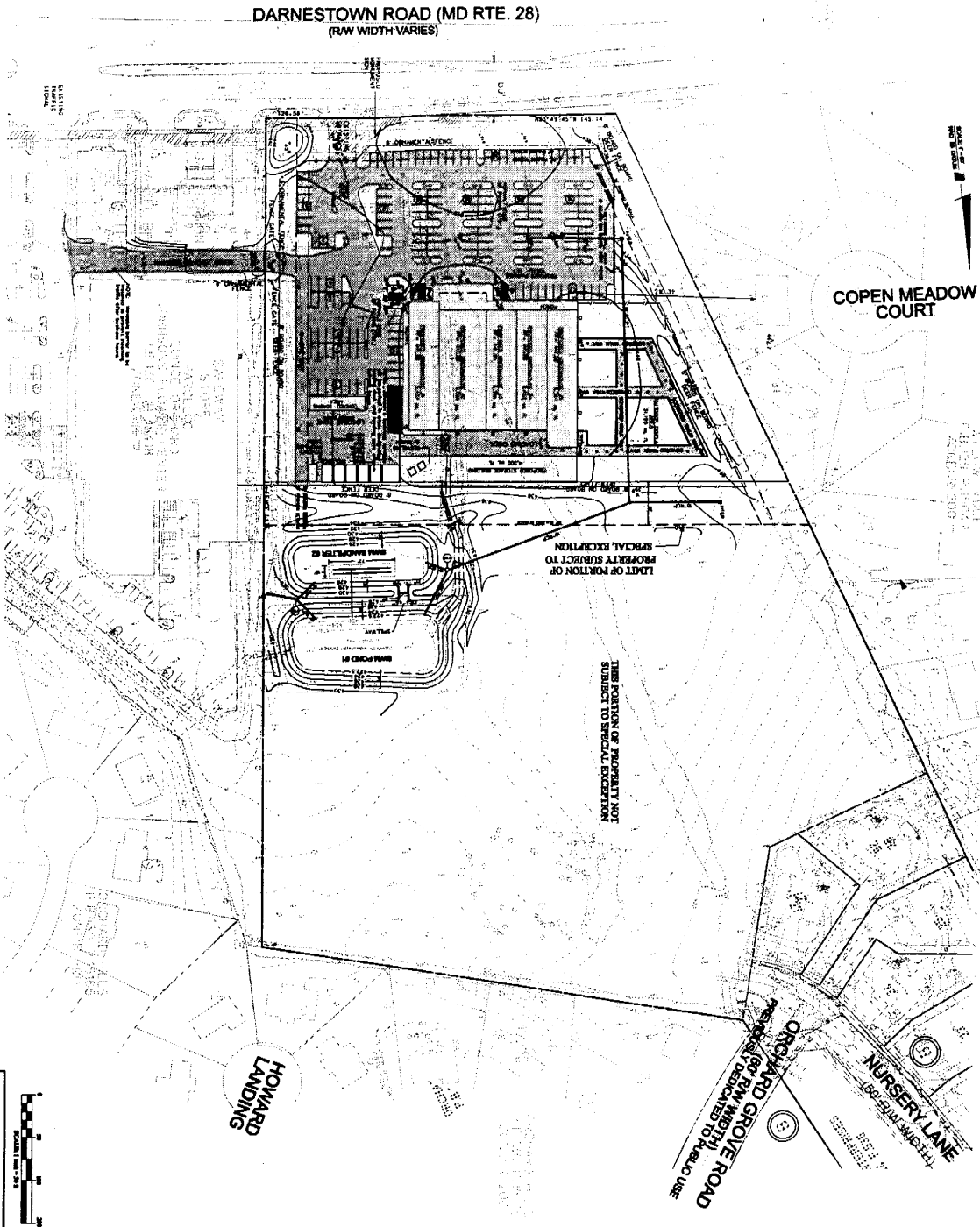

**ES**  
 Environmental Services, Inc.  
 1300 Potomac Lane, Suite 101  
 Washington, MD 20007  
 (301) 484-2770

NO.	DATE	DESCRIPTION
1	08/12/08	PRELIMINARY
2	08/12/08	REVISED
3	08/12/08	REVISED
4	08/12/08	REVISED
5	08/12/08	REVISED
6	08/12/08	REVISED
7	08/12/08	REVISED
8	08/12/08	REVISED
9	08/12/08	REVISED
10	08/12/08	REVISED
11	08/12/08	REVISED
12	08/12/08	REVISED
13	08/12/08	REVISED
14	08/12/08	REVISED
15	08/12/08	REVISED
16	08/12/08	REVISED
17	08/12/08	REVISED
18	08/12/08	REVISED
19	08/12/08	REVISED
20	08/12/08	REVISED
21	08/12/08	REVISED
22	08/12/08	REVISED
23	08/12/08	REVISED
24	08/12/08	REVISED
25	08/12/08	REVISED
26	08/12/08	REVISED
27	08/12/08	REVISED
28	08/12/08	REVISED
29	08/12/08	REVISED
30	08/12/08	REVISED
31	08/12/08	REVISED
32	08/12/08	REVISED
33	08/12/08	REVISED
34	08/12/08	REVISED
35	08/12/08	REVISED
36	08/12/08	REVISED
37	08/12/08	REVISED
38	08/12/08	REVISED
39	08/12/08	REVISED
40	08/12/08	REVISED
41	08/12/08	REVISED
42	08/12/08	REVISED
43	08/12/08	REVISED
44	08/12/08	REVISED
45	08/12/08	REVISED
46	08/12/08	REVISED
47	08/12/08	REVISED
48	08/12/08	REVISED
49	08/12/08	REVISED
50	08/12/08	REVISED

**OWNER / DEVELOPER**  
 Johnson's Flower & Garden Center  
 10313 Kensington Parkway #205  
 Kensington, MD 20885  
 (301) 946-6704

**MISS UTILITY NOTE**  
 THE MISS UTILITY NOTE IS A STATEMENT OF THE DESIGNER'S BELIEF THAT THE UTILITY LOCATIONS SHOWN ON THIS PLAN ARE ACCURATE. THE DESIGNER HAS CONDUCTED VISUAL INSPECTIONS AND HAS BEEN ADVISED BY THE UTILITY COMPANIES THAT THE UTILITY LOCATIONS SHOWN ON THIS PLAN ARE ACCURATE. THE DESIGNER HAS CONDUCTED VISUAL INSPECTIONS AND HAS BEEN ADVISED BY THE UTILITY COMPANIES THAT THE UTILITY LOCATIONS SHOWN ON THIS PLAN ARE ACCURATE. THE DESIGNER HAS CONDUCTED VISUAL INSPECTIONS AND HAS BEEN ADVISED BY THE UTILITY COMPANIES THAT THE UTILITY LOCATIONS SHOWN ON THIS PLAN ARE ACCURATE.

**SPECIAL EXCEPTION SITE PLAN**  
**JOHNSON'S FLOWER AND GARDEN CENTER**  
 46 DARNESTOWN SECTION DISTRICT  
 MONTGOMERY COUNTY, MARYLAND

1. The site is located within the Special Exception District No. 10-1-1.
2. The site is located within the Special Exception District No. 10-1-1.
3. The site is located within the Special Exception District No. 10-1-1.
4. The site is located within the Special Exception District No. 10-1-1.
5. The site is located within the Special Exception District No. 10-1-1.
6. The site is located within the Special Exception District No. 10-1-1.
7. The site is located within the Special Exception District No. 10-1-1.
8. The site is located within the Special Exception District No. 10-1-1.
9. The site is located within the Special Exception District No. 10-1-1.
10. The site is located within the Special Exception District No. 10-1-1.
11. The site is located within the Special Exception District No. 10-1-1.
12. The site is located within the Special Exception District No. 10-1-1.
13. The site is located within the Special Exception District No. 10-1-1.
14. The site is located within the Special Exception District No. 10-1-1.
15. The site is located within the Special Exception District No. 10-1-1.
16. The site is located within the Special Exception District No. 10-1-1.
17. The site is located within the Special Exception District No. 10-1-1.
18. The site is located within the Special Exception District No. 10-1-1.
19. The site is located within the Special Exception District No. 10-1-1.
20. The site is located within the Special Exception District No. 10-1-1.
21. The site is located within the Special Exception District No. 10-1-1.
22. The site is located within the Special Exception District No. 10-1-1.
23. The site is located within the Special Exception District No. 10-1-1.
24. The site is located within the Special Exception District No. 10-1-1.
25. The site is located within the Special Exception District No. 10-1-1.
26. The site is located within the Special Exception District No. 10-1-1.
27. The site is located within the Special Exception District No. 10-1-1.
28. The site is located within the Special Exception District No. 10-1-1.
29. The site is located within the Special Exception District No. 10-1-1.
30. The site is located within the Special Exception District No. 10-1-1.
31. The site is located within the Special Exception District No. 10-1-1.
32. The site is located within the Special Exception District No. 10-1-1.
33. The site is located within the Special Exception District No. 10-1-1.
34. The site is located within the Special Exception District No. 10-1-1.
35. The site is located within the Special Exception District No. 10-1-1.
36. The site is located within the Special Exception District No. 10-1-1.
37. The site is located within the Special Exception District No. 10-1-1.
38. The site is located within the Special Exception District No. 10-1-1.
39. The site is located within the Special Exception District No. 10-1-1.
40. The site is located within the Special Exception District No. 10-1-1.
41. The site is located within the Special Exception District No. 10-1-1.
42. The site is located within the Special Exception District No. 10-1-1.
43. The site is located within the Special Exception District No. 10-1-1.
44. The site is located within the Special Exception District No. 10-1-1.
45. The site is located within the Special Exception District No. 10-1-1.
46. The site is located within the Special Exception District No. 10-1-1.
47. The site is located within the Special Exception District No. 10-1-1.
48. The site is located within the Special Exception District No. 10-1-1.
49. The site is located within the Special Exception District No. 10-1-1.
50. The site is located within the Special Exception District No. 10-1-1.

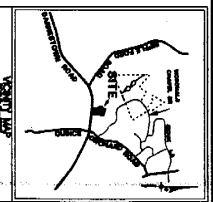

LE Landscape Architecture, Inc.  
 10000 Greenway Drive, Suite 100  
 Rockville, MD 20850  
 Tel: 301.582.2700 Fax: 301.582.2700

DATE	DESCRIPTION
1/15/11	CONCEPT PLAN
2/15/11	SCHEMATIC DESIGN
3/15/11	LANDSCAPE ARCHITECTURE
4/15/11	CONSTRUCTION DOCUMENTS

**OWNER / DEVELOPER**  
 Johnson's Flower & Garden Center  
 10315 Kensington Parkway #205  
 Kensington, MD 20895  
 (301) 946-6704

THIS PLAN IS THE PROPERTY OF LE LANDSCAPE ARCHITECTURE, INC. AND IS NOT TO BE REPRODUCED OR TRANSMITTED IN ANY FORM OR BY ANY MEANS, ELECTRONIC OR MECHANICAL, INCLUDING PHOTOCOPYING, RECORDING, OR BY ANY INFORMATION STORAGE AND RETRIEVAL SYSTEM, WITHOUT THE WRITTEN PERMISSION OF LE LANDSCAPE ARCHITECTURE, INC.

**LANDSCAPE & LIGHTING PLAN**  
**JOHNSON'S FLOWER AND GARDEN CENTER**  
 648 DARNESTOWN ELECTION DISTRICT  
 MONTGOMERY COUNTY, MARYLAND

