

Item # 8

M-NCPPC

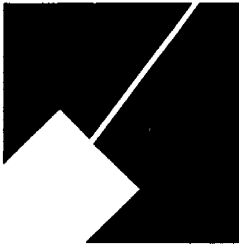

MONTGOMERY COUNTY DEPARTMENT OF PARK AND PLANNING

THE MARYLAND-NATIONAL CAPITAL
PARK AND PLANNING COMMISSION

8787 Georgia Avenue
Silver Spring, Maryland 20910-3760
301-495-4500, www.mncppc.org

M E M O R A N D U M

DATE: June 17, 2005

TO: Montgomery County Planning Board

FROM: Catherine Conlon
Development Review Division
(301) 495-4542

SUBJECT: Informational Maps for Subdivision Items on the
Planning Board's Agenda for June 23, 2005.

Attached are copies of plan drawings for item #08, #10, #11,
#12, and #13. These subdivision items are scheduled for Planning
Board consideration on June 23, 2005. The items are further
identified as follows:

Agenda Item #08 - Preliminary Plan 1-05077
Easley Subdivision "The Adele"

Agenda Item #10 - Pre-Preliminary Plan 7-05052
Great Meadows

Agenda Item #11 - Preliminary Plan 1-04092
Patton Property

Agenda Item #12 - Preliminary Plan 1-05039
Lutheran Church of St. Andrews

Agenda Item #13 - Preliminary Plan 1-02079A
FASEB (Locus Vitae)

Attachment

EASLEY SUBDIVISION "THE ADELE" (1-05077) (9-05003)

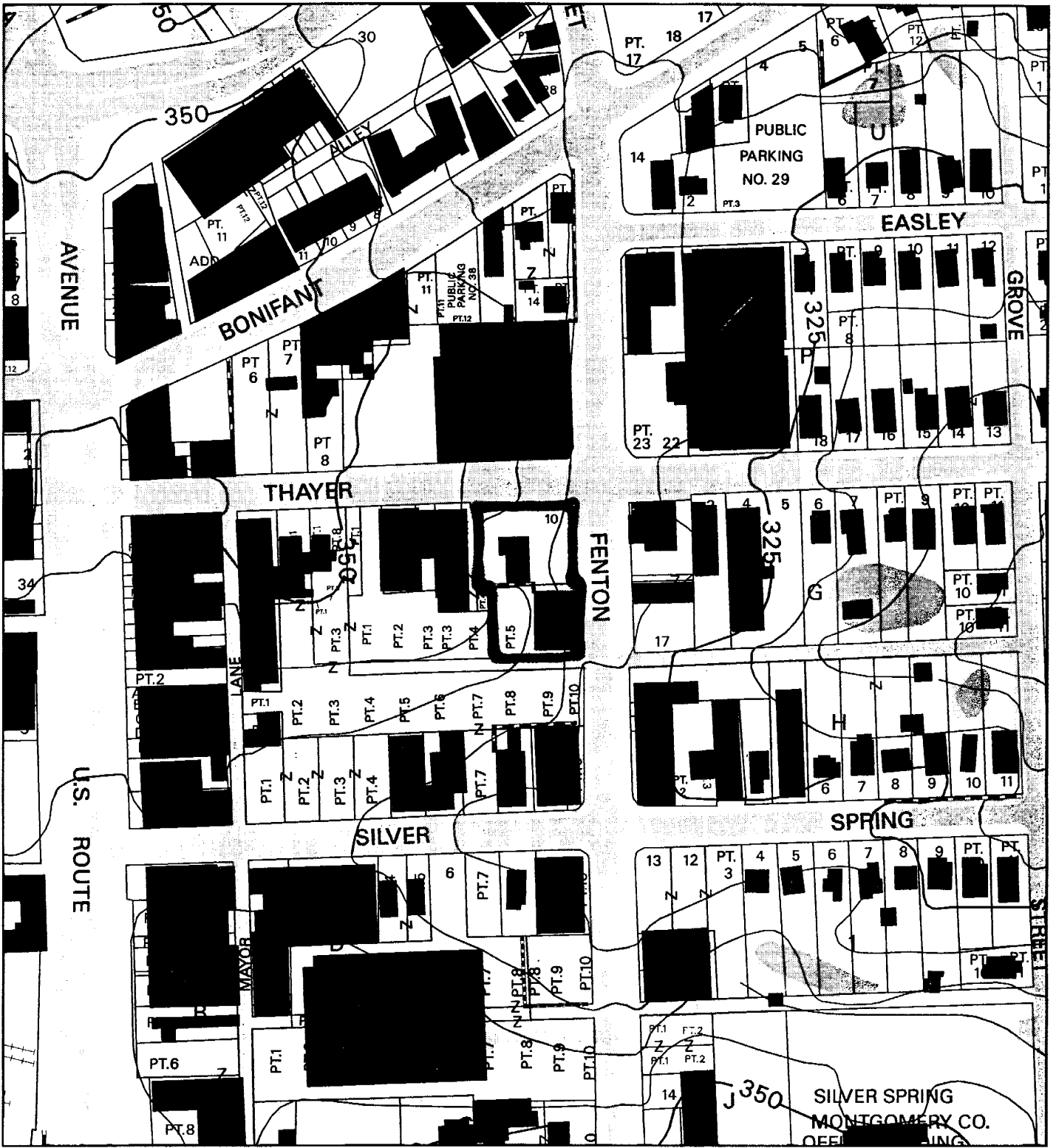

Map compiled on April 04, 2005 at 12:52 PM | Site located on base sheet no - 210NW01

NOTICE

The planimetric, property, and topographic information shown on this map is based on copyrighted Map Products from the Montgomery County Department of Park and Planning of the Maryland - National Capital Park and Planning Commission, and may not be copied or reproduced without written permission from M-NCPPC.

Property lines are compiled by adjusting the property lines to topography created from aerial photography and should not be interpreted as actual field surveys. Planimetric features were compiled from 1:14400 scale aerial photography using stereo photogrammetric methods.

This map is created from a variety of data sources, and may not reflect the most current conditions in any one location and may not be completely accurate or up to date. All map features are approximately within five feet of their true location. This map may not be the same as a map of the same area plotted at an earlier time as the data is continuously updated. Use of this map, other than for general planning purposes is not recommended. - Copyright 1998

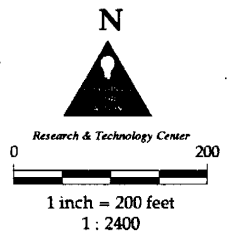
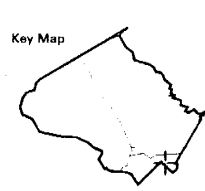

EASLEY SUBDIVISION "THE ADELE" (1-05077) (9-05003)

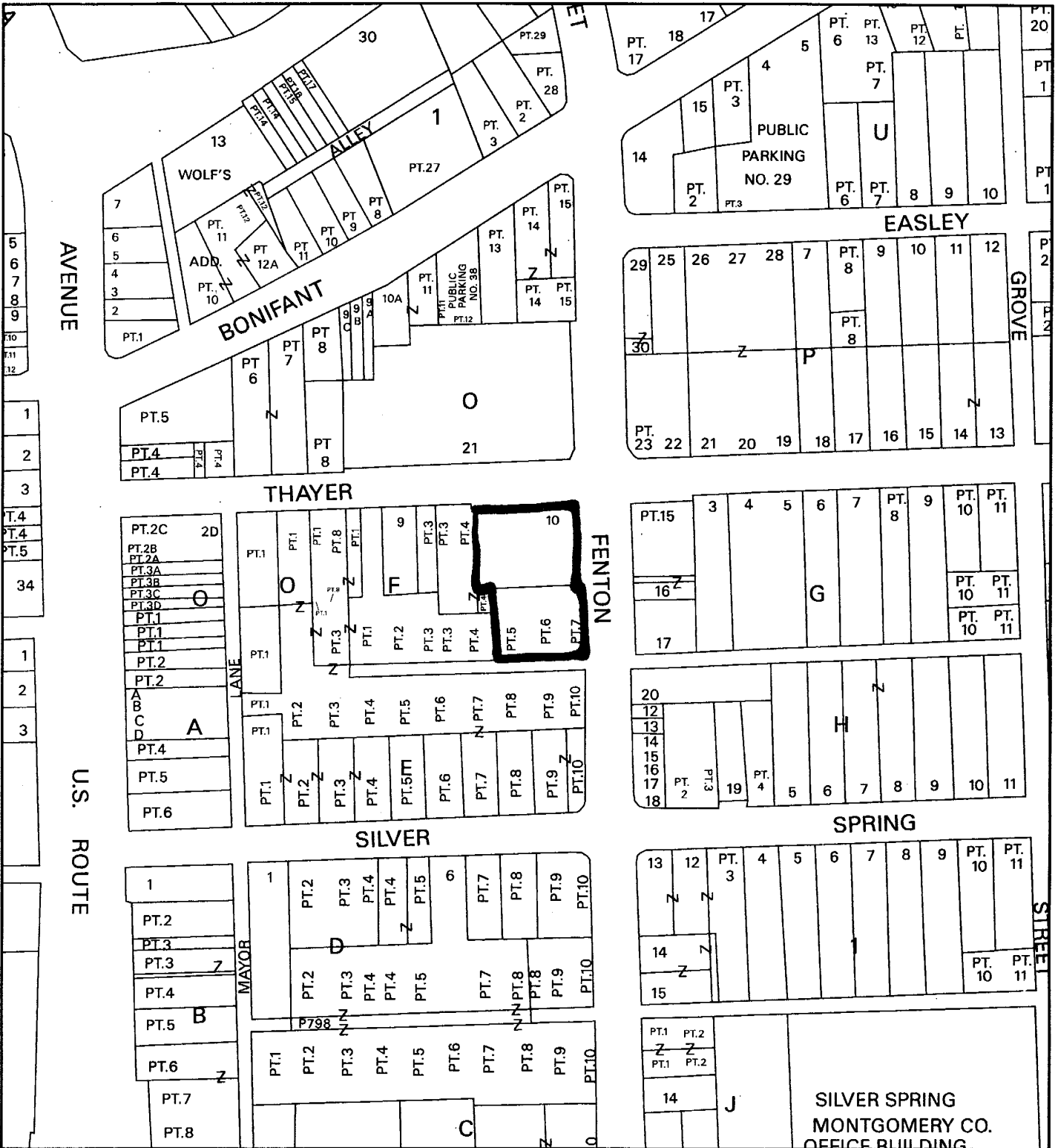

Map compiled on April 04, 2005 at 12:23 PM | Site located on base sheet no - 210NW01

NOTICE

The planimetric, property, and topographic information shown on this map is based on copyrighted Map Products from the Montgomery County Department of Park and Planning of the Maryland-National Capital Park and Planning Commission, and may not be copied or reproduced without written permission from M-NCPPC.

Property lines are compiled by adjusting the property lines to topography created from aerial photography and should not be interpreted as actual field surveys. Planimetric features were compiled from 1:14400 scale aerial photography using stereo photogrammetric methods.

This map is created from a variety of data sources, and may not reflect the most current conditions in any one location and may not be completely accurate or up to date. All map features are approximately within five feet of their true location. This map may not be the same as a map of the same area plotted at an earlier time as the data is continuously updated. Use of this map, other than for general planning purposes is not recommended. - Copyright 1998

