

BANNOCKBURN HEIGHTS (7-06003)



Map compiled on August 22, 2005 at 9:17 AM | Site located on base sheet no - 209NW06

NOTICE

The planimetric, property, and topographic information shown on this map is based on copyrighted Map Products from the Montgomery County Department of Park and Planning of the Maryland -National Capital Park and Planning Commission, and may not be copied or reproduced without written permission from M-NCPPC.

Property lines are compiled by adjusting the property lines to topography created from aerial photography and should not be interpreted as actual field surveys. Planimetric features were compiled from 1:14400 scale aerial photography using stereo photogrammetric methods.

This map is created from a variety of data sources, and may not reflect the most current conditions in any one location and may not be completely accurate or up to date. All map features are approximately within five feet of their true location. This map may not be the same as a map of the same area plotted at an earlier time as the data is continuously updated. Use of this map, other than for general planning purposes is not recommended. - Copyright 1998

Key Map

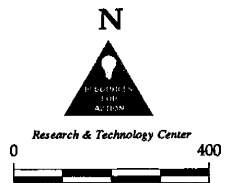
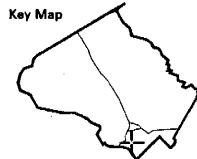

BANNOCKBURN HEIGHTS (7-06003)

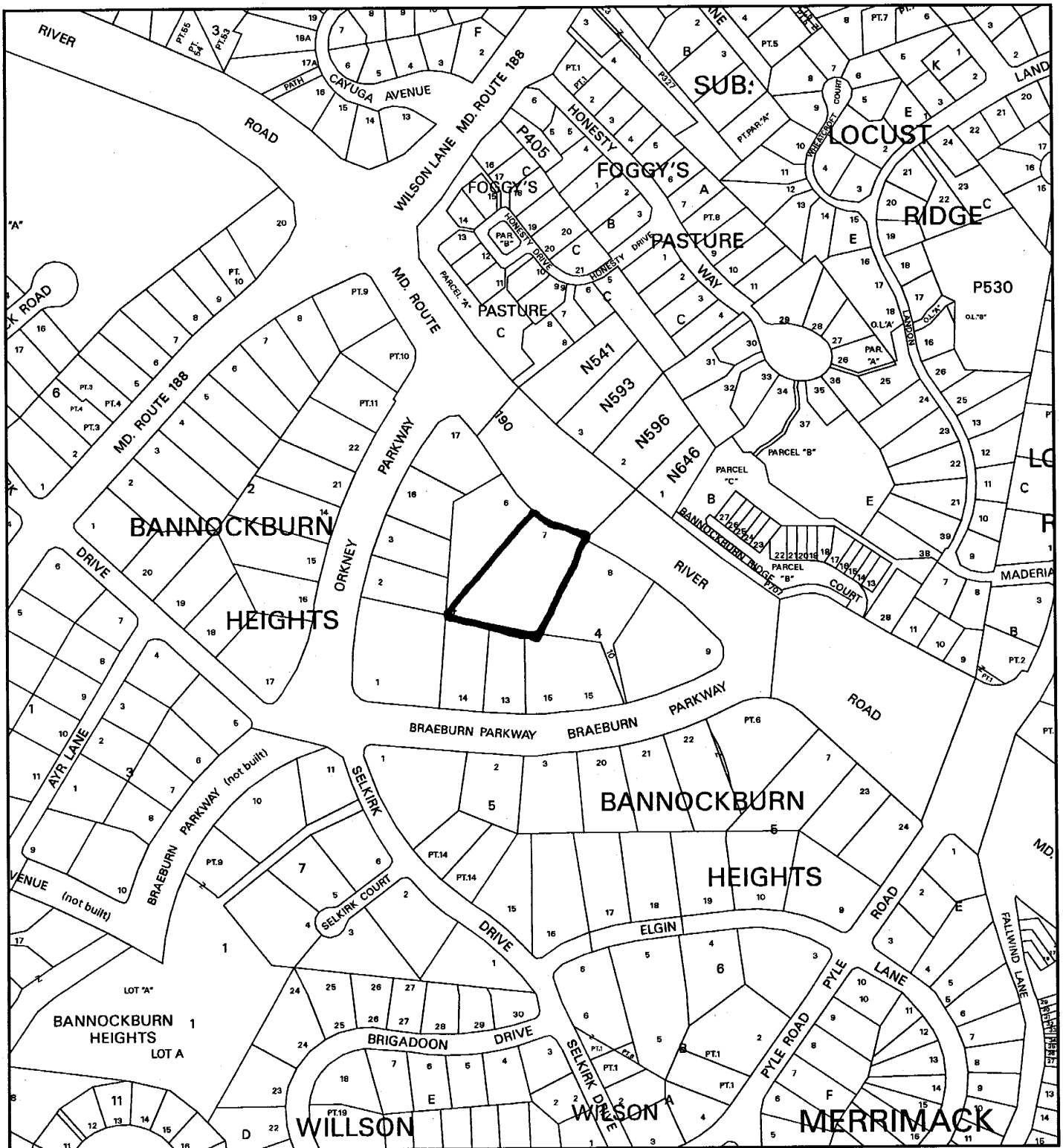

Map compiled on August 22, 2005 at 9:19 AM | Site located on base sheet no - 209NW06

NOTICE

The planimetric, property, and topographic information shown on this map is based on copyrighted Map Products from the Montgomery County Department of Park and Planning of the Maryland - National Capital Park and Planning Commission, and may not be copied or reproduced without written permission from M-NCPPC.

Property lines are compiled by adjusting the property lines to topography created from aerial photography and should not be interpreted as actual field surveys. Planimetric features were compiled from 1:14400 scale aerial photography using stereo photogrammetric methods.

This map is created from a variety of data sources, and may not reflect the most current conditions in any one location and may not be completely accurate or up to date. All map features are approximately within five feet of their true location. This map may not be the same as a map of the same area plotted at an earlier time as the data is continuously updated. Use of this map, other than for general planning purposes is not recommended. - Copyright 1998

Key Map



N



Research & Technology Center



1 inch = 400 feet
1:4800

MONTGOMERY COUNTY DEPARTMENT OF PARK AND PLANNING
THE MARYLAND-NATIONAL CAPITAL PARK AND PLANNING COMMISSION

M-NCPPC

8787 Georgia Avenue - Silver Spring, Maryland 20910-3760

BANNOCKBURN HEIGHTS

NOTES

1. Project title = Bannockburn Heights
2. Street address: 6620 River Road
3. Lot 7 is included on a recorded plat as "remainder of Block 4, in Plat Book 16, Plat 1045, proposed as Lots 18 and 19
4. Existing zoning = R-200; 20,000 sq. ft. min.
5. Bldg. setbacks: Front = 40 ft. or established bldg. line; Rear = 30 ft., Side = 25 ft. total (min. one side = 12 ft.)
6. Total area included in the plan = 67,695 sq. ft.
7. Number of lots included in the plan = 2
8. Planning area 35; Bethesda-Chevy Chase
9. Sewer/Water Category = S-1 and W-1
10. All utilities are at the site

Existing Macadam Service Road, 17 ft. wide

Dedicate for and construct T-arr. around or cul-de-sac, 7,945 sq. ft.

