

# S-2652 T-MOBILE AT INWOOD HOUSE



Map compiled on November 04, 2005 at 2:45 PM | Site located on base sheet no - 214NW02

## NOTICE

The planimetric, property, and topographic information shown on this map is based on copyrighted Map Products from the Montgomery County Department of Park and Planning of the Maryland-National Capital Park and Planning Commission, and may not be copied or reproduced without written permission from M-NCPPC.

Property lines are compiled by adjusting the property lines to topography created from aerial photography and should not be interpreted as actual field surveys. Planimetric features were compiled from 1:14400 scale aerial photography using stereo photogrammetric methods.

This map is created from a variety of data sources, and may not reflect the most current conditions in any one location and may not be completely accurate or up to date. All map features are approximately within five feet of their true location. This map may not be the same as a map of the same area plotted at an earlier time as the data is continuously updated. Use of this map, other than for general planning purposes is not recommended. - Copyright 1988

Key Map



N



1 inch = 400 feet  
1 : 4800

**MONTGOMERY COUNTY DEPARTMENT OF PARK AND PLANNING**  
THE MARYLAND-NATIONAL CAPITAL PARK AND PLANNING COMMISSION

8787 Georgia Avenue - Silver Spring, Maryland 20910-3760

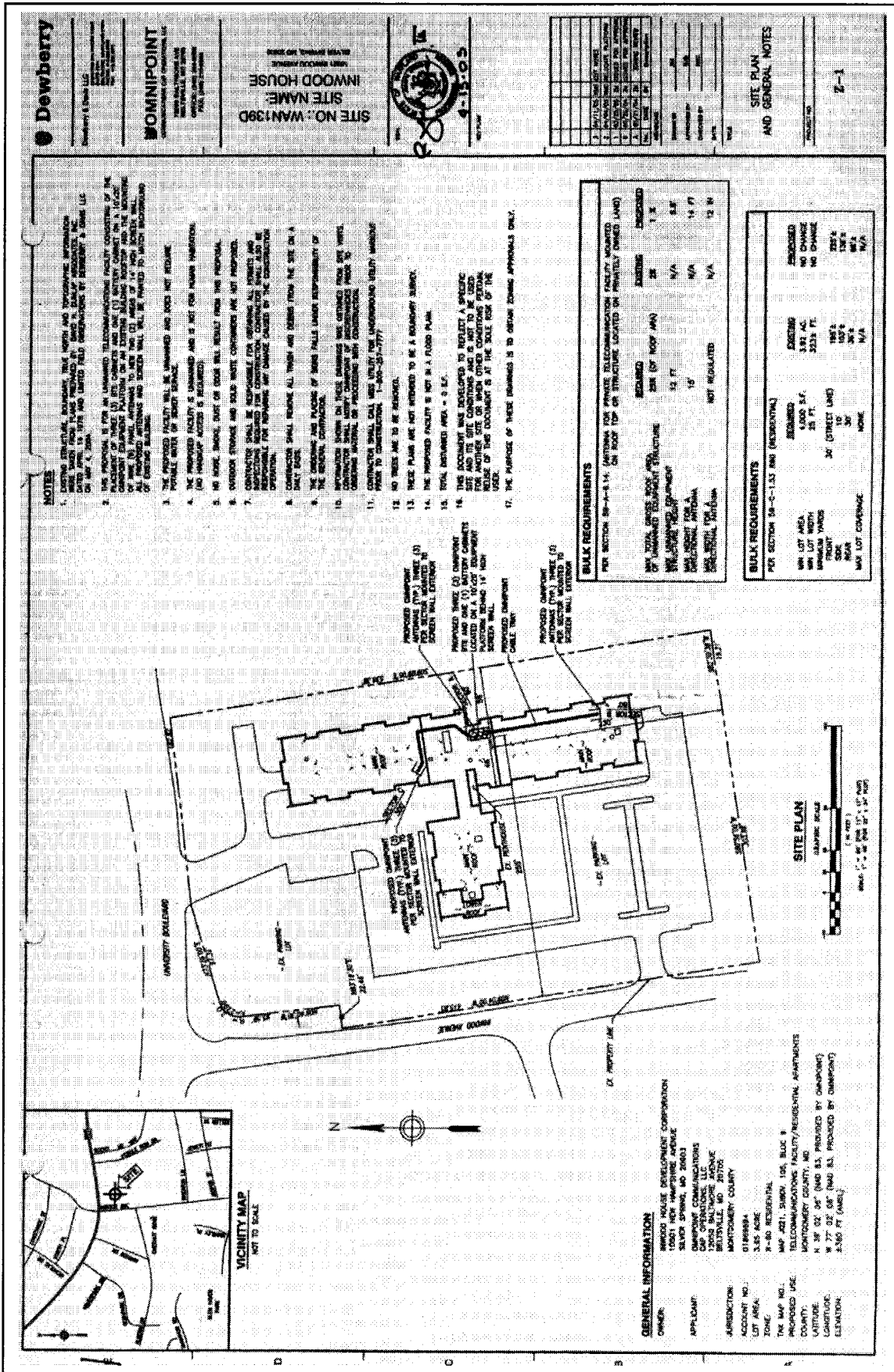

**Dewberry**  
 Dewberry (E) Inc. 1100  
 1100 University Blvd  
 Suite 100  
 Silver Spring, MD 20910  
 Tel: 301-588-8800  
 Fax: 301-588-8801

**DOMINPOINT**  
 COMMUNICATIONS, LLC  
 1100 University Blvd  
 Suite 100  
 Silver Spring, MD 20910  
 Tel: 301-588-8800  
 Fax: 301-588-8801

**SITE NO.: WAIN139D**  
**SITE NAME:**  
**INWOOD HOUSE**



NO.	DESCRIPTION	DATE	BY
1	REVISED TO ADD ANTENNA	04/19/03	...
2	REVISED TO ADD ANTENNA	04/19/03	...
3	REVISED TO ADD ANTENNA	04/19/03	...
4	REVISED TO ADD ANTENNA	04/19/03	...
5	REVISED TO ADD ANTENNA	04/19/03	...
6	REVISED TO ADD ANTENNA	04/19/03	...
7	REVISED TO ADD ANTENNA	04/19/03	...
8	REVISED TO ADD ANTENNA	04/19/03	...
9	REVISED TO ADD ANTENNA	04/19/03	...
10	REVISED TO ADD ANTENNA	04/19/03	...
11	REVISED TO ADD ANTENNA	04/19/03	...
12	REVISED TO ADD ANTENNA	04/19/03	...
13	REVISED TO ADD ANTENNA	04/19/03	...
14	REVISED TO ADD ANTENNA	04/19/03	...
15	REVISED TO ADD ANTENNA	04/19/03	...
16	REVISED TO ADD ANTENNA	04/19/03	...
17	REVISED TO ADD ANTENNA	04/19/03	...
18	REVISED TO ADD ANTENNA	04/19/03	...
19	REVISED TO ADD ANTENNA	04/19/03	...
20	REVISED TO ADD ANTENNA	04/19/03	...

**SITE PLAN AND GENERAL NOTES**

DATE: 04/19/03

SCALE: 1" = 20'

2-1

**NOTES**

1. THE PROPOSED FACILITY IS FOR AN UNLICENSED TELECOMMUNICATIONS FACILITY CONSISTING OF THE PLACEMENT OF THREE (3) ANTENNAS AND ONE (1) ANTENNA CABINET ON A 10' X 10' PLATFORM ON THE ROOF OF THE BUILDING. THE ANTENNAS WILL BE MOUNTED ON THE ROOF OF THE BUILDING. ALL ANTENNAS AND SCREEN WALLS WILL BE PAINTED TO MATCH BUILDING EXTERIOR COLOR.

2. THE PROPOSED FACILITY IS FOR AN UNLICENSED TELECOMMUNICATIONS FACILITY CONSISTING OF THE PLACEMENT OF THREE (3) ANTENNAS AND ONE (1) ANTENNA CABINET ON A 10' X 10' PLATFORM ON THE ROOF OF THE BUILDING. THE ANTENNAS WILL BE MOUNTED ON THE ROOF OF THE BUILDING. ALL ANTENNAS AND SCREEN WALLS WILL BE PAINTED TO MATCH BUILDING EXTERIOR COLOR.

3. THE PROPOSED FACILITY WILL BE UNLICENSED AND DOES NOT REQUIRE A LICENSE FROM THE FEDERAL COMMUNICATIONS COMMISSION (FCC).

4. THE PROPOSED FACILITY IS UNLICENSED AND IS NOT FOR HUMAN HABITATION.

5. NO SIGNAGE, LIGHT OR SOUND WILL RESULT FROM THIS FACILITY.

6. OUTDOOR STORAGE AND SOLID WASTE CONTAINERS ARE NOT PERMITTED.

7. SCREENING SHALL BE PROVIDED TO COMPLY WITH COMMUNITY DEVELOPMENT AND ENVIRONMENTAL PROTECTION AGENCY (CDEP) REGULATIONS FOR VISUAL QUALITY IMPACTS. THE CONTRACTOR SHALL BE RESPONSIBLE FOR PROVIDING AND MAINTAINING THE SCREENING.

8. CONTRACTOR SHALL REMOVE ALL TREES AND SHRUBS FROM THE SITE ON A PERMANENT BASIS.

9. THE DESIGN AND PLACING OF SIGNS FALLS UNDER RESPONSIBILITY OF THE CONTRACTOR.

10. CONTRACTOR SHALL OBTAIN ALL NECESSARY PERMITS FROM THE CITY OF SILVER SPRING, MONTGOMERY COUNTY, MARYLAND, PRIOR TO COMMENCING CONSTRUCTION.

11. CONTRACTOR SHALL CALL THE UTILITY LOCATIONS AND UTILITY MARKING PRIOR TO CONSTRUCTION. 1-800-487-7777

12. NO TREES ARE TO BE REMOVED.

13. THESE PLANS ARE NOT INTENDED TO BE A BOUNDARY SURVEY.

14. THE PROPOSED FACILITY IS NOT IN A FLOOD PLAIN.

15. TOTAL DISTURBED AREA = 0.5 A.C.

16. THIS DOCUMENT IS PROVIDED TO VERIFY A SPECIFIC SITE AND ITS SITE CONDITIONS AND IS NOT TO BE USED FOR ANY OTHER SITE OR UNDER OTHER CONDITIONS. THE USER OF THIS DOCUMENT IS AT THE SOLE RISK OF THE USER.

17. THE PURPOSE OF THESE DRAWINGS IS TO OBTAIN ZONING APPROVALS ONLY.

**BULK REQUIREMENTS**

FOR SECTION 54-6-1.3 (RESIDENTIAL)

REQUIRED	AS REQUIRED	AS REQUIRED
MIN. LOT AREA	4,000 S.F.	3,911 A.C.
MINIMUM YARDS	25 FT.	5,024 FT.
FRONT YARD	20' (STREET LINES)	180' S.
REAR YARD	10'	120' S.
MIN. LOT COVERAGE	NONE	N/A

**BULK REQUIREMENTS**

FOR SECTION 54-6-1.3 (RESIDENTIAL)

REQUIRED	AS REQUIRED	AS REQUIRED
MIN. TOTAL GROSS FLOOR AREA OF UNLICENSED TELECOMMUNICATIONS FACILITY LOCATED ON PRIVATELY OWNED LAND	200	17.5
MIN. UNLICENSED TELECOMMUNICATIONS FACILITY HEIGHT	15 FT.	N/A
MIN. UNLICENSED TELECOMMUNICATIONS FACILITY WIDTH	15 FT.	N/A
MIN. UNLICENSED TELECOMMUNICATIONS FACILITY DEPTH	15 FT.	N/A
MIN. UNLICENSED TELECOMMUNICATIONS FACILITY DISTANCE FROM PROPERTY LINE	NOT REGULATED	N/A
MIN. UNLICENSED TELECOMMUNICATIONS FACILITY DISTANCE FROM STREET	NOT REGULATED	N/A

**GENERAL INFORMATION**

OWNER: INWOOD HOUSE DEVELOPMENT CORPORATION  
 1100 UNIVERSITY BLVD  
 SILVER SPRING, MD 20910

APPLICANT: DOMINPOINT COMMUNICATIONS, LLC  
 1100 UNIVERSITY BLVD  
 SILVER SPRING, MD 20910

ADDRESS: 139D WAIN, BLOCK 8  
 3.65 ACRES  
 R-80 RESIDENTIAL

TAX MAP NO.: MAP 021, SHOWING BLOCK 8  
 TELECOMMUNICATIONS FACILITY/RESIDENTIAL APARTMENTS

COUNTY: MONTGOMERY COUNTY, MD

LATITUDE: N 39° 02' 08" (NAD 83, PROVIDED BY DOMINPOINT)

LONGITUDE: W 77° 02' 08" (NAD 83, PROVIDED BY DOMINPOINT)

ELEVATION: 2,500 FT (AVERAGE)

**VICINITY MAP**  
 NOT TO SCALE

**SITE PLAN**  
 GRAPHIC SCALE  
 1" = 20'

**GENERAL NOTES**

1. THE PROPOSED FACILITY IS FOR AN UNLICENSED TELECOMMUNICATIONS FACILITY CONSISTING OF THE PLACEMENT OF THREE (3) ANTENNAS AND ONE (1) ANTENNA CABINET ON A 10' X 10' PLATFORM ON THE ROOF OF THE BUILDING. THE ANTENNAS WILL BE MOUNTED ON THE ROOF OF THE BUILDING. ALL ANTENNAS AND SCREEN WALLS WILL BE PAINTED TO MATCH BUILDING EXTERIOR COLOR.

2. THE PROPOSED FACILITY IS FOR AN UNLICENSED TELECOMMUNICATIONS FACILITY CONSISTING OF THE PLACEMENT OF THREE (3) ANTENNAS AND ONE (1) ANTENNA CABINET ON A 10' X 10' PLATFORM ON THE ROOF OF THE BUILDING. THE ANTENNAS WILL BE MOUNTED ON THE ROOF OF THE BUILDING. ALL ANTENNAS AND SCREEN WALLS WILL BE PAINTED TO MATCH BUILDING EXTERIOR COLOR.

3. THE PROPOSED FACILITY WILL BE UNLICENSED AND DOES NOT REQUIRE A LICENSE FROM THE FEDERAL COMMUNICATIONS COMMISSION (FCC).

4. THE PROPOSED FACILITY IS UNLICENSED AND IS NOT FOR HUMAN HABITATION.

5. NO SIGNAGE, LIGHT OR SOUND WILL RESULT FROM THIS FACILITY.

6. OUTDOOR STORAGE AND SOLID WASTE CONTAINERS ARE NOT PERMITTED.

7. SCREENING SHALL BE PROVIDED TO COMPLY WITH COMMUNITY DEVELOPMENT AND ENVIRONMENTAL PROTECTION AGENCY (CDEP) REGULATIONS FOR VISUAL QUALITY IMPACTS. THE CONTRACTOR SHALL BE RESPONSIBLE FOR PROVIDING AND MAINTAINING THE SCREENING.

8. CONTRACTOR SHALL REMOVE ALL TREES AND SHRUBS FROM THE SITE ON A PERMANENT BASIS.

9. THE DESIGN AND PLACING OF SIGNS FALLS UNDER RESPONSIBILITY OF THE CONTRACTOR.

10. CONTRACTOR SHALL OBTAIN ALL NECESSARY PERMITS FROM THE CITY OF SILVER SPRING, MONTGOMERY COUNTY, MARYLAND, PRIOR TO COMMENCING CONSTRUCTION.

11. CONTRACTOR SHALL CALL THE UTILITY LOCATIONS AND UTILITY MARKING PRIOR TO CONSTRUCTION. 1-800-487-7777

12. NO TREES ARE TO BE REMOVED.

13. THESE PLANS ARE NOT INTENDED TO BE A BOUNDARY SURVEY.

14. THE PROPOSED FACILITY IS NOT IN A FLOOD PLAIN.

15. TOTAL DISTURBED AREA = 0.5 A.C.

16. THIS DOCUMENT IS PROVIDED TO VERIFY A SPECIFIC SITE AND ITS SITE CONDITIONS AND IS NOT TO BE USED FOR ANY OTHER SITE OR UNDER OTHER CONDITIONS. THE USER OF THIS DOCUMENT IS AT THE SOLE RISK OF THE USER.

17. THE PURPOSE OF THESE DRAWINGS IS TO OBTAIN ZONING APPROVALS ONLY.

**BULK REQUIREMENTS**

FOR SECTION 54-6-1.3 (RESIDENTIAL)

REQUIRED	AS REQUIRED	AS REQUIRED
MIN. LOT AREA	4,000 S.F.	3,911 A.C.
MINIMUM YARDS	25 FT.	5,024 FT.
FRONT YARD	20' (STREET LINES)	180' S.
REAR YARD	10'	120' S.
MIN. LOT COVERAGE	NONE	N/A

**BULK REQUIREMENTS**

FOR SECTION 54-6-1.3 (RESIDENTIAL)

REQUIRED	AS REQUIRED	AS REQUIRED
MIN. TOTAL GROSS FLOOR AREA OF UNLICENSED TELECOMMUNICATIONS FACILITY LOCATED ON PRIVATELY OWNED LAND	200	17.5
MIN. UNLICENSED TELECOMMUNICATIONS FACILITY HEIGHT	15 FT.	N/A
MIN. UNLICENSED TELECOMMUNICATIONS FACILITY WIDTH	15 FT.	N/A
MIN. UNLICENSED TELECOMMUNICATIONS FACILITY DEPTH	15 FT.	N/A
MIN. UNLICENSED TELECOMMUNICATIONS FACILITY DISTANCE FROM PROPERTY LINE	NOT REGULATED	N/A
MIN. UNLICENSED TELECOMMUNICATIONS FACILITY DISTANCE FROM STREET	NOT REGULATED	N/A

**GENERAL INFORMATION**

OWNER: INWOOD HOUSE DEVELOPMENT CORPORATION  
 1100 UNIVERSITY BLVD  
 SILVER SPRING, MD 20910

APPLICANT: DOMINPOINT COMMUNICATIONS, LLC  
 1100 UNIVERSITY BLVD  
 SILVER SPRING, MD 20910

ADDRESS: 139D WAIN, BLOCK 8  
 3.65 ACRES  
 R-80 RESIDENTIAL

TAX MAP NO.: MAP 021, SHOWING BLOCK 8  
 TELECOMMUNICATIONS FACILITY/RESIDENTIAL APARTMENTS

COUNTY: MONTGOMERY COUNTY, MD

LATITUDE: N 39° 02' 08" (NAD 83, PROVIDED BY DOMINPOINT)

LONGITUDE: W 77° 02' 08" (NAD 83, PROVIDED BY DOMINPOINT)

ELEVATION: 2,500 FT (AVERAGE)

**VICINITY MAP**  
 NOT TO SCALE

**SITE PLAN**  
 GRAPHIC SCALE  
 1" = 20'

**GENERAL NOTES**

1. THE PROPOSED FACILITY IS FOR AN UNLICENSED TELECOMMUNICATIONS FACILITY CONSISTING OF THE PLACEMENT OF THREE (3) ANTENNAS AND ONE (1) ANTENNA CABINET ON A 10' X 10' PLATFORM ON THE ROOF OF THE BUILDING. THE ANTENNAS WILL BE MOUNTED ON THE ROOF OF THE BUILDING. ALL ANTENNAS AND SCREEN WALLS WILL BE PAINTED TO MATCH BUILDING EXTERIOR COLOR.

2. THE PROPOSED FACILITY IS FOR AN UNLICENSED TELECOMMUNICATIONS FACILITY CONSISTING OF THE PLACEMENT OF THREE (3) ANTENNAS AND ONE (1) ANTENNA CABINET ON A 10' X 10' PLATFORM ON THE ROOF OF THE BUILDING. THE ANTENNAS WILL BE MOUNTED ON THE ROOF OF THE BUILDING. ALL ANTENNAS AND SCREEN WALLS WILL BE PAINTED TO MATCH BUILDING EXTERIOR COLOR.

3. THE PROPOSED FACILITY WILL BE UNLICENSED AND DOES NOT REQUIRE A LICENSE FROM THE FEDERAL COMMUNICATIONS COMMISSION (FCC).

4. THE PROPOSED FACILITY IS UNLICENSED AND IS NOT FOR HUMAN HABITATION.

5. NO SIGNAGE, LIGHT OR SOUND WILL RESULT FROM THIS FACILITY.

6. OUTDOOR STORAGE AND SOLID WASTE CONTAINERS ARE NOT PERMITTED.

7. SCREENING SHALL BE PROVIDED TO COMPLY WITH COMMUNITY DEVELOPMENT AND ENVIRONMENTAL PROTECTION AGENCY (CDEP) REGULATIONS FOR VISUAL QUALITY IMPACTS. THE CONTRACTOR SHALL BE RESPONSIBLE FOR PROVIDING AND MAINTAINING THE SCREENING.

8. CONTRACTOR SHALL REMOVE ALL TREES AND SHRUBS FROM THE SITE ON A PERMANENT BASIS.

9. THE DESIGN AND PLACING OF SIGNS FALLS UNDER RESPONSIBILITY OF THE CONTRACTOR.

10. CONTRACTOR SHALL OBTAIN ALL NECESSARY PERMITS FROM THE CITY OF SILVER SPRING, MONTGOMERY COUNTY, MARYLAND, PRIOR TO COMMENCING CONSTRUCTION.

11. CONTRACTOR SHALL CALL THE UTILITY LOCATIONS AND UTILITY MARKING PRIOR TO CONSTRUCTION. 1-800-487-7777

12. NO TREES ARE TO BE REMOVED.

13. THESE PLANS ARE NOT INTENDED TO BE A BOUNDARY SURVEY.

14. THE PROPOSED FACILITY IS NOT IN A FLOOD PLAIN.

15. TOTAL DISTURBED AREA = 0.5 A.C.

16. THIS DOCUMENT IS PROVIDED TO VERIFY A SPECIFIC SITE AND ITS SITE CONDITIONS AND IS NOT TO BE USED FOR ANY OTHER SITE OR UNDER OTHER CONDITIONS. THE USER OF THIS DOCUMENT IS AT THE SOLE RISK OF THE USER.

17. THE PURPOSE OF THESE DRAWINGS IS TO OBTAIN ZONING APPROVALS ONLY.

Attachment 2