

# Sewer Service Area Categories Map WSSCR 06A-APH-01 (Barbara Johnson)

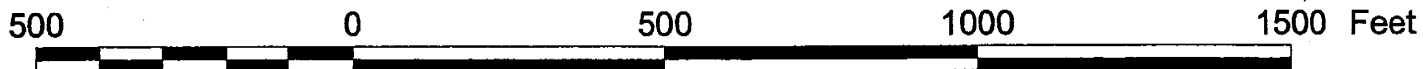

### MAP LEGEND

- Property (Sept. 2004)
- WSSC/GIS Tile Grid
- Sewer Manholes
- Sewer Mains**
- Small-Diameter, Low-Pressure Mains
- 6"- to 8"-Diameter Gravity Mains
- 10"- to 14"-Diameter Gravity Mains
- 15"- to 18"-Diameter (CIP) Trunk Mains
- 20"- to 42"-Dia. (CIP) Mains \*
- 48"- or Larger-Diameter (CIP) Trunk Mains \*
- \* No Individual Connections
- Topography (C.I. = 5 Feet)
- Buildings
- Roads
- Streams
- Ponds - Lakes
- Woodlands

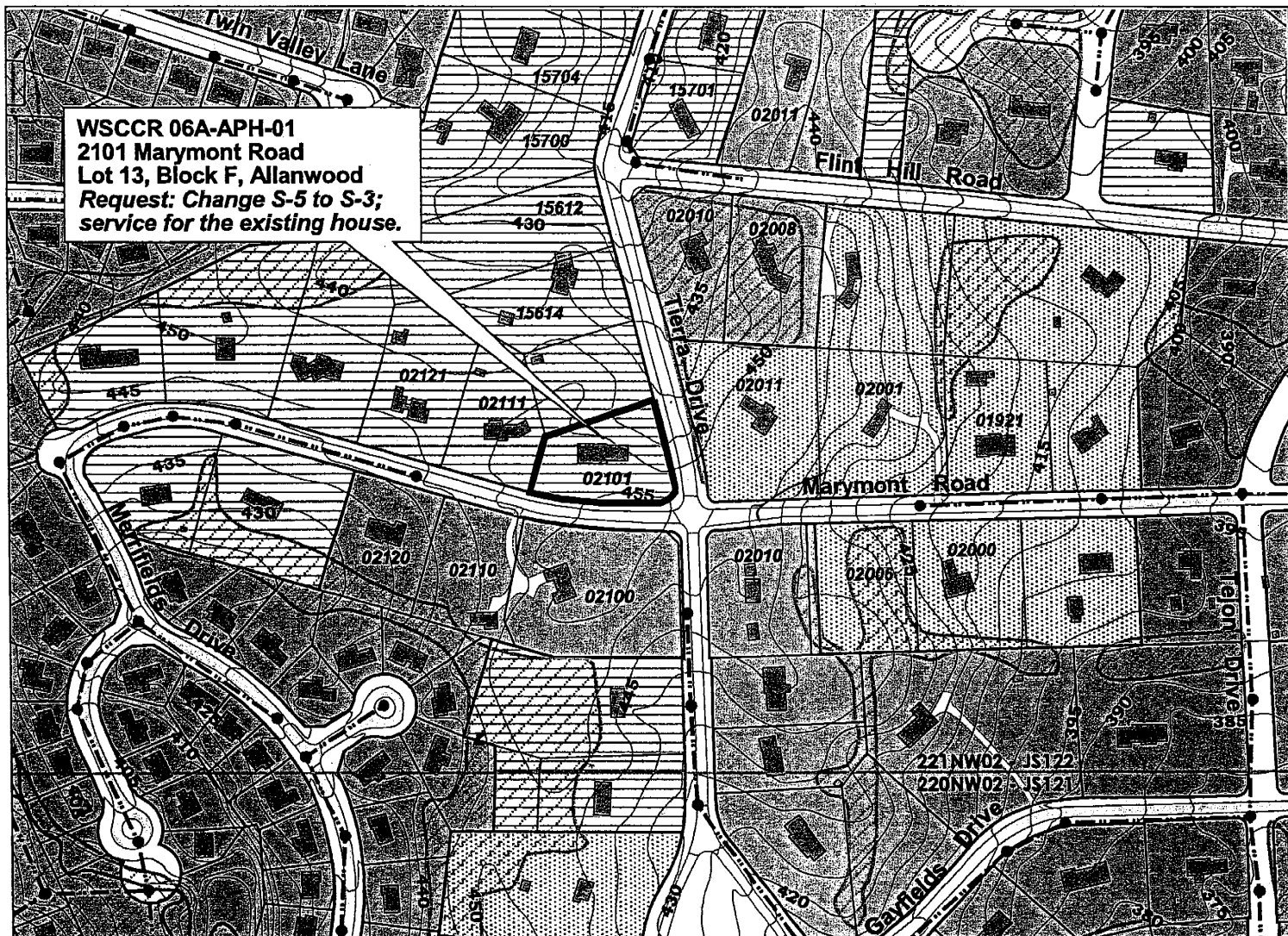
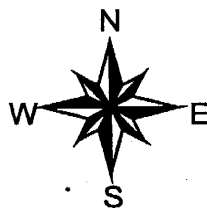

### Sewer Service Area Categories (6/03)

- S-1
- S-3
- S-4
- S-5
- S-6

June 2003 Update  
Service Area Categories Map

Montgomery County, Maryland  
Comprehensive Water Supply  
and Sewerage Systems Plan



Water and Wastewater Policy Group  
8/4/05 - GIS Project File:  
o:\wwteam\ccrs-pas\aspenhill\2006ccrs\06a-aph-01=johnson=s.apr

9

CLOVERLY – NORWOOD PLANNING AREA			
Map Amendment No.: Applicant (Owner)			
Property Information Development	Service Area Categories Existing Requested	Reviewing Agency Comments (Main extensions are non-CIP sized unless specified.)	Planning Board and County Council Positions Public Testimony
<b>WSSCR 05A-CLO-03: Michelle &amp; Diego Albornoz</b>			
<ul style="list-style-type: none"> <li>▪ Lot 4, Block B, Sniders Estates</li> <li>▪ 221NE01; JS562</li> <li>▪ 712 Snider La</li> <li>▪ Cloverly Master Plan (1987)</li> <li>▪ Northwest Branch (MDE Use IV)</li> <li>▪ RE-1 Zone; 0.70 ac.</li> <li>▪ Existing: single family house</li> <li>▪ Proposed: single family house</li> </ul>	<p>W-1                      W-n/c S-5                        S-1</p> <p>Applicant's Explanation: none provided</p>	<p>WSSC-Sewer: (pending) DEP comment: 8" sewer (C.1996) abuts the property along Snider Lane. DEP directed WSSC to provide a single sewer connection under the abutting mains policy on 3/21/05.</p> <p>DPS-Well &amp; Septic: The original system was permitted and installed in 1955. In February 1987 a complaint of a surface discharge was investigated by this office. The complaint was determined to be valid; the problem was corrected in March 1977.</p> <p>M-NCPPC Staff: (pending)</p>	<p><u>Planning Board:</u></p> <p><u>County Council:</u></p> <p><u>Testimony:</u></p>
<p><b>DEP Staff Recommendation:</b> Approve S-1. Policy V.F.1.a.: Consistent with Existing Plans.</p> <p><b>DEP Staff Report:</b> The provision of public sewer service is consistent with Water and Sewer Plan policies, and with Master Plan recommendations. Although the site is zoned RE-1, the cluster development option (often an environmental justification for public sewer) cannot be used in this case because of the small size of the property. Public sewer service is already available to the property from an abutting main along Snider Lane.</p>			



MONTGOMERY COUNTY DEPARTMENT OF ENVIRONMENTAL PROTECTION  
WATERSHED MANAGEMENT DIVISION

Rockville Center ■ 255 Rockville Pike, Suite 120 ■ Rockville, Maryland 20850-4166  
Telephone No.: 240-777-7716/-7735 ■ FAX No.: 240-777-7715

WATER/SEWER SERVICE AREA CATEGORY CHANGE REQUEST

00268094

PROPOSED AMENDMENT TO THE  
MONTGOMERY COUNTY, MARYLAND  
TEN-YEAR COMPREHENSIVE WATER  
SUPPLY AND SEWERAGE SYSTEMS PLAN

Type or print all information.  
Please read the accompanying instructions  
before—or at least as—you fill out this application.

= MCDEP-WMD Staff Use Only =	
WSSCR	05A-C10-03
Water	Sewer <input checked="" type="checkbox"/>
GIS Tile	22INE01
Tax Map	JSS02
Plan No.	-
Process	AD

APPLICANT

Name Michele & Diego Albornoz  
Address 712 Snider Lane  
Silver Spring, MD 20905  
Telephone 301-384-0823  
Fax 301-879-0640  
e-mail

Applicant's Authorization: Check one of the following boxes as applicable:  
 Property Owner  Contract Purchaser\*  
 Owner's/Purchaser's Authorized Representative\* (\*see below)

Signature Michele Albornoz  
Date 4/5/05

PROPERTY OWNER

Name Michele & Diego Albornoz  
Address 712 Snider Lane  
SS MD 20905  
Telephone 301-384-0823  
Fax 301-879-0640  
e-mail

Property Owner's Authorization: The applicant listed above is authorized to pursue a service area category change on my behalf for the property(ies) described on this application.

Signature Michele Albornoz  
Date 4/5/05

7100 Applicant

PROPERTY/SITE DESCRIPTION AND DEVELOPMENT

Note: Attach an 8 1/2"x11" copy of the state tax map with the subject property(ies) highlighted. see attached sheet  
Address \_\_\_\_\_ Property/Site Size \_\_\_\_\_  
Identification \_\_\_\_\_  
Location \_\_\_\_\_  
Existing Use \_\_\_\_\_ Proposed Use \_\_\_\_\_  
Subdivision Plan No. & Status \_\_\_\_\_

WATER AND SEWER SERVICE AREA CATEGORIES

Existing Water Category W - 1 Requested Water Category W - 1  
Existing Sewer Category S - 5 Requested Sewer Category S - 1

REASON FOR THIS CATEGORY CHANGE REQUEST

2005-04-18 A08:41

Note: Continue on a separate page or attach a letter, if necessary

= MCDEP-WMD Staff Use Only =	
Master Plan	Cloverly-Abertown (1987)
Planning Area	Cloverly-Norwood
Zoning	RE-1
Zoning Activity	NONE
Watershed	NORTHWEST BE
CSPS Subwatershed	
State Watershed Use Class	IV
GIS File	

Post-it® Fax Note	7671	Date	3/31/05	# of pages	6
To	MICHELE ALBORNOZ	From	ALAN SOURUP		
Co./Dept.		Co.	MONT. CO. DEP		
Phone #		Phone #	240-777-7716		
Fax #	301-879-0640	Fax #	240-777-7713		

MEMORANDUM

March 21, 2005

TO: Peg Robinson, Group Leader, Service Applications Group  
Washington Suburban Sanitary Commission

FROM: Alan Soukup, Senior Environmental Planner  
Department of Environmental Protection, Water and Wastewater Policy Group

SUBJECT: Request to Provide a Single Water/Sewer Service Connection

This is to request that WSSC accept and act on an application for a sewer connection for the following property:

Property Address & Identification	Owner – Est. Date	Abutting Main - 200' Tile	WSSCR No.
712 Snider Lane, Cloverly Lot 4, Block B, Sniders Estates (JS562)	Michele & D. Albornoz	8" sewer - #96 (221NE01)	<i>Pending</i> S-5 to S-1

Our records show that house located on this property was constructed in 1955, prior to the construction of the existing abutting sewer main (see above). Given this, the property is eligible for a single sewer service connection under the abutting mains service policy in the County's Water and Sewer Plan. DEP is working with the property owner on a water/sewer service area category change amendment to formally allow the provision of public service to the property.

WSSC may approve and install the requested water service connection in advance of DEP's approval of the associated service area change. The County's approved Water and Sewer Plan now allows DEP to direct WSSC to provide public service for cases which satisfy the abutting mains policy.

If you have any questions concerning this request, please contact either me at 240-777-7716 or Shelley Janashek at 240-777-7735.

ADS:ads\R:\Programs\Water\_and\_Sewer\Projects\WSSC\connections\connectdocs\2005\snider\_ln\_712=s=032105.doc

Attachment

cc: Lisa Sine, Service Applications Group, WSSC  
Beth Forbes, Development Services Group, WSSC  
Katherine Nelson, County-Wide Planning/Environmental, M-NCPPC  
Jay Beatty, Well and Septic Section, DPS  
Michele & D. Albornoz

# Sewer Service Area Categories Map

## WSSCR 05A-CLO-03 (Michelle & Diego Albornoz)

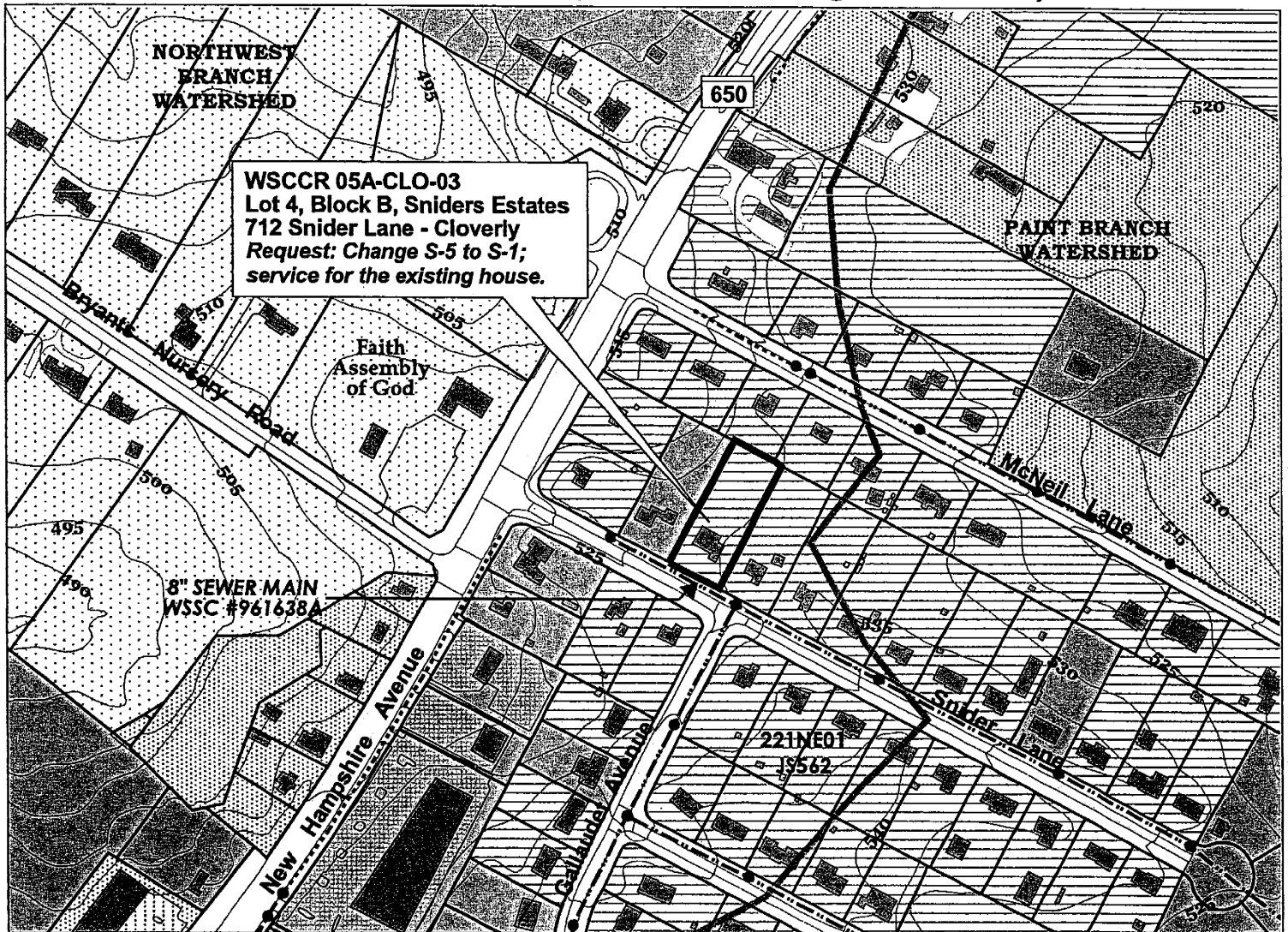

Cloverly Planning Area

map tile: 221NE01 - JS562

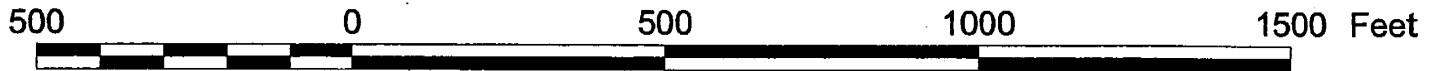

### MAP LEGEND

- Property
- WSSC/GIS Tile Grid
- Sewer Manholes
- Sewer Mains**
- Small-Diameter, Low-Pressure Mains
- 6"- to 8"-Diameter Gravity Mains
- 10"- to 14"-Diameter Gravity Mains
- 15"- to 18"-Diameter (CIP) Trunk Mains
- Topography (C.I. = 5 Feet)
- Buildings
- Roads
- Parking
- Watersheds
- Streams
- Ponds - Lakes

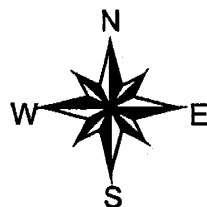

### Sewer Service Area Categories (6/03)

- S-1
- S-3
- S-4
- S-5
- S-6

June 2003 Update  
Service Area Categories Map

Montgomery County, Maryland  
Comprehensive Water Supply  
and Sewerage Systems Plan

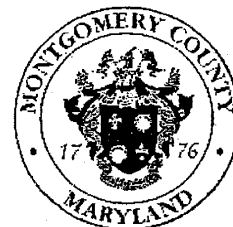

Water and Wastewater Planning  
7/23/05 -- GIS Project File:  
o:\wwteam\ccrs-pas\cloverly\2005ccrs\  
05a-clo-03=albornoz=s.apr

13

DARNESTOWN PLANNING AREA			
Map Amendment No.: Applicant (Owner)			
Property Information Development	Service Area Categories Existing Requested	Reviewing Agency Comments (Main extensions are non-CIP sized unless specified.)	Planning Board and County Council Positions Public Testimony
<b>WSSCR 05A-DNT-01: Ida Green</b>			
<ul style="list-style-type: none"> <li>▪ Parcel 568, Add. To Quince Orchard</li> <li>▪ 221NW12; ES562</li> <li>▪ 15715 Quince Orchard Rd.;</li> <li>▪ Potomac Subregion Master Plan (2002)</li> <li>▪ Muddy Branch (MDE Use I)</li> <li>▪ R-200/TDR Zone; 0.51 ac.</li> <li>▪ Existing &amp; Proposed: Single family house</li> </ul>	<p>W-4            <b>W-3</b> S-6            <b>S-3</b></p> <p>Applicant's Explanation "Adjacent or nearby properties with existing public water and/or sewer service"</p>	<p><u>WSSC-Water</u>: A 12-inch water line in Quince Orchard Road abuts the property (contract no. 88-7716E).</p> <p><u>WSSC-Sewer</u>: A 220-foot-long non-CIP-sized sewer extension is required to serve the property. This extension would connect to existing 8-inch sewer in Quince Orchard Road (contract no. 00-2941A) and would abut approximately 4 properties in addition to the applicant's.</p> <p><u>DPS-Well &amp; Septic</u>: We do not have record of an existing well or septic on 15719 Quince Orchard Road – the house was built in 1947 and predates our records.</p> <p><u>M-NCPPC Staff</u>: (pending)</p>	<p><u>Planning Board</u>:</p> <p><u>County Council</u>:</p> <p><u>Testimony</u>:</p>
<p><b>DEP Staff Recommendation:</b> Approve W-1 and S-3. Policy V.F.1.a.: Consistent with Existing Plans.</p> <p><b>DEP Staff Report:</b> The provision of public water and sewer service is consistent with Water and Sewer Plan policies and master plan recommendations. The property is zoned R-200, which is consistent with general water and sewer service policies. Public water service abuts the property; sewer service will require only a relatively short main extension.</p>			

14

MONTGOMERY COUNTY DEPARTMENT OF ENVIRONMENTAL PROTECTION

255 Rockville Pike, Suite 120, Rockville, Maryland 20850-4166

Email: alan.soukup@montgomerycountymd.gov or shellej.janashek@montgomerycountymd.gov

Telephone No.: 240-777-7716/-7735, FAX No.: 240-777-7715

00393531

WATER/SEWER SERVICE AREA CATEGORY CHANGE REQUEST

PROPOSED AMENDMENT TO THE MONTGOMERY COUNTY, MARYLAND, TEN-YEAR COMPREHENSIVE WATER SUPPLY AND SEWERAGE SYSTEMS PLAN

= MCDEP-WMD Receipt Date =

Type or print all information. Please read the accompanying instructions.

MCDEP-WMD Staff Use Only = WSCCR: 05A-DNT-01 Water: [checked] Sewer: [checked] GIS Tile: Z2INWIZ Tax Map: ES562 Plan No: - Process: A

APPLICANT

Name: Ida P. Green Address: 15715 Quince Orchard Road Gaithersburg, Maryland 20878 EMail: Rita M Green @ Hotmail, COM Phone: 301-953-0860 FAX: 301-987-7623

Applicant's Authorization: Check one of the following boxes as applicable: [checked] Property Owner [ ] Contract Purchaser\* [ ] Owner's/Purchaser's Authorized Representative\* (\*see below) Signature: Ida Pearl Green Date: 4-7-05

PROPERTY OWNER

Name: Address: EMail: Phone: FAX:

Property Owner's Authorization: The applicant listed above is authorized to pursue a service area category change on my behalf for the property(ies) described on this application. Signature: Date:

PROPERTY/SITE DESCRIPTION AND DEVELOPMENT

Note: Attach an 8."x11" copy of the state tax map with the property(ies) highlighted; this map is available at http://dat.state.md.us; click on "Real Property Data Search" and proceed from that point. Address: 15715 Quince Orchard Rd. Property/Site Size: 22,108.95 SF 0.51 acres Identification: Parcel 568 N. Half 1364S Addition to Quince Orchard 00393531 Location: East side Quince Orchard Road Existing Use: single family house Proposed Use: no change Subdivision Plan No. & Status:

WATER AND SEWER SERVICE AREA CATEGORIES

Existing Water Category: W-4 Requested Water Category: W-3 Existing Sewer Category: S-1a Requested Sewer Category: S-3

REASON FOR THIS CATEGORY CHANGE REQUEST

Adjacent or nearby properties with existing public water and/or sewer service

Note: Continue on a separate page or attach a letter, if necessary

MCDEP-WMD Staff Use Only = Master Plan: POTOMAC SUBREGION (2002) Planning Area: DARGESTOWN Zoning: R-200/TDR Zoning Activity: NONE Watershed: MUDDY CR. CSPS Subwatershed: State Watershed Use Class: I GIS File:

15

QUINCE ORCHARD ROAD

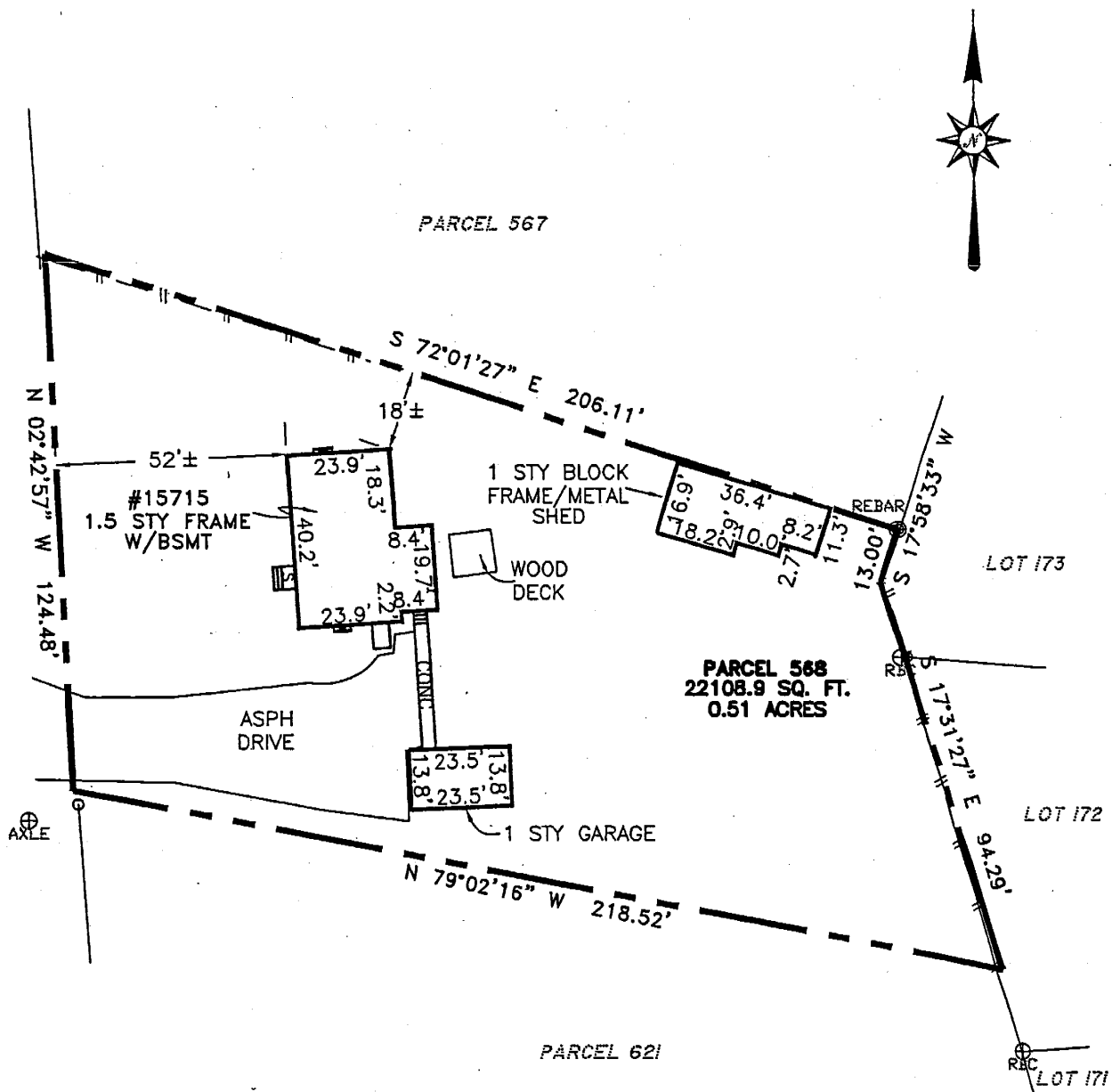

**SURVEYOR'S CERTIFICATE**

I hereby certify to the best of my knowledge and belief that the property delineated hereon is in accordance with the Plat of Subdivision and/or deed of record, No Title Report has been furnished.

That the improvements were located by accepted field practices and include permanent visible structures and encroachments, if any; and

- (i) is of benefit to a consumer only insofar as it is required by lender or title insurance company or its agent in connection with contemplated transfer, financing or refinancing;
- (ii) is not to be relied upon for the establishment or location of fences, garages, building or other existing or future improvements;
- (iii) does not provide for the accurate identification of property boundary lines, but such identification may not be required for the transfer of title or securing financing or refinancing.

*Jefferson D. Lawrence 3-24-05*

For: O'Connell & Lawrence, Inc., Jefferson D. Lawrence  
Professional Land Surveyor, MD No. #5216

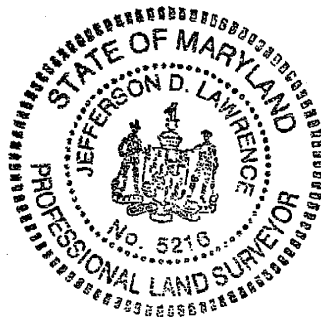

Wall Ck.	00/00/00	Final	03/18/05	Recert	00/00/00	Scale	1"=40'	Job No.	005-012
----------	----------	-------	----------	--------	----------	-------	--------	---------	---------

O'Connell & Lawrence, Inc.



Construction Consultants, Engineers, Surveyors  
17904 Georgia Avenue, Suite 302  
Olney, Maryland 20832  
Tel: (301) 924-4570 \* Fax: (301) 924-5872

**LOCATION DRAWING**  
PARCEL 568  
**N. HALF 13 G&S ADDITION TO QUINCE ORCHARD**

L.10862 F.137  
(6TH) ELECTION DISTRICT  
MONTGOMERY COUNTY, MARYLAND

16



# Water Service Area Categories Map WSSCR 05A-DNT-01 (Ida Green)

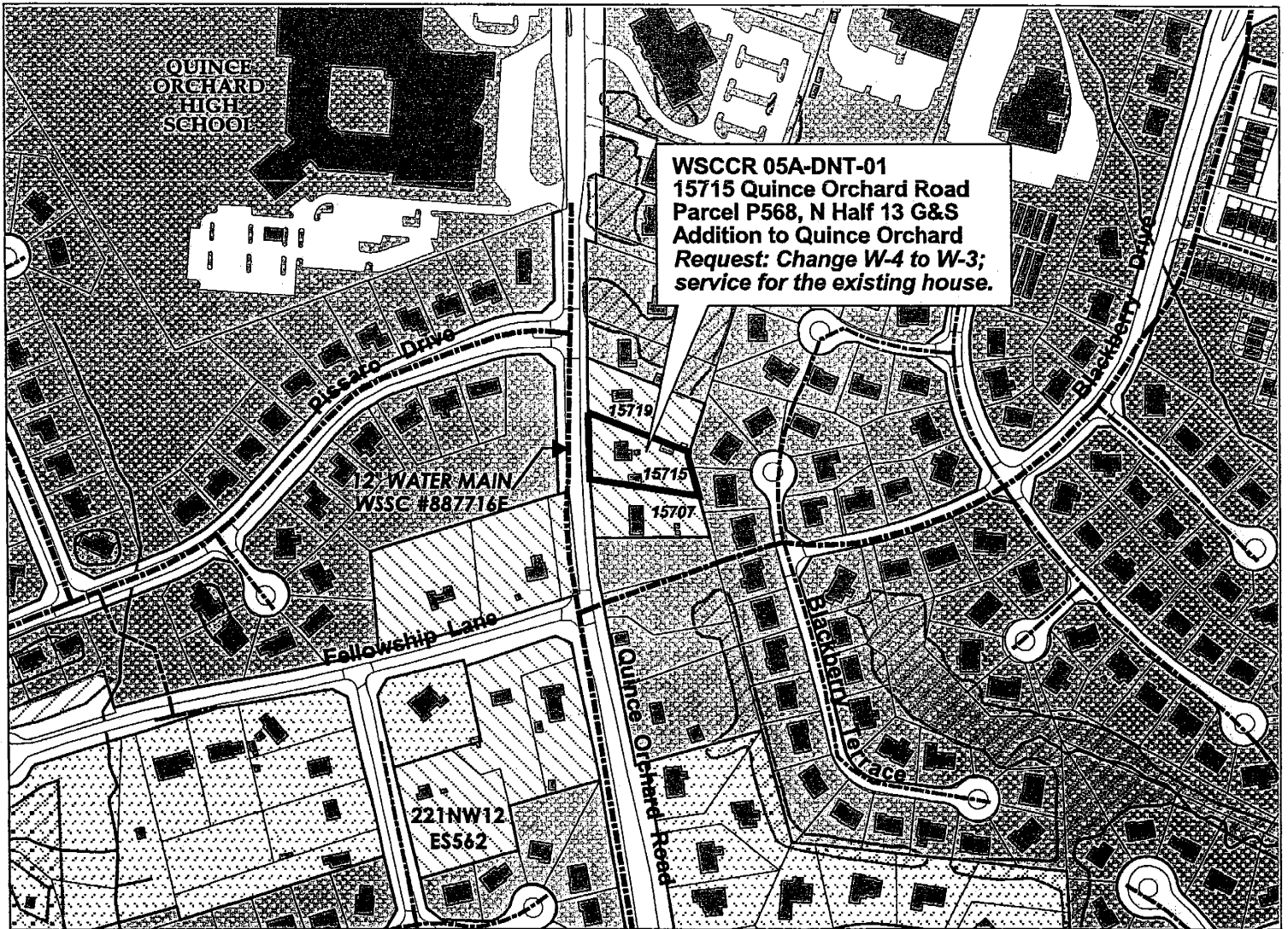

**WSSCR 05A-DNT-01**  
**15715 Quince Orchard Road**  
**Parcel P568, N Half 13 G&S**  
**Addition to Quince Orchard**  
**Request: Change W-4 to W-3;**  
**service for the existing house.**

Darnestown Planning Area map tile: 221NW12 - ES562 Muddy Branch Watershed



**MAP LEGEND**

- Property (Apr. 2005)
- Water Mains**
- 8"- or Smaller-Dia. Mains
- 10" to 15"-Dia. Mains
- 16"- to 24"-Dia. (CIP) Mains
- 30",- to 42"-Dia. (CIP) Mains \*
- 48"- or Larger-Dia. (CIP) Mains \*
- \* No Individual Connections
- WSSC/GIS Tile Grid
- Buildings
- Roads
- Streams
- Ponds - Lakes
- Woodlands
- Water Service Area Categories**
- W-1
- W-3
- W-4
- W-5
- W-6

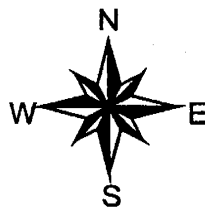

June 2003 Update  
Service Area Categories Map

Montgomery County, Maryland  
Comprehensive Water Supply  
and Sewerage Systems Plan

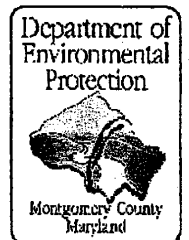

Water & Wastewater Planning  
 7/25/05 -- GIS Project File:  
 o:\wwteam\ccrs-pas\darnestown\  
 2005ccrs\05a-dnt-01=green=ws.apr

# Sewer Service Area Categories Map WSSCR 05A-DNT-01 (Iida Green)

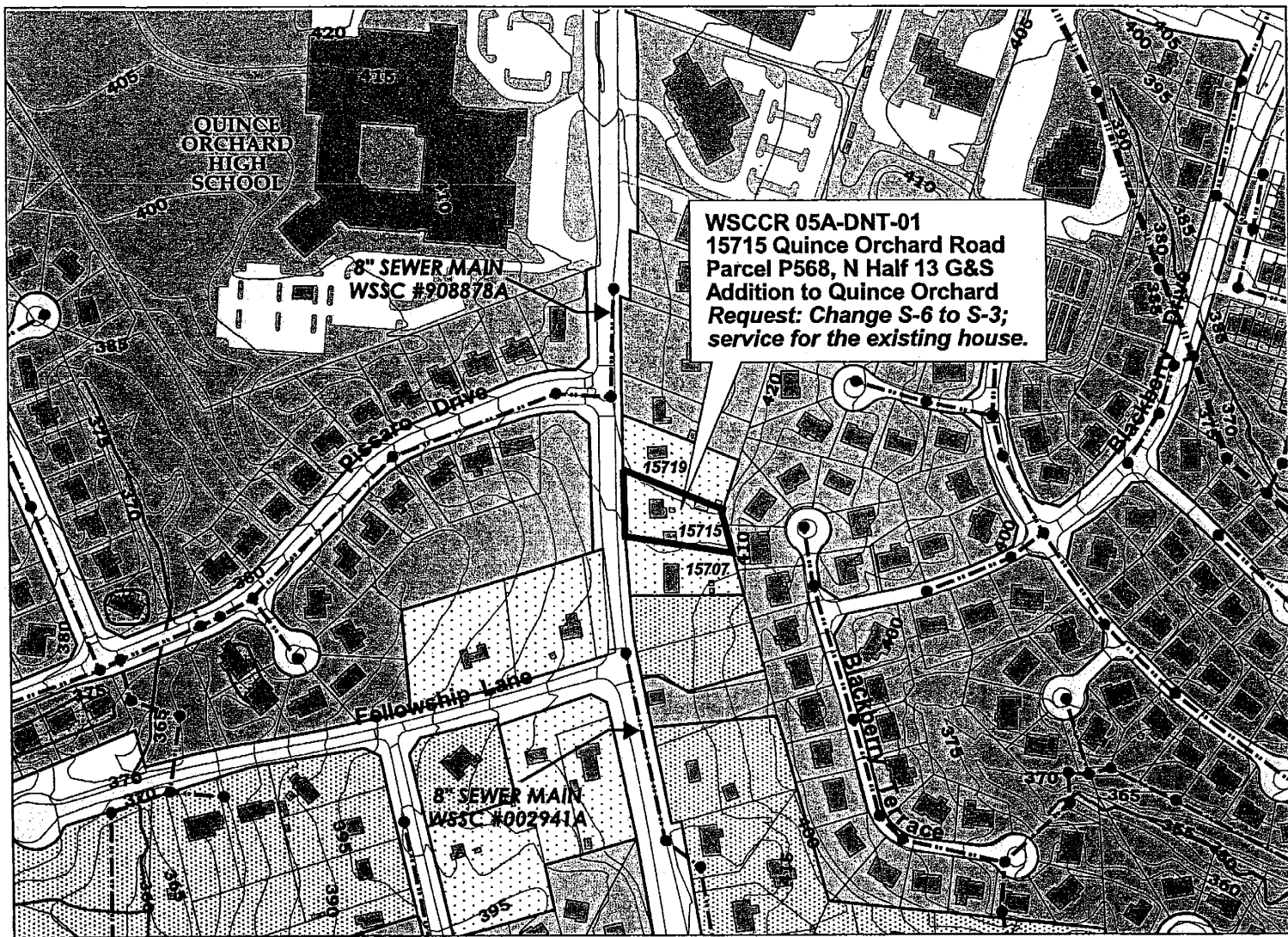

Darnestown Planning Area

map tile: 221NW12 - ES562

Muddy Branch Watershed

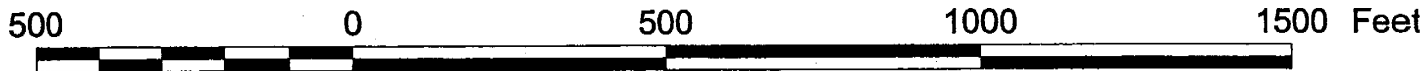

## MAP LEGEND

- Property (Apr. 2005)
- Sewer Mains**
- Small-Diameter, Low-Pressure Mains
- 6"- to 8"-Diameter Gravity Mains
- 10"- to 14"-Diameter Gravity Mains
- 15"- to 18"-Diameter (CIP) Trunk Mains
- 20"- to 42"-Dia. (CIP) Mains \*
- 48"- or Larger-Diameter (CIP) Trunk Mains \*
- \* No Individual Connections
- Sewer Manholes
- Topography (C.I. = 5 Feet)
- Buildings
- Roads
- Streams
- Ponds - Lakes

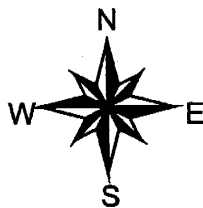

## Sewer Service Area Categories (6/03)

- S-1
- S-3
- S-4
- S-5
- S-6

June 2003 Update  
Service Area Categories Map

Montgomery County, Maryland  
Comprehensive Water Supply  
and Sewerage Systems Plan

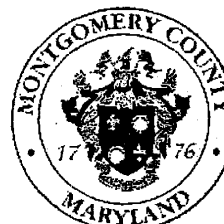

Water and Wastewater Planning  
7/25/05 -- GIS Project File:  
o:\wwteam\ccrs-pas\darnestown\  
2005ccrs\05a-dnt-01=green=ws.apr

18