

## **ATTACHMENT L**

**Site aerial photograph (after forest clearing) and reference information,  
September 2005, Aerials Express**

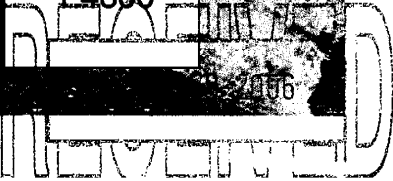

General Address  
Aerial Photo, September 2005



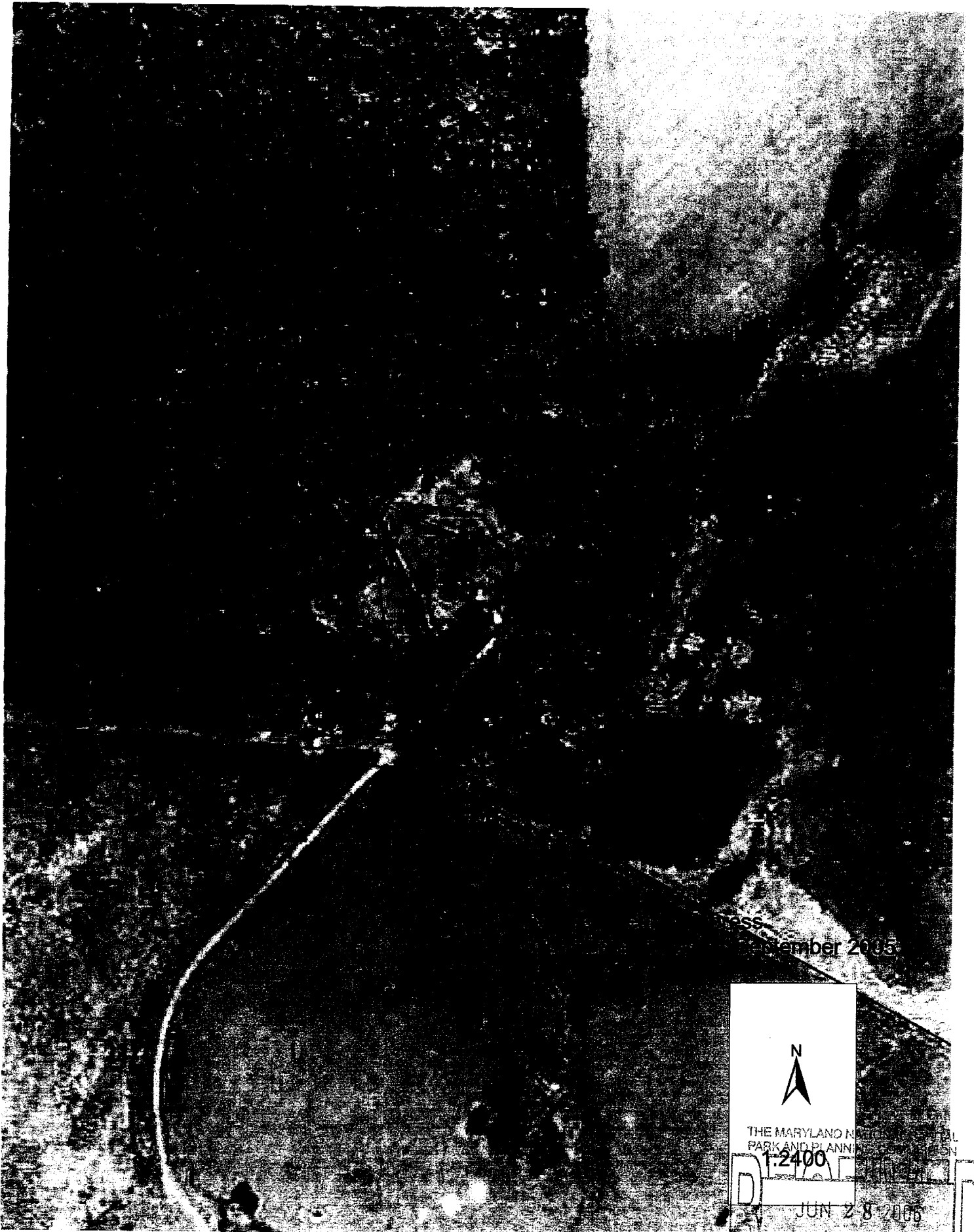

cross  
September 2005

N

THE MARYLAND NATURAL AND HISTORICAL  
PARK AND PLANNING  
1-2400

JUN 28 2005

**Bunnag, Candy**

---

**From:** Schlee, John  
**Sent:** Wednesday, June 21, 2006 11:59 AM  
**To:** Bunnag, Candy  
**Subject:** FW: Aerials Express - reply to your email

The info on the images. This applies to both images.

-----Original Message-----

**From:** David Guidera [mailto:dguidera@Aerials-Express.com]  
**Sent:** Wednesday, June 21, 2006 11:28 AM  
**To:** Schlee, John  
**Subject:** Aerials Express - reply to your email

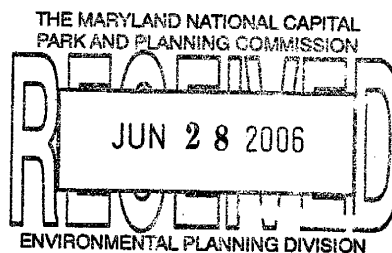

John -

The date information on our web site for our Washington DC/Baltimore is incorrect. The actual flight date was late September 2005 not December 2005. Sorry for the incorrect information.

If you would like to learn more about the expanded version of the web site you used and/or or DVD product, please give me a call at 888-482-2336 or drop me an email.

David J. Guidera  
National Sales  
AERIALS EXPRESS  
888-482-2336



## Bunnag, Candy

**From:** Schlee, John  
**Sent:** Monday, June 19, 2006 11:42 AM  
**To:** Bunnag, Candy  
**Subject:** RE: aerial photos

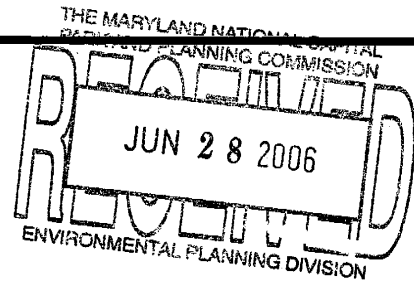

Candy,

Checked out Aerial express. Needed to install a plug-in, but got some basic info. Here are the specs they have for 17900 trundle. Looks like it may be fuzzy like the USDA image (1.5 foot resolution). They list the image at ~ \$75 for an 8x10 image covering a large area without a fixed date in December 2005.

http://63.241.168.238 - Image Specifications - Microsoft Internet Explorer

Image Specifications	
Area	Washington
State/Region	DC
Type	AerialExpress Full Color Seamless Mosaic
Photography Date	2005-12
Total Area	10970 sq miles
Resolution	30 Meters
Altitude Flown	12500 ft
Projection	UTM-18

Close Window

Done Internet

Google Earth is a fun toy, but the resolution in remote areas is limited, and I believe this site is very fuzzy.

Sorry, no help in your current quest for the perfect before/after pictures.

# **ATTACHMENT M**

**Maryland Department of the Environment (MDE) field reports**

**Maryland Department of the Environment  
Western Division - Hagerstown  
33 West Franklin Street  
Suite 302  
Hagerstown, MD 21740**

**Field Inspection Report by:** Rich Wolters

**Permit / Approval Numbers:**

**Inspection Date:** 11/18/2005

**Facility Address:** 17900 Trundle Road  
Dickerson, MD 20842

**Site Name:** PAF 06-1090 17900 Trundle  
Road

**Site Status:** Currently Inactive

**Permit Type:** Non-Tidal Wetlands

**Site Condition:** Noncompliance

**Contact(s):** Anthony Mereos, Owner  
Bill Limpert, MDE/WMA  
Compliance  
Bob Cooper, MDE/WMA  
NTW&W

**Recommended Action:** Continue routine investigation  
Issue complaint & order  
Refer to Division Chief

**Evidence Collected:** VISUAL OBSERVATION

**Inspection Reason:** PAF Follow-up

**Follow-up for PAF#:** 06-1090

### INSPECTION FINDINGS

Investigation conducted on 11/17/05 at subject site with above referenced individuals to re-evaluate site and determine whether property clearing and grading has impacted any regulated/jurisdictional nontidal wetlands. An initial site investigation was completed on 9/23/05 during dry weather conditions and with no representative vegetation remaining to identify because of site grading. A further review of the National Wetlands Inventory Map, Montgomery County Soil Survey, and field analysis completed on 11/17/05 (of soils, vegetation, and hydrology) indicate that Mr. Mereos' property is indeed a regulated nontidal wetland. Site is currently in violation of Title 5 of The Annotated Code of Maryland Environment Article for conducting unauthorized work in a nontidal waterway, and for conducting a regulated activity in a nontidal wetland without a permit - specifically clearing and grading over an acre of nontidal wetlands. These referenced violations of Title 5 of the Environment Article carry both Civil and Criminal Penalties. Previously disturbed area is now encompassed with silt fence and has been stabilized. However, site needs to be restored to its original (pre-site grading and clearing) condition. This needs to be accomplished by initially having nontidal wetlands, nontidal wetland buffers and the 100-year floodplain delineated throughout the site by a qualified consultant. A site restoration plan needs to be submitted to MDE Water Management Administration Nontidal Wetlands and Waterway Division's Permits Section within 60 days for review. Restoration plan should be drafted by a qualified consultant. Plan will need to address; bringing disturbed site back to original grade/elevations - to include the stream channel, replanting site with representative plant species that were removed during clearing/grading operation in conjunction with Maryland National Capital Parks and Planning Commission requirements, and the removal of trees piled up in the stream channel from site clearing and grubbing operation. No further work is to be conducted in the regulated area until all violations have been resolved and all appropriate permits have been obtained.

**Permit / Approval Numbers:**

**Inspection Date:** 11/18/2005

**Facility Address:** 17900 Trundle Road  
Dickerson, MD 20842

Be advised that MDE/WMA will review this incident and forward it to its Enforcement Division for possible action.

Inspector: Richard Walters  
Rich Walters

Received by: [Signature]

Maryland Department of the Environment  
Western Division - Hagerstown  
33 West Franklin Street  
Suite 302  
Hagerstown, MD 21740

Field Inspection Report by: Rich Wolters

Permit / Approval Numbers:

Inspection Date: 1/30/2006

Facility Address: 17900 Trundle Road  
Dickerson, MD 20842

Site Name: PAF 06-1090 17900 Trundle Road

Site Status: Active - No work today

Permit Type: Non-Tidal Wetlands

Site Condition: Noncompliance

Contact(s): Anthony Mereos, Owner  
Rick Watson, MO CO DPS  
Tracey McCleaf, US ACOE

Recommended Action: Refer to Division Chief

Inspection Reason: Violation Follow-up

Evidence Collected: VISUAL OBSERVATION

Follow-up for Viol. #: 06-1090

**INSPECTION FINDINGS**

Inspection this date on subject complaint site conducted in response to citizen's concerns that dirt is being brought onto Mr. Mereos' property and spread without authorization. My investigation today finds this to be the case. Photo numbers 1, 2, 3, and 4 show that approximately four to six truckloads of dirt have been brought onto Mr. Mereos property and spread. Mr. Mereos property is a regulated nontidal wetland and the site is not approved for any site disturbance or fill operation. I contacted and spoke with Mr. Mereos who stated that he did not advise anyone to bring dirt onto his property. I also contacted the owner of the Bobcat loader that was sitting on Mr. Mereos property to try and determine responsible parties, however, I could only leave a message on the answering machine. Project was previously sited for violations of Title 5-906 of the Annotated Code of Maryland, Environment Article for conducting regulated activity in a nontidal wetland without a permit. The current on site fill operation constitutes an additional violation of the Environment Article referenced above. All recently deposited material needs to be removed from site and taken to a location approved for erosion and sediment control. Be advised that Maryland Department of the Environment, Water Management Administration will review these violations and forward them to its Enforcement Division for possible action.

Inspector: Rich Wolters  
Rich Wolters

Received by: [Signature]

**MARYLAND DEPARTMENT OF THE ENVIRONMENT**

1800 Washington Boulevard ● Baltimore Maryland 21230 -1708  
 (410) 537-3000 ● 1-800-633-6101 ● <http://www.mde.state.md.us>

**SITE COMPLAINT**

SITE COMPLAINT NUMBER: SC-O-06-0233

Date issued: 01/31/06

NAME OF VIOLATOR: Anthony Mereos

ADDRESS: P.O. Box 206

CITY: Poolesville MD 20837-0206

TELEPHONE: 301-518-4735

FACILITY NAME : Anthony Mereos property, 17900 Trundle Road, Dickerson MD 20842

PERMIT:

VIOLATION TYPE: Non-tidal Wetlands; Article – Environment, Section 5-906.  
 Waters & Waterway; Article – Environment, Section 5-503

SPECIFICALLY: Cleared and grubbed trees were pushed and piled into a stream channel, stream channel depth has been altered (excavated). A regulated nontidal wetland in excess of an acre in area was cleared, grubbed, and graded without having permit approval. Imported dirt has been brought onto site and spread in the regulated non-tidal wetland area. All site work/disturbance in the 100-year floodplain, non-tidal wetlands, and non-tidal wetlands buffer areas was conducted without required authorization.

YOU ARE HEREBY ADVISED THAT THE FOLLOWING CORRECTIVE ACTIONS ARE NEEDED. COMPLIANCE WITH THE CORRECTIVE ACTIONS CONTAINED HEREIN DOES NOT PRECLUDE THE DEPARTMENT FROM IMPOSING FURTHER REQUIREMENTS. IN ADDITION, THE DEPARTMENT RESERVES THE RIGHT TO IMPOSE SANCTIONS OR PENALTIES FOR THE UNDERLYING VIOLATION(S).

Have regulated nontidal wetlands, nontidal wetland buffers, and 100-year floodplain delineated throughout the site in order to implement a site restoration plan. Generate site restoration plan by a qualified consultant and submit it for review to the Maryland Department of the Environment Nontidal Wetlands and Waterway Division within 60 days. Restoration plan should address bringing disturbed site back to original grade/elevations – to include stream channel, replanting site with representative plant species that were removed during clearing/grading operation in conjunction with Maryland National Capital Parks and Planning Commission's requirements, and the removal of trees piled up in the stream channel from site clearing and grubbing operation. Also, remove imported dirt from site. No further work is to be conducted in the regulated area until all violations have been resolved and all appropriate permits have been obtained.

THE ABOVE DESCRIBED VIOLATION(S) MAY RESULT IN THE DEPARTMENT SEEKING LEGAL SANCTIONS AGAINST YOU, INCLUDING THE IMPOSITION OF CIVIL AND/OR CRIMINAL PENALTIES. CONTINUATION OF THE VIOLATION(S) OR FAILURE TO TAKE THE CORRECTIVE ACTIONS DESCRIBED ABOVE MAY RESULT IN ADDITIONAL SANCTIONS OR PENALTIES FOR THE UNDERLYING VIOLATION(S).

PLEASE BE ADVISED THAT YOU ARE ENTITLED TO A HEARING BEFORE THE ADMINISTRATION AS A RESULT OF THIS ORDER. IF YOU WISH TO SCHEDULE A HEARING ON THIS MATTER, THE ADMINISTRATION MUST BE SO NOTIFIED IN WRITING WITHIN TEN (10) DAYS.

"I HEREBY ACKNOWLEDGE RECEIPT OF THIS SITE COMPLAINT BY MY SIGNATURE, WHICH IS NOT AN ADMISSION OF GUILT."

PERSON ISSUED TO:

TITLE: Owner

ISSUED BY:

PHONE: 301-665-2893

Richard Walters  
 Inspector Name

AUTHORIZED BY: Kendi P. Philbrick  
 Secretary  
 Department of the Environment

Maryland Department of the Environment  
Western Division - Hagerstown  
33 West Franklin Street  
Suite 302  
Hagerstown, MD 21740

Field Inspection Report by: Rich Wolters

Permit / Approval Numbers:

Inspection Date: 4/7/2006

Facility Address: 17900 Trundle Road  
Dickerson, MD 20842

Site Name: PAF 06-1090 17900 Trundle  
Road

Site Status: Active - No work today

Permit Type: Non-Tidal Wetlands

Site Condition: Corrections needed

Contact(s): Anthony Mereos, Owner

Recommended Action: Continue routine investigation

Evidence Collected: VISUAL OBSERVATION

Inspection Reason: Follow-up(Non-Compliance)

### INSPECTION FINDINGS

Inspection this date on subject site conducted as a follow-up to a site meeting on 3/21/06 where the sequence of operations for tree removal from the waterway was discussed. Currently, the majority of all trees have been removed from the waterway and hauled off site. The access road was extended to the existing silt fence along the west end of the site for access. Several wood chip piles have been established throughout the tree removal area for final stabilization once operation has been completed. All that remains to be removed from previously piled trees is stump and root material. Mr. Mereos called and advised on 4/5/06 that the operator's equipment had broken down and that the operator will be back in three to four days to complete the work. To complete this portion of the site restoration work (tree removal from the waterway), remove remaining stump and root material from the site, spread wood chips over disturbed area from tree piling and removal operations, and remove stone and filter fabric that was placed for site access. I will continue follow-up investigations.

Inspector: \_\_\_\_\_

*R. Wolters*  
Rich Wolters

Received by: \_\_\_\_\_

*Forward to Anthony Mereos 5/1/06  
RW*

## **ATTACHMENT N**

**Site photographs, June 28, 2006, M-NCPPC Environmental Planning,  
Countywide Planning Division**



6/28/06

Josh Penn  
Planner  
Environmental Planning  
MNCPPC

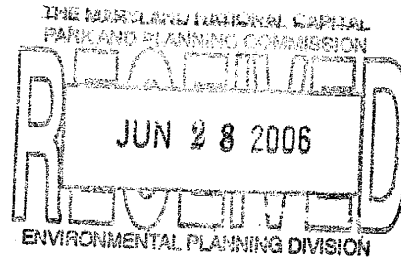

I visited 17900 Trundle Road at 2:30pm. Upon arriving at the site I proceeded to take 35 various pictures of the area. Photos #1-#6 are an overlapping panorama of the site. The Various pictures of forest with understory were taken just outside the clearing area perpendicular to the site access driveway.

The included map shows where these pictures were taken:

Letter A indicates the point where photographs #1-11 were taken. The first six pictures show an overlapping panorama view from the site entrance off of Trundle Road.

Letter B indicates the point where photographs #12-16 were taken. These pictures were taken at the edge of the clearing beyond the property line.

Letter C indicates the area where photographs #17-24 were taken. These pictures were take around an open wood chipped area.

Letter D indicates the area where photographs #25-29 were taken. These pictures were taken following a curved line between a fallen tree and the stream.

Letter E indicates the area where photographs #30-32 were taken. These pictures were taken following a line along the stream towards where the stream exits the property on the southern side.

Letter F indicates the area where photographs #33-35 were taken. These pictures were taken from the interior of the site facing the access road to the property..



---

Josh Penn  
Planner  
Environmental Planning  
MNCPPC

17900 Trundle Road  
from M-NCPPC GIS database

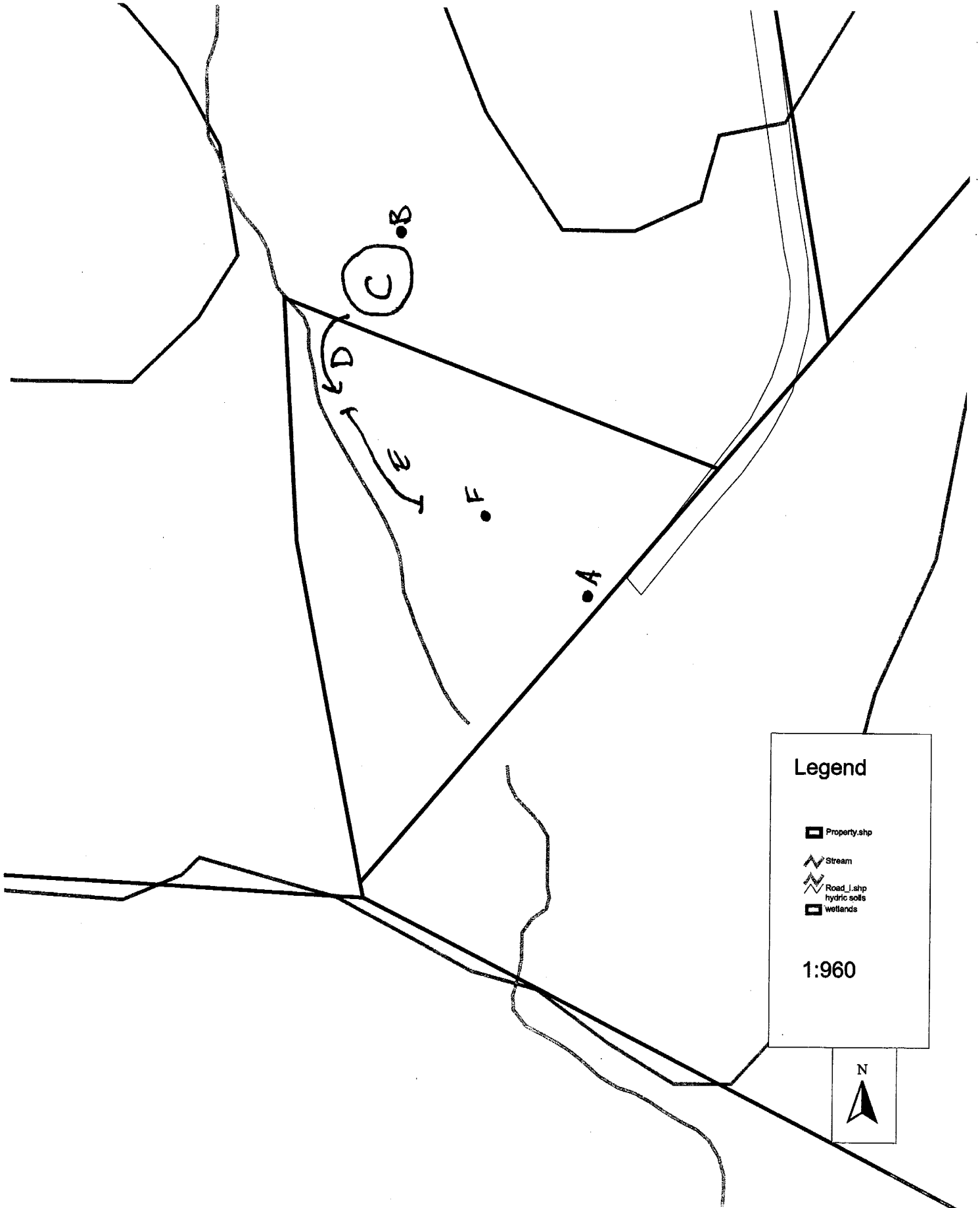

Legend

- Property.shp
- Stream
- Road\_1.shp
- hydric soils
- wetlands

1:960

N

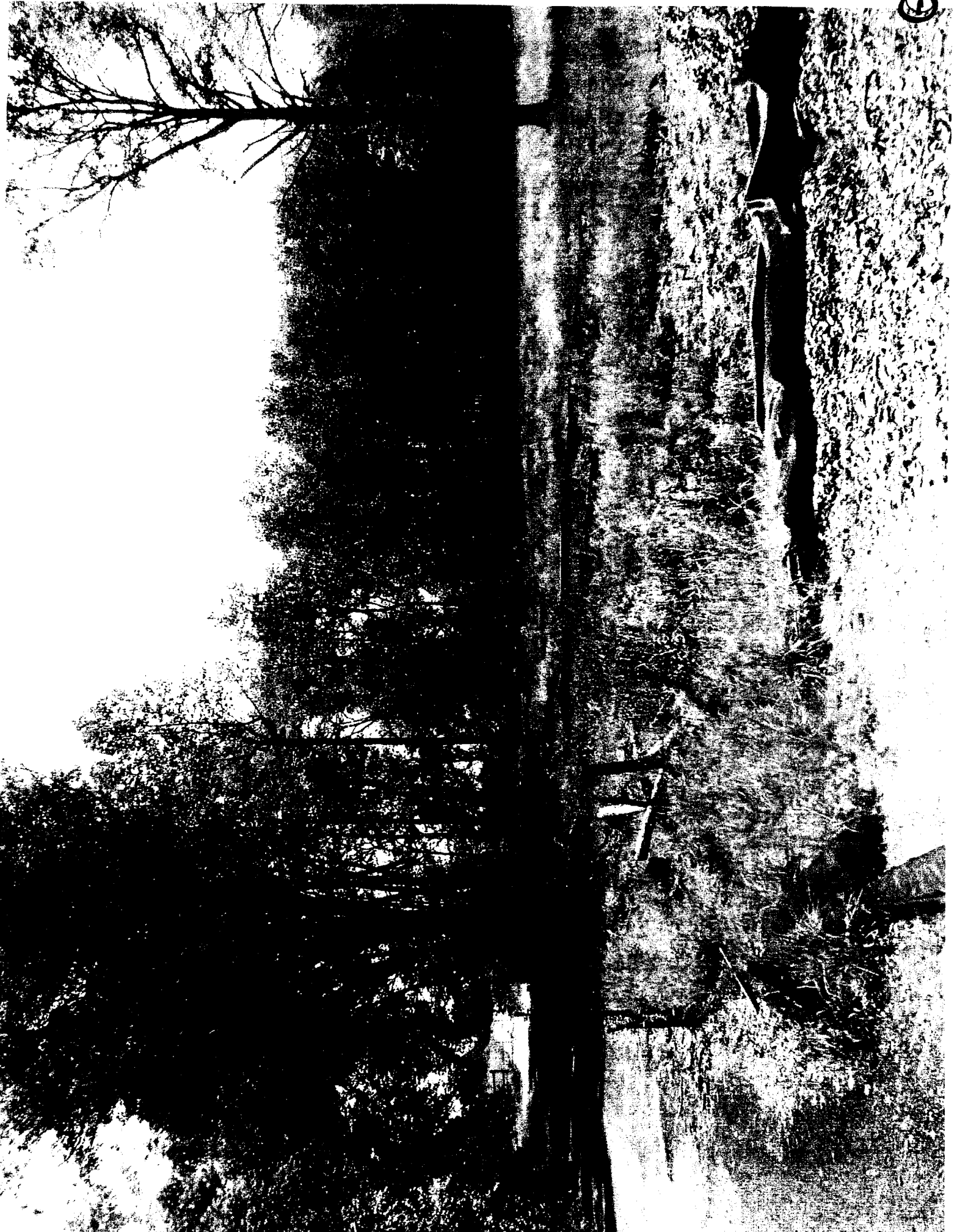





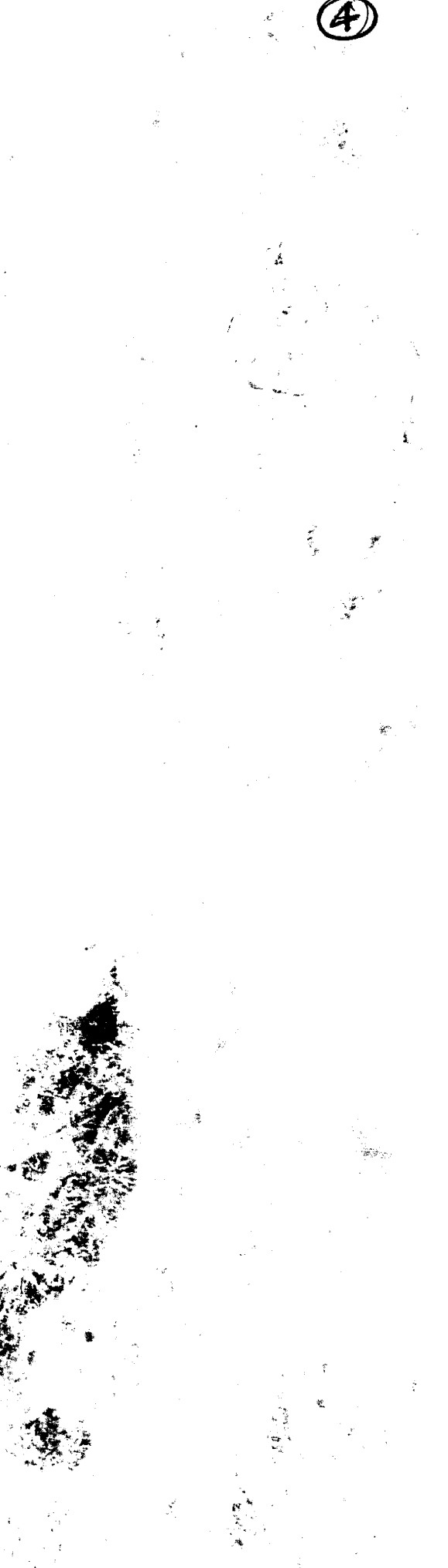









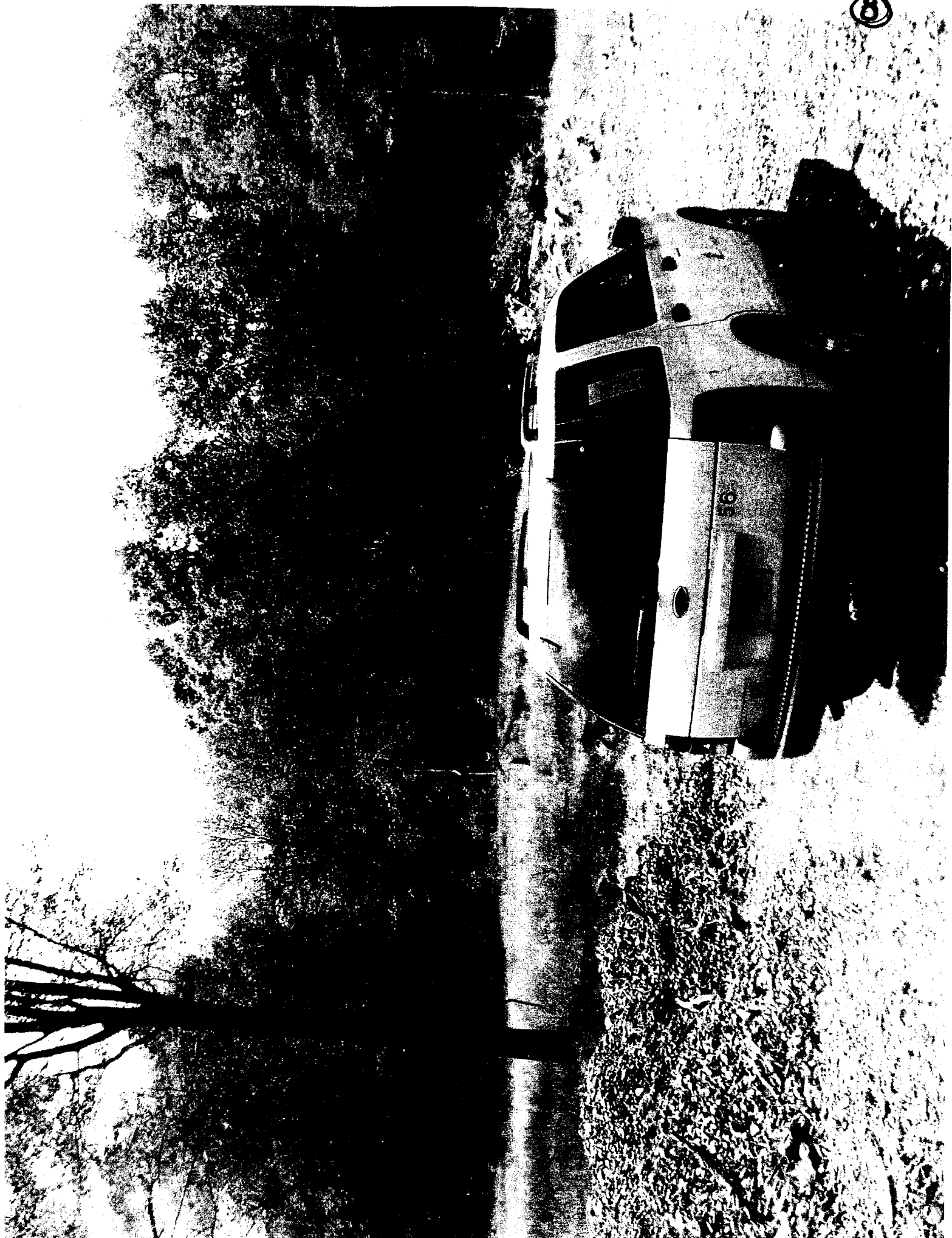

9





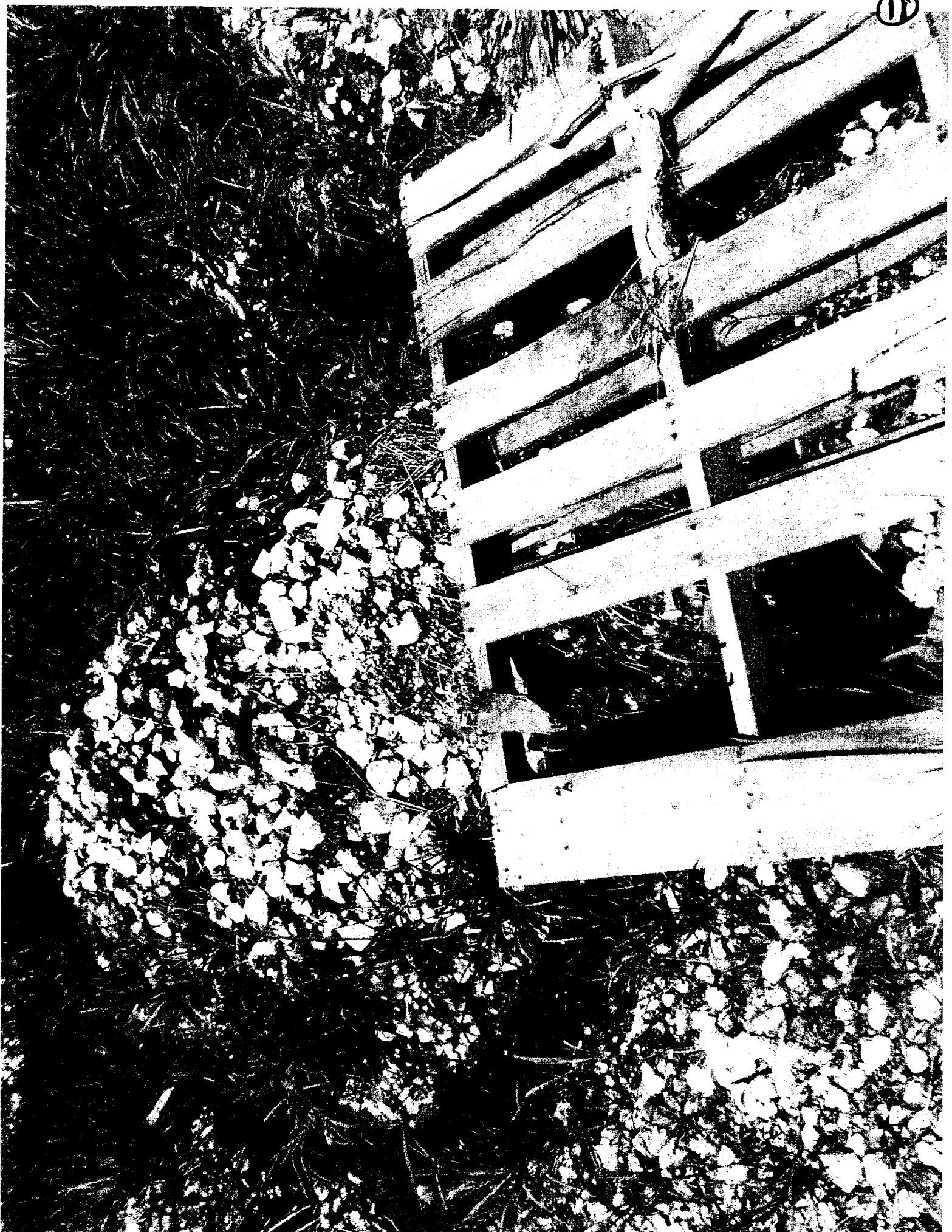





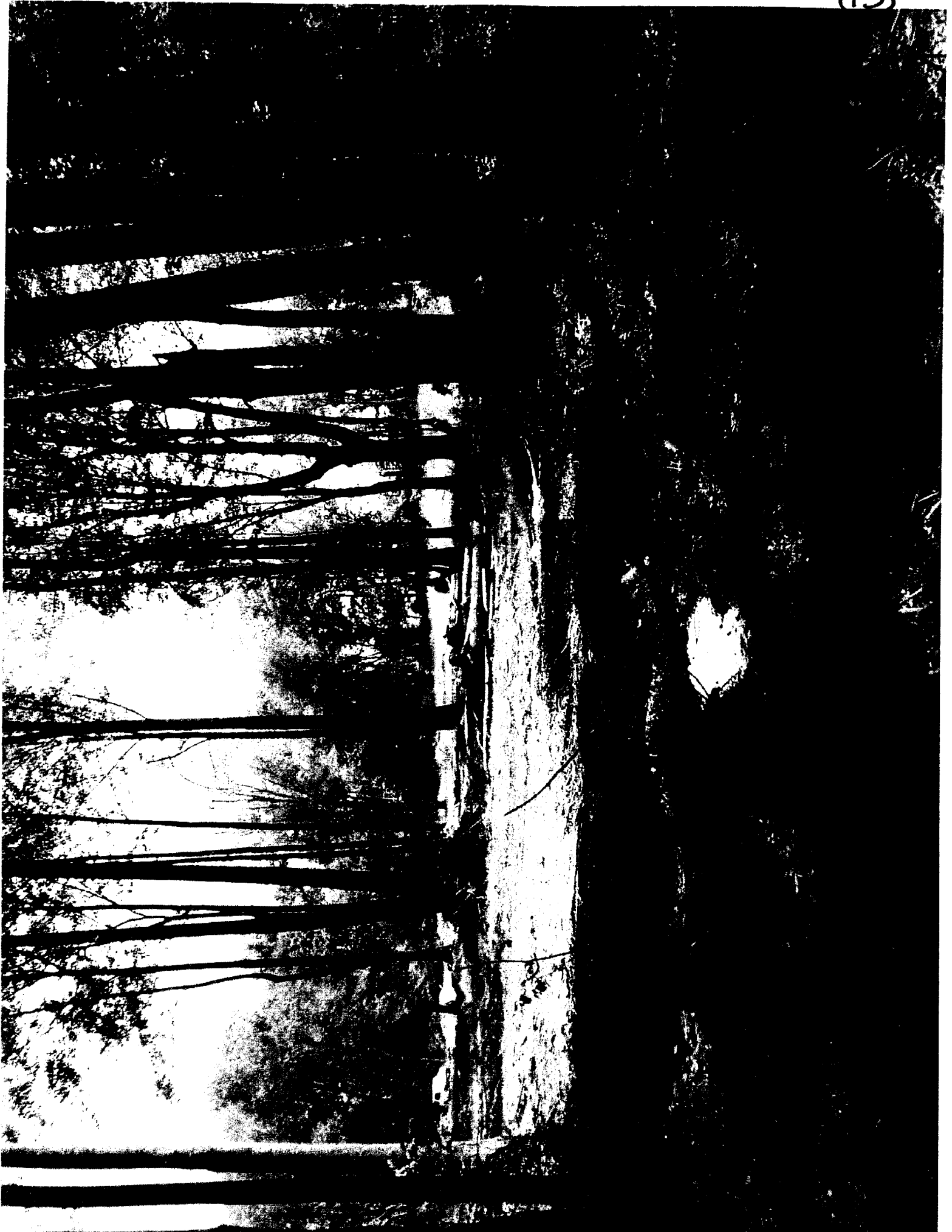















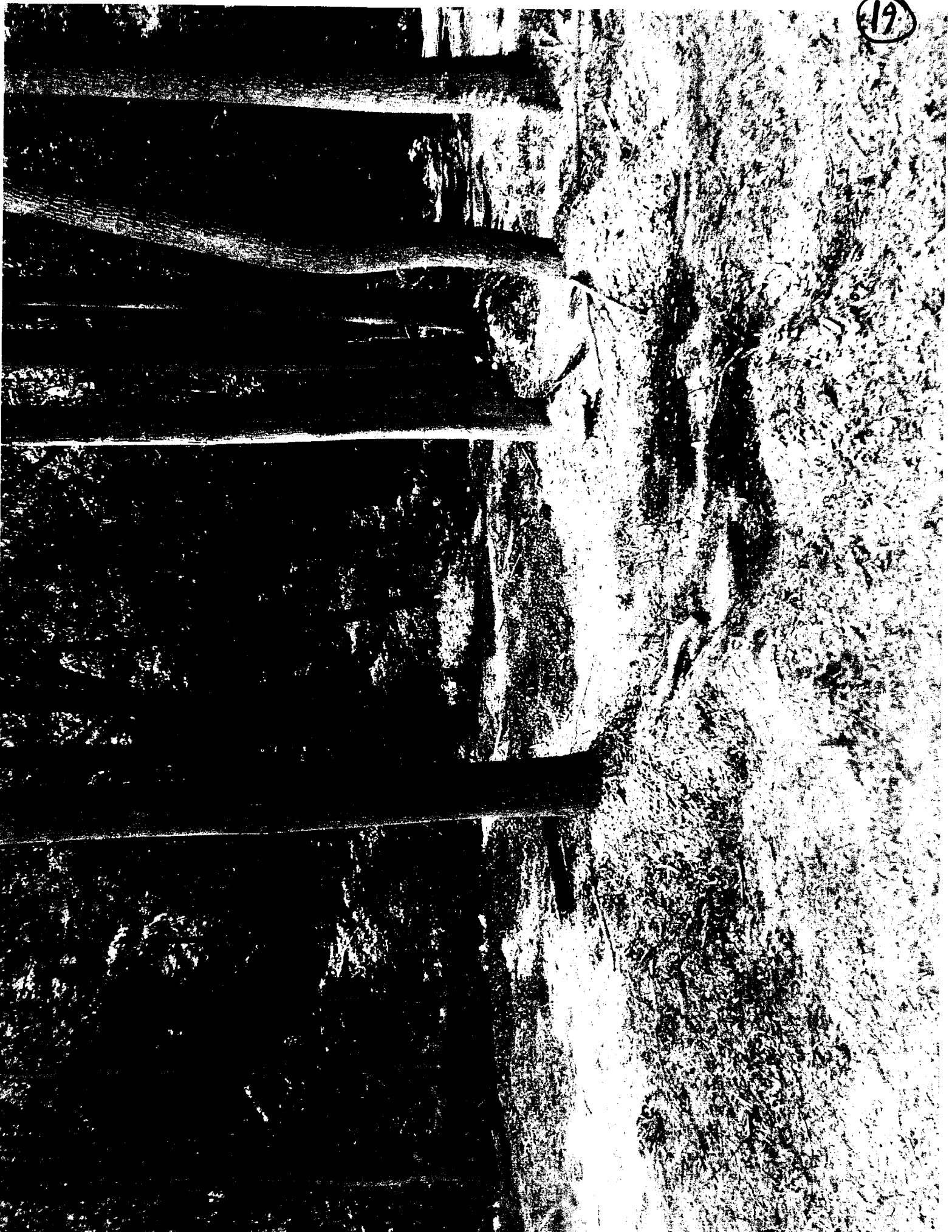



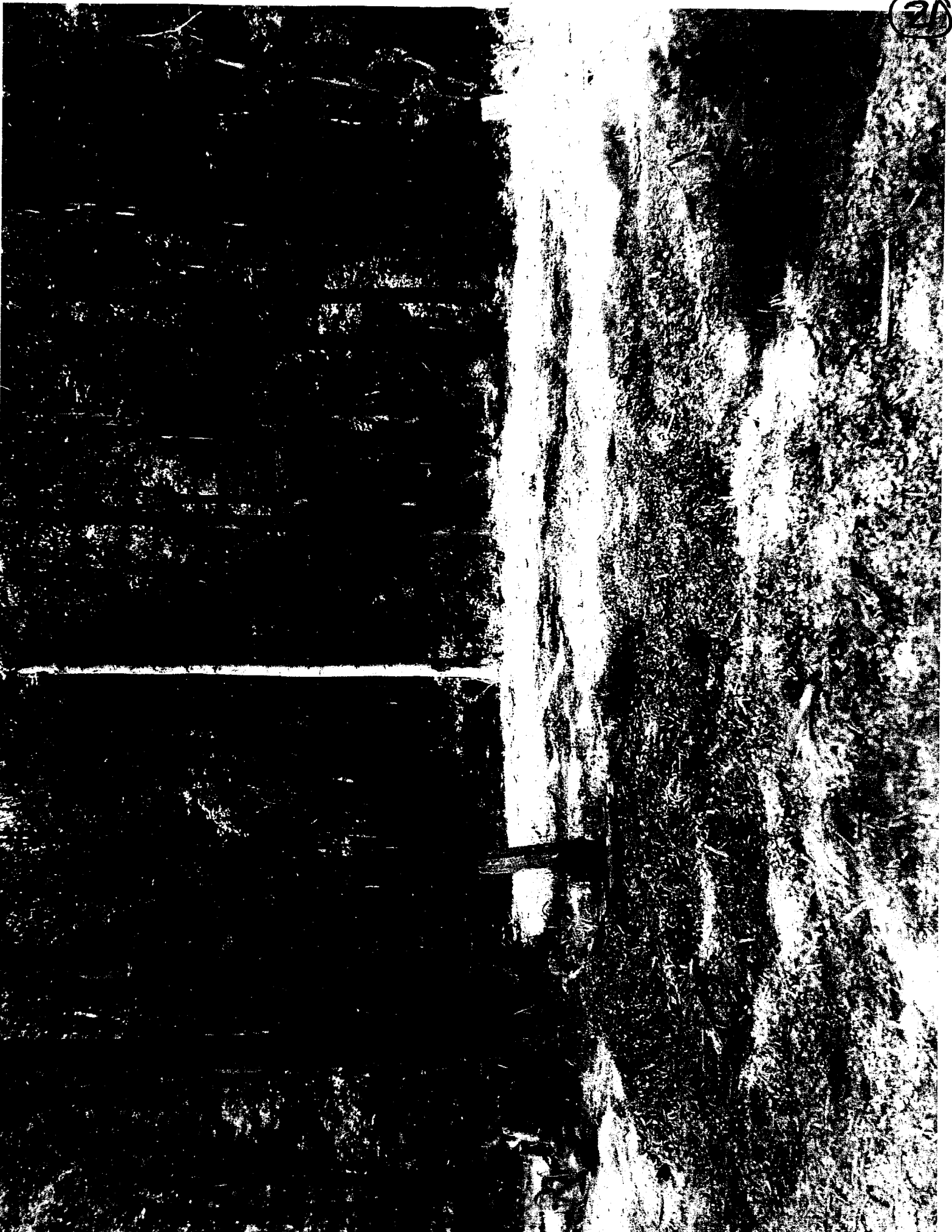















27





29







31



(32)



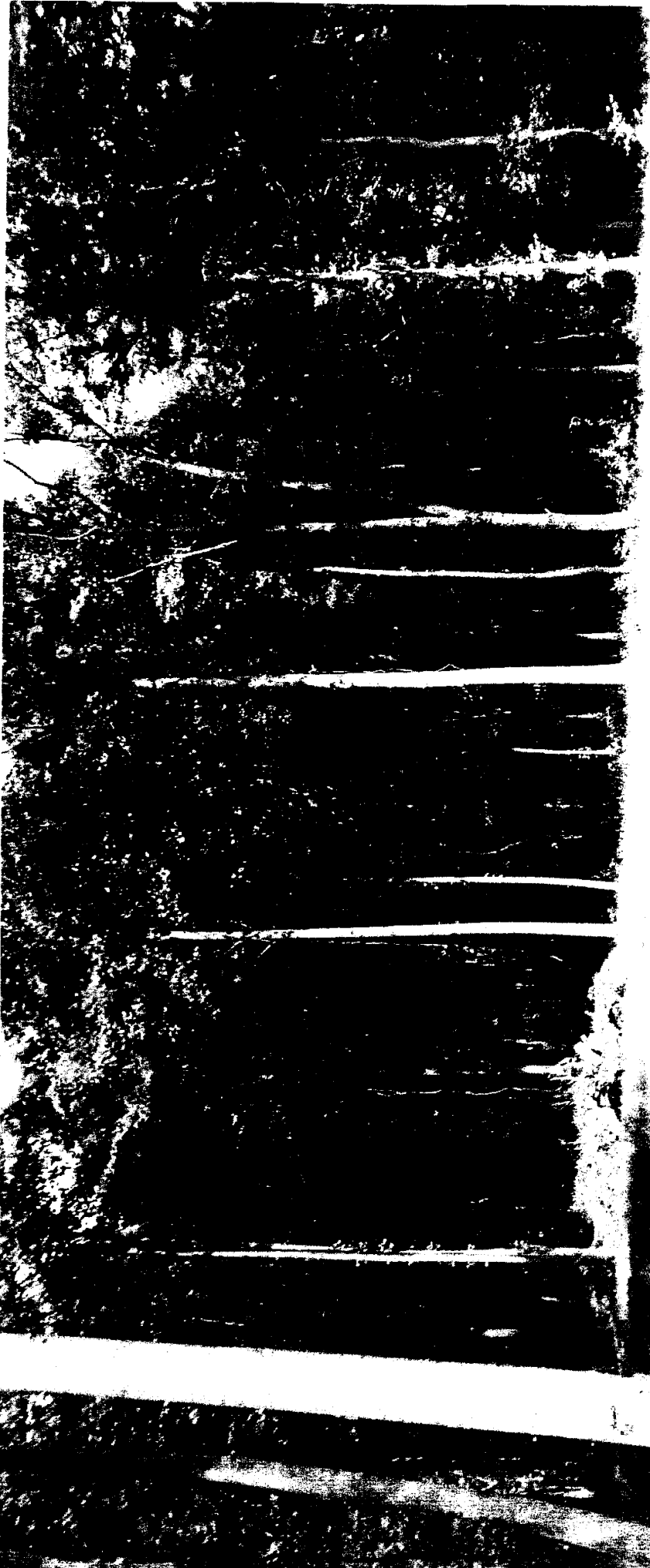

34





