

Plat Name: Martinis Property

Plat #: 220170100

Location: Located on the north side of Seneca Road (MD 112), 650 feet east of Oxmoor Place

Master Plan: Potomac Subregion Master Plan

Plat Details: RC zone, 1 lot

Owners: Eric and Anjanette Martinis

This subdivision plat has been reviewed by M-NCPPC staff and determined to be in conformance with Preliminary Plan No. 12005050A (MCPB Resolution No. 16-042), as approved by the Board, and that any minor modifications reflected on the plat do not alter the intent of the Board's previous approval of the aforesaid plan.

- LEGEND**
- EXISTING TREE LINE
 - DOMINANT TREE
 - SPECIMEN TREE
 - SOLID LINE
 - WELL AND/OR WELL ROADS
 - EXISTING SPECIES TREE TO BE SAVED
 - EXISTING SPECIES TREE TO BE REMOVED
 - EXISTING SPECIES TREE TO BE PRESERVED
 - EXISTING SPECIES TREE TO BE REPLANTED
 - PROPOSED SPECIES TREE TO BE SAVED
 - PROPOSED SPECIES TREE TO BE REMOVED
 - PROPOSED SPECIES TREE TO BE REPLANTED
 - PROPOSED SPECIES TREE TO BE PRESERVED
 - PROPOSED SPECIES TREE TO BE REPLANTED ON-SITE
 - PROPOSED SPECIES TREE TO BE REPLANTED OFF-SITE

- APPROVED SPECIES
- APPROVED SPECIES TO BE SAVED
- APPROVED SPECIES TO BE REMOVED
- APPROVED SPECIES TO BE REPLANTED
- APPROVED SPECIES TO BE REPLANTED ON-SITE
- APPROVED SPECIES TO BE REPLANTED OFF-SITE
- APPROVED SPECIES TO BE PRESERVED
- APPROVED SPECIES TO BE REPLANTED OFF-SITE
- APPROVED SPECIES TO BE REPLANTED OFF-SITE
- APPROVED SPECIES TO BE REPLANTED OFF-SITE
- APPROVED SPECIES TO BE REPLANTED OFF-SITE
- APPROVED SPECIES TO BE REPLANTED OFF-SITE
- APPROVED SPECIES TO BE REPLANTED OFF-SITE
- APPROVED SPECIES TO BE REPLANTED OFF-SITE
- APPROVED SPECIES TO BE REPLANTED OFF-SITE
- APPROVED SPECIES TO BE REPLANTED OFF-SITE

- APPROVED SPECIES TO BE REPLANTED OFF-SITE
- APPROVED SPECIES TO BE REPLANTED OFF-SITE
- APPROVED SPECIES TO BE REPLANTED OFF-SITE
- APPROVED SPECIES TO BE REPLANTED OFF-SITE
- APPROVED SPECIES TO BE REPLANTED OFF-SITE
- APPROVED SPECIES TO BE REPLANTED OFF-SITE
- APPROVED SPECIES TO BE REPLANTED OFF-SITE
- APPROVED SPECIES TO BE REPLANTED OFF-SITE
- APPROVED SPECIES TO BE REPLANTED OFF-SITE
- APPROVED SPECIES TO BE REPLANTED OFF-SITE
- APPROVED SPECIES TO BE REPLANTED OFF-SITE
- APPROVED SPECIES TO BE REPLANTED OFF-SITE
- APPROVED SPECIES TO BE REPLANTED OFF-SITE
- APPROVED SPECIES TO BE REPLANTED OFF-SITE
- APPROVED SPECIES TO BE REPLANTED OFF-SITE
- APPROVED SPECIES TO BE REPLANTED OFF-SITE

PROJECT	DATE	BY	REVISION
04-050	12/2015		
PREPARED BY	DATE	BY	REVISION
EAT			
EAT			
EAT			
CAS	12/30/		

MARTIN'S PROPERTY
 LOT 1
 PLAT 22716, CIRCA 2005
 15215 SENECA ROAD, GERTANTOWN, MD 20714
 GERTANTOWN (411) ELECTION DISTRICT, MONTGOMERY COUNTY, MARYLAND
 PRELIMINARY PLAN AMENDMENT

COS ENGINEERING
 10 South Brent Street
 P.O. Box 211116
 Silver Spring, MD 20904
 301-427-2516
 www.cos-engineering.com
 CIVIL & SURVEYING - LAND PLANNING
 Experience you can build on!

APPPLICANT:
 MNCBPC 12005050A
 15215 SENECA ROAD
 LOT 1
 MARTIN'S PROPERTY
 PRELIMINARY PLAN - AMENDMENT

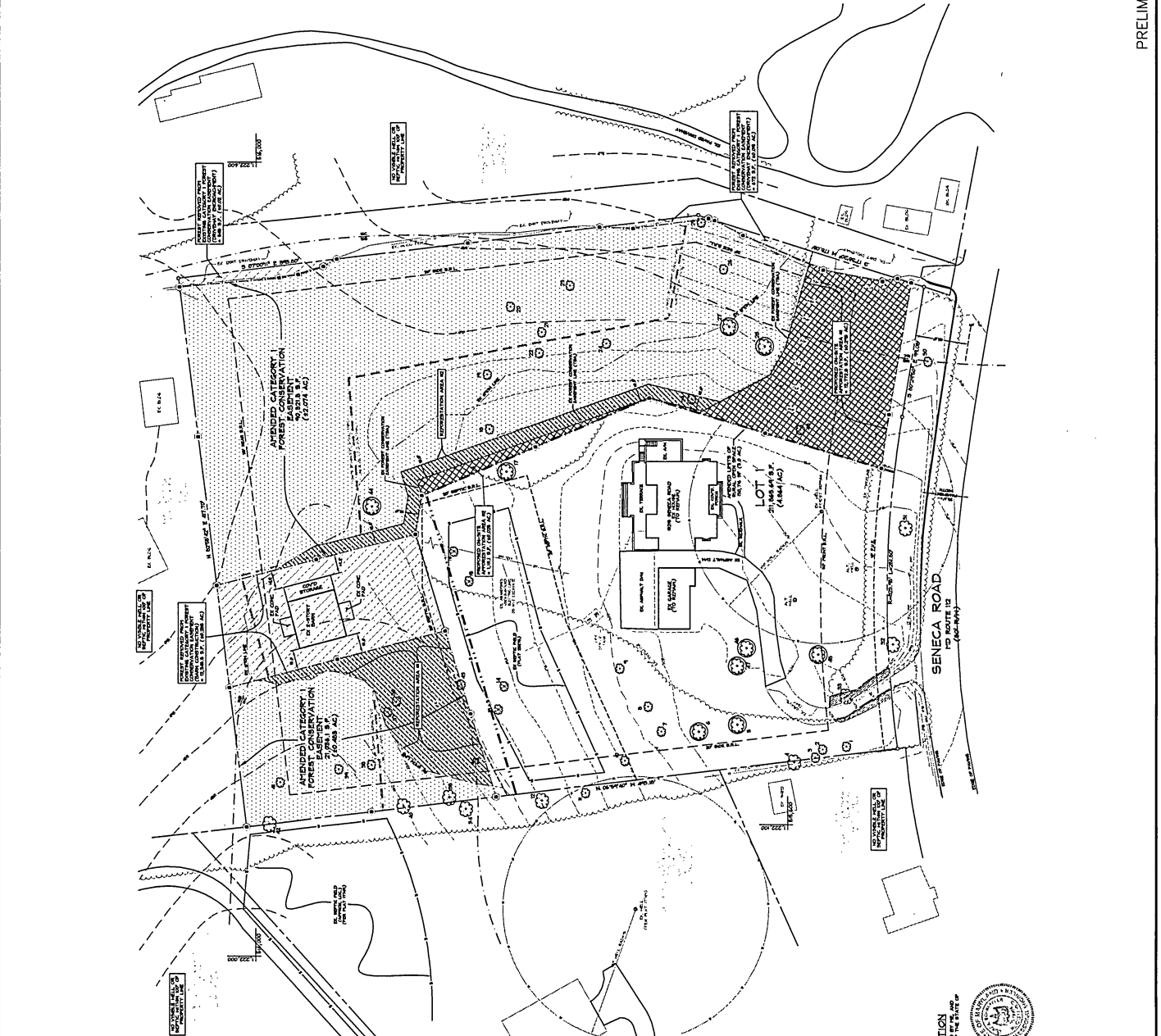

- MODIFICATIONS APPROVED BY THIS AMENDMENT**
1. REMOVE SMALLER TREES (SEE ALL OF EXISTING CATEGORY I FOREST AREA AND CATEGORY II FOREST AREA) FROM THE PROPERTY AND REPLANT OFF-SITE.
 2. REMOVE 10% OF EXISTING CATEGORY I FOREST AND REPLANT ON-SITE.
 3. REMOVE 10% OF EXISTING CATEGORY II FOREST AND REPLANT OFF-SITE.
 4. REMOVE 10% OF EXISTING SMALL, OPEN SPACE TO CONTRIBUTE TO THE PROPOSED CONSERVATION AREA.



GRAPHIC SCALE
 0' 25' 50' 75' 100'

MNCBPC 12005050A
 15215 SENECA ROAD
 LOT 1
 MARTIN'S PROPERTY
 PRELIMINARY PLAN - AMENDMENT