

Item #7



THE MARYLAND-NATIONAL CAPITAL PARK AND PLANNING COMMISSION

MEMORANDUM

DATE: November 27, 2002

TO: Montgomery County Planning Board

FROM: A. Malcolm Shaneman
Development Review Division
(301) 495-4587

SUBJECT: Informational Maps for Subdivision Items on the
Planning Board's Agenda for December 05, 2002.

Attached are copies of plan drawings for Items #05, #06, #07, #08. These subdivision items are scheduled for Planning Board consideration on December 05, 2002. The items are further identified as follows:

Agenda Item #05 - Preliminary Plan 1-87012A
Churchill Town Sector

Agenda Item #06 - Preliminary Plan 1-99100E
Cloverly Commercial

Agenda Item #07 - Preliminary Plan 1-03027
Valois Property

Agenda Item #08 - Preliminary Plan 1-03015
Calverton

Attachment

VICINITY MAP FOR

VALOIS PROPERTY: PROPOSED LOT 29 BLK. D (1-03027)



Map compiled on November 08, 2002 at 2:30 PM | Site located on base sheet no - 223NW01

NOTICE

The planimetric, property, and topographic information shown on this map is based on copyrighted Map Products from the Montgomery County Department of Park and Planning of the Maryland-National Capital Park and Planning Commission, and may not be copied or reproduced without written permission from M-NCPPC.

Property lines are compiled by adjusting the property lines to topography created from aerial photography and should not be interpreted as actual field surveys. Planimetric features were compiled from 1:14400 scale aerial photography using stereo photogrammetric methods.

This map is created from a variety of data sources, and may not reflect the most current conditions in any one location and may not be completely accurate or up to date. All map features are approximately within five feet of their true location. This map may not be the same as a map of the same area plotted at an earlier time as the data is continuously updated. Use of this map, other than for general planning purposes is not recommended. - Copyright 1998

Key Map

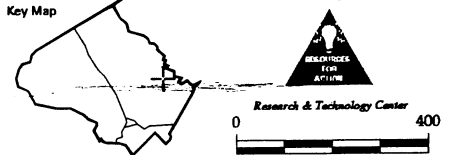

VICINITY MAP FOR

VALOIS PROPERTY: PROPOSED LOT 29 BLK. D (1-03027)

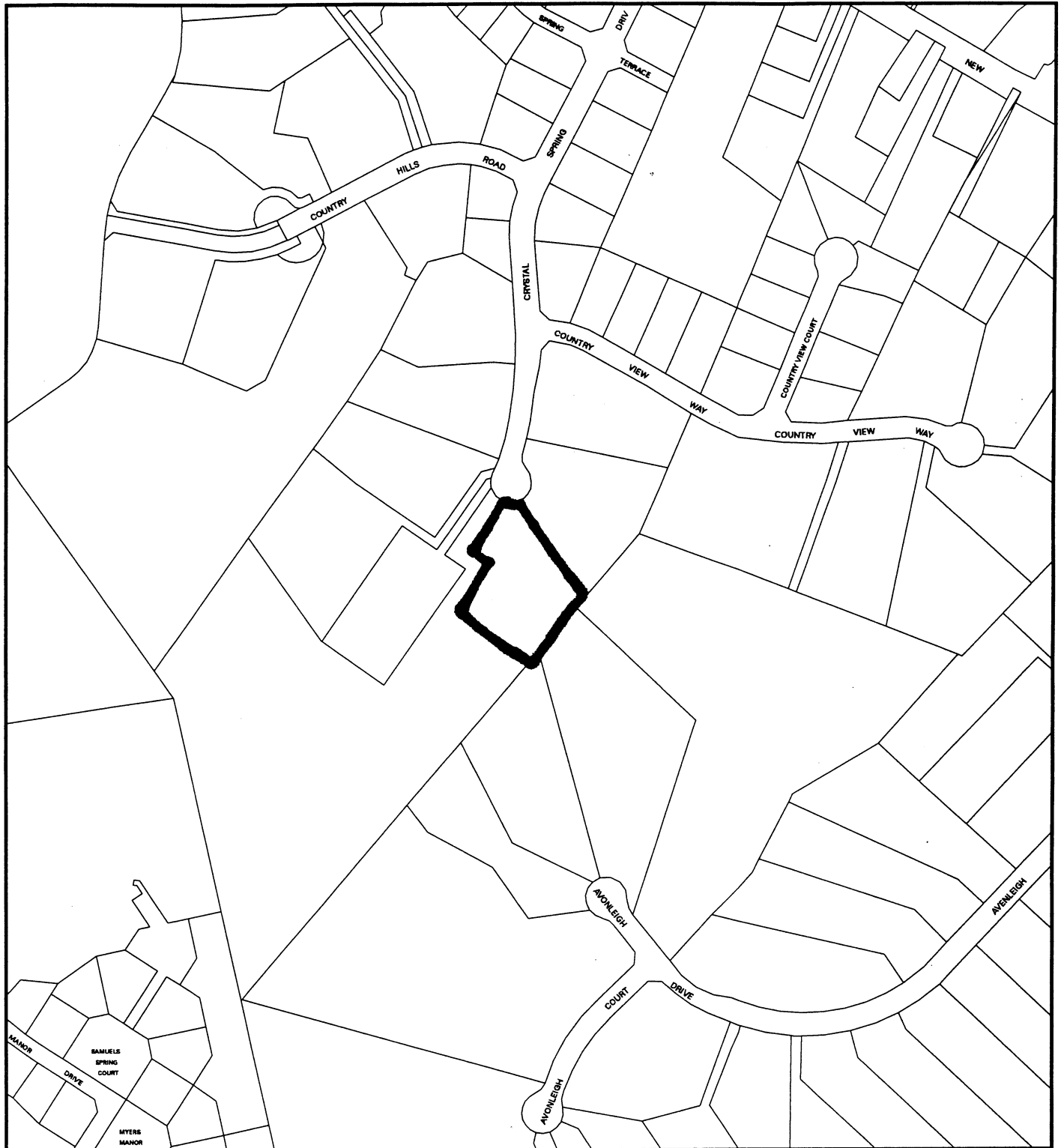

Map compiled on November 08, 2002 at 1:20 PM | Site located on base sheet no - 223NW01

NOTICE

The planimetric, property, and topographic information shown on this map is based on copyrighted Map Products from the Montgomery County Department of Park and Planning of the Maryland-National Capital Park and Planning Commission, and may not be copied or reproduced without written permission from M-NCPPC.

Property lines are compiled by adjusting the property lines to topography created from aerial photography and should not be interpreted as actual field surveys. Planimetric features were compiled from 1:14400 scale aerial photography using stereo photogrammetric methods.

This map is created from a variety of data sources, and may not reflect the most current conditions in any one location and may not be completely accurate or up to date. All map features are approximately within five feet of their true location. This map may not be the same as a map of the same area plotted at an earlier time as the data is continuously updated. Use of this map, other than for general planning purposes is not recommended. - Copyright 1998

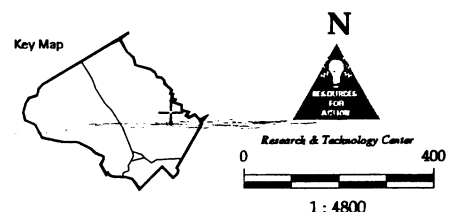

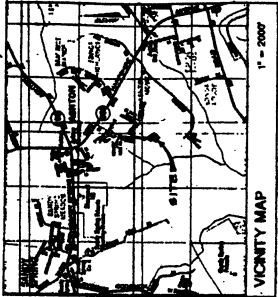

GENERAL NOTES:

- 1. Check This Area (PTP):
- 2. Existing Utility:
- 3. Proposed Utility:
- 4. Proposed Right-of-Way:
- 5. Proposed Easement:
- 6. Other Information:

2,000' AS SHOWN
 1" = 2000'
 1" = 2000'
 1" = 2000'

PROPOSED IMPROVEMENTS:

Item	Quantity	Unit	Notes
Asphalt Paving	17,720	SF	Asphalt Paving
Gravel Paving	68,300	SF	Gravel Paving
Concrete Paving	227	SF	Concrete Paving
Storm Sewer	425'	LF	Storm Sewer
Sanitary Sewer	17,720'	LF	Sanitary Sewer
Water Main	20'	LF	Water Main
Gas Main	20'	LF	Gas Main
Electricity	20'	LF	Electricity
Lighting	20'	LF	Lighting
Signage	20'	LF	Signage
Landscaping	20'	LF	Landscaping
Other	20'	LF	Other

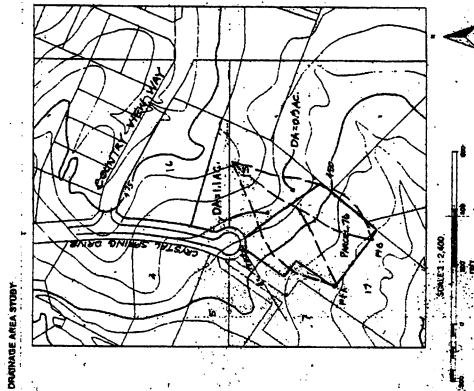

SCALE: 1" = 2000'

Curve ID	Length	Radius	Chord	Delta	Stationing
C1	23.9'	1187.0'	23.9'	90.0°	1+00.00 to 1+23.90



ENGINEER'S CERTIFICATE
 I hereby certify that the location and description information shown hereon is correct, based on the information provided hereon.
 Date: 3/29/07
 Thomas P. and Janice L. Veeh
 Professional Engineers
 License No. 12304

PREPARED FOR:
 Thomas P. and Janice L. Veeh
 222 N. WASHINGTON ST., SUITE 200
 ROCKVILLE, MD 20850
 TELEPHONE: 301-317-0178 FAX: 301-474-8844

NO.	REVISION	BY	DATE

PERRINE PLANNING & ZONING, INC.
 222 N. WASHINGTON ST., SUITE 200
 ROCKVILLE, MD 20850
 TELEPHONE: 301-317-0178 FAX: 301-474-8844

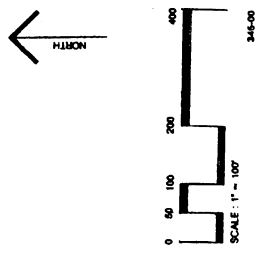

**VALOIS PROPERTY
 PRELIMINARY PLAN**
 Proposed Lot 20 Block D
 Spring Lawn Farm