

Project Site

VICINITY MAP

ATTACHMENT 1

Map Compiled On 06-12-2003 at 10:26 AM  
Map Scale: 1 inch = 25000 feet or 1:300000

0 25000 Feet



The Maryland-National Capital Park and Planning Commission  
Montgomery County Department of Park and Planning  
Transportation Planning Unit  
8787 Georgia Avenue | Silver Spring, Maryland 20910  
301.495.4525 voice | 301.495.1302 fax | <http://www.mc-mncppc.org>

Master Plan of Highways Centerline 2  
Master Plan of Highways Right-of-Way  
Municipalities  
Montgomery County

NOTICE  
The planimetric, property, and topographic information shown on this map is based on copyrighted Map Products from the Montgomery County Department of Park and Planning of the Maryland-National Capital Park and Planning Commission, and may not be copied or reproduced without written permission from M-NCPPC.

Property lines are compiled by adjusting the property lines to topography created from aerial photography and should not be interpreted as actual field surveys. Planimetric features were compiled from 1:14400 scale aerial photography using stereo photogrammetric methods. All planimetric and property-based features are collected at 1:2400 scale and are +/- 2.5 feet of their true location.

This map is created from a variety of data sources, and may not reflect the most current conditions in any one location and may not be completely accurate or up to date. This map may not be the same as a map of the same area plotted at an earlier time as the data are continuously updated. Use of this map, other than for general planning purposes, is not recommended. Copyright 2003.



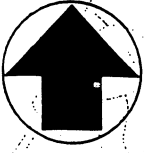

ROLLINS AVE

TWINBROOK PKWY

RANDOLPH RD

OLD GEROGETOWN RD

MARINELLI RD

OLD GEORGETOWN RD

RTE. 365

ROCKVILLE PIKE

STRATHMORE DR

TUCKERMAN LN

INTERSTATE 270

GROSVENOR LN

SECTION C

CAPITAL BELTWAY I-495

SECTION B

ALTA VISTA RD

SECTION A

WEST CEDAR LN

SECTION D

OLD GEORGETOWN RD

ROCKVILLE PIKE

NORTH BETHESDA TRAIL  
LOCATION MAP

**LEGEND**

- EXISTING TRAIL
- - - PROPOSED TRAIL

JOHNSON AVENUE

OAKMONT AVE

WEST CEDAR LANE

OLD GEORGETOWN ROAD

North

to I-495

to NIH

Staff recommends street trees be planted

Proposed trail

Poor alignment of trail and crosswalk needs to be corrected

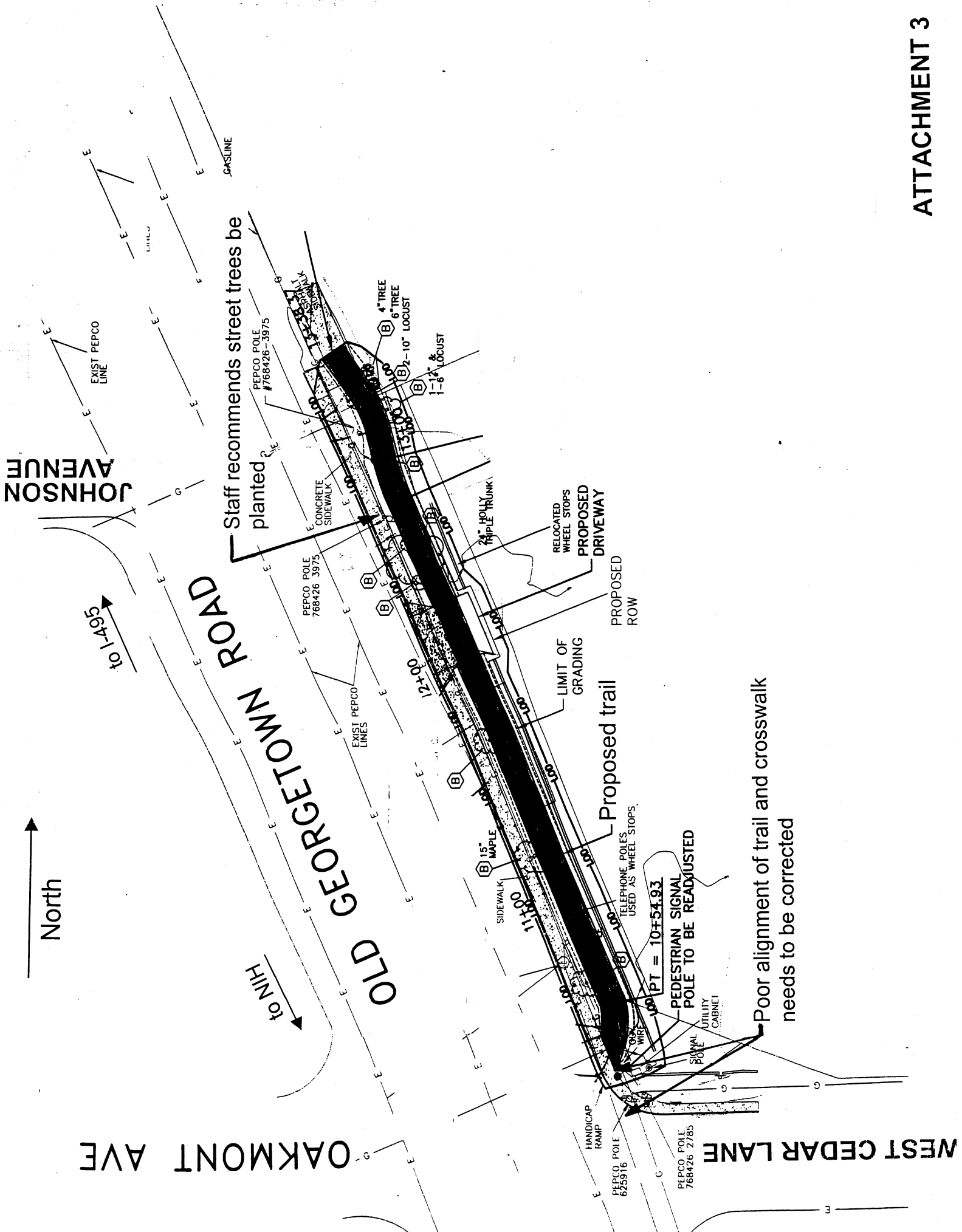

North

Proposed trail is too close to high-speed traffic

Proposed trail should be constructed away from curb, taking advantage of additional existing right-of-way

Existing and proposed trail segments should be better aligned across Charles Street

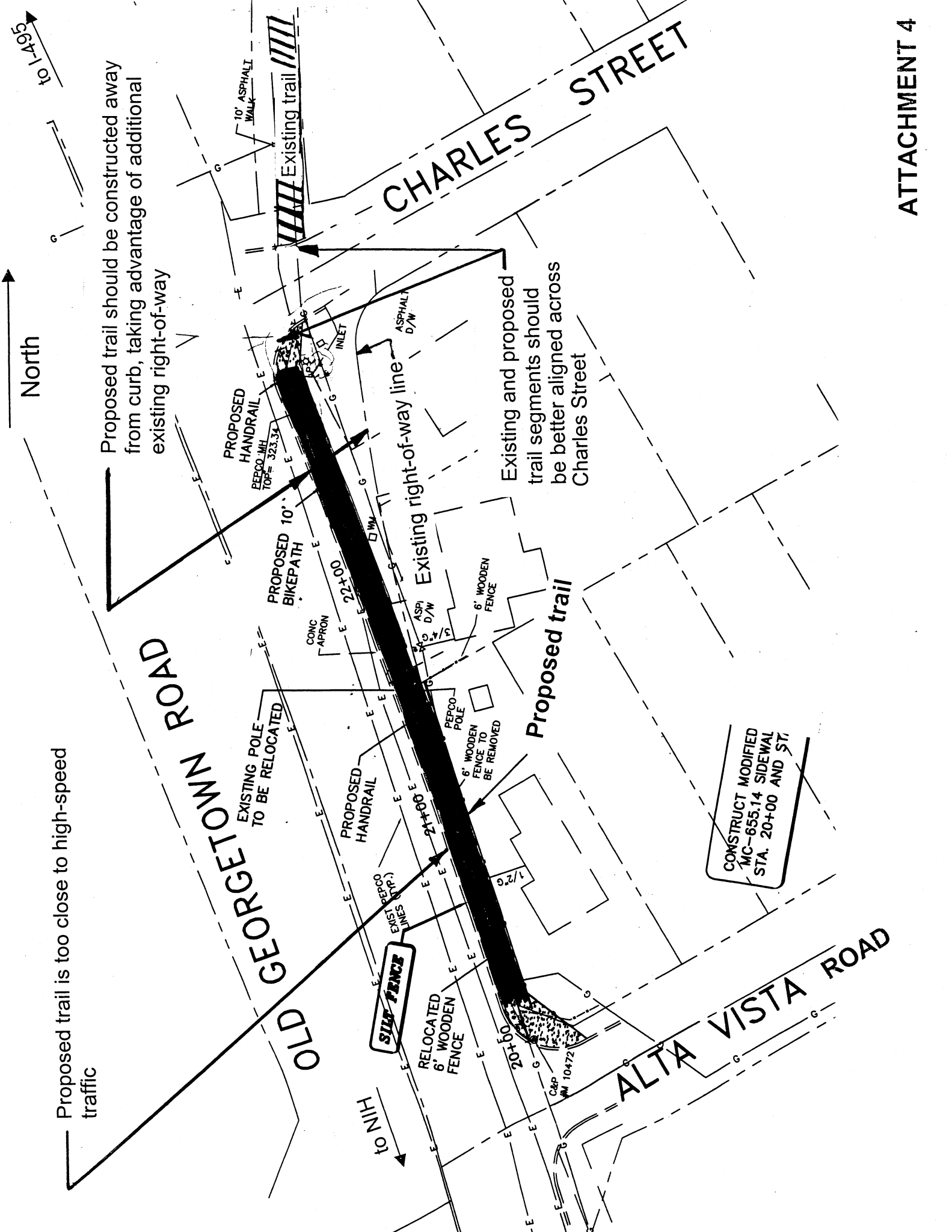

CONSTRUCT MODIFIED MC-655.14 SIDEWALK STA. 20+00 AND ST.

North

BEECH AVENUE

to NIH

to I-495

Handicap ramp should be rebuilt and widened to accommodate proposed trail

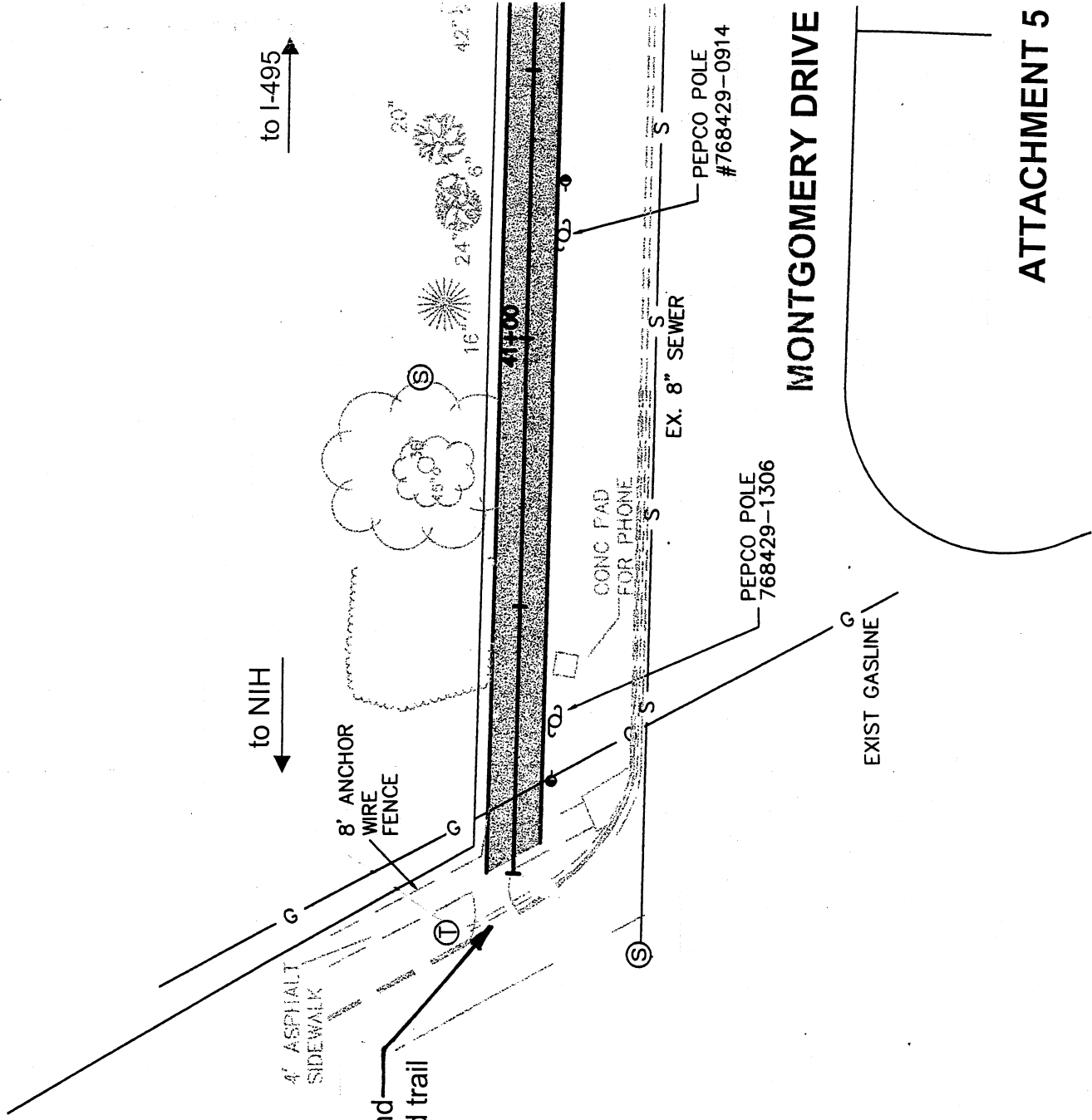

MONTGOMERY DRIVE

ATTACHMENT 5